

**General Notes**

Palestine Polytechnic University  
College Of Engineering  
Civil Department  
Surveying & Geomatics Engineering

**LEGAND**

- Property
- Road
- Contour line

No.	Revision/Issue	Date

**DESIGN BY:**  
Maha Khalaf  
Deema Nar  
Manar Abu Sharkh  
BY D. Musab Shahien

**Project Name and Address:**  
Redesigning and planning part of the lands of Wadi al-Joz and Ain Naqar, located between the city of Hebron and Dura.

Project	Sheet
Redesigning and planning	
Date	12 / 1 / 2025
Scale	1 : 500

156260.000      156280.000      156300.000      156320.000      156340.000      156360.000      156380.000      156400.000

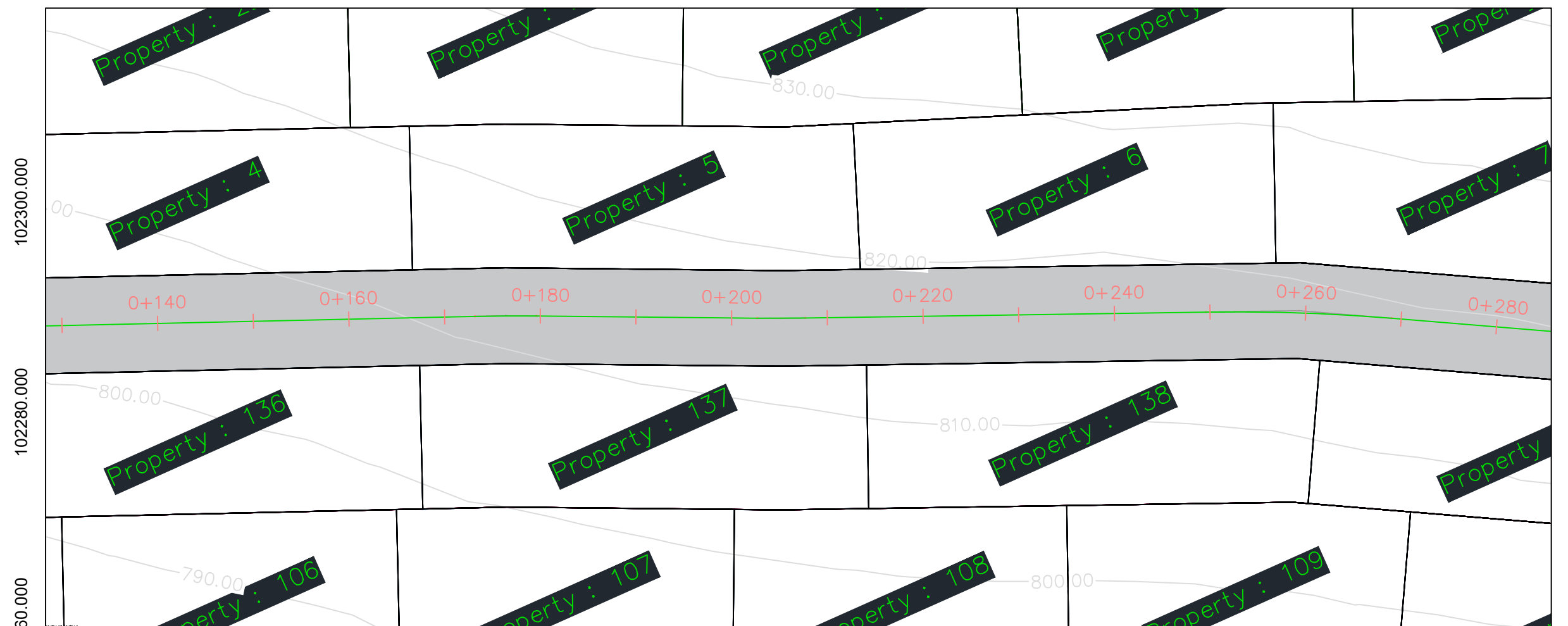

102260.000      102280.000      102300.000      102220.000      102240.000

General Notes  
 Palestine Polytechnic University  
 College Of Engineering  
 Civil Department  
 Surveying & Geomatics Engineering

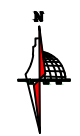

**LEGAND**

- Property
- Road
- Contour line

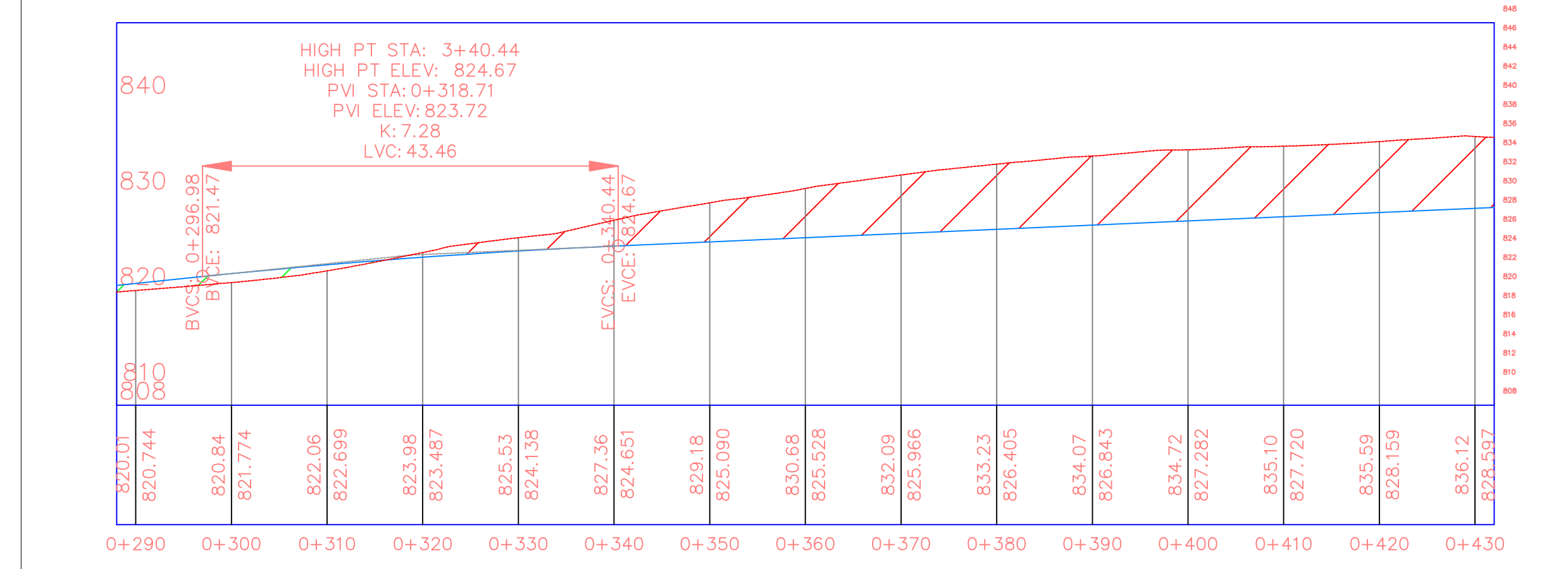

No.	Revision/Issue	Date

**DESIGN BY:**  
 Maha Khalaf  
 Deema Nar  
 Manar Abu Sharkh  
 BY D. Musab Shahien

**Project Name and Address**  
 Redesigning and planning part of the lands of Wadi al-Joz and Ain Naqur, located between the city of Hebron and Dara.

Project Redesigning and planning	Sheet
Date 12 / 1 / 2025	
Scale 1 : 500	

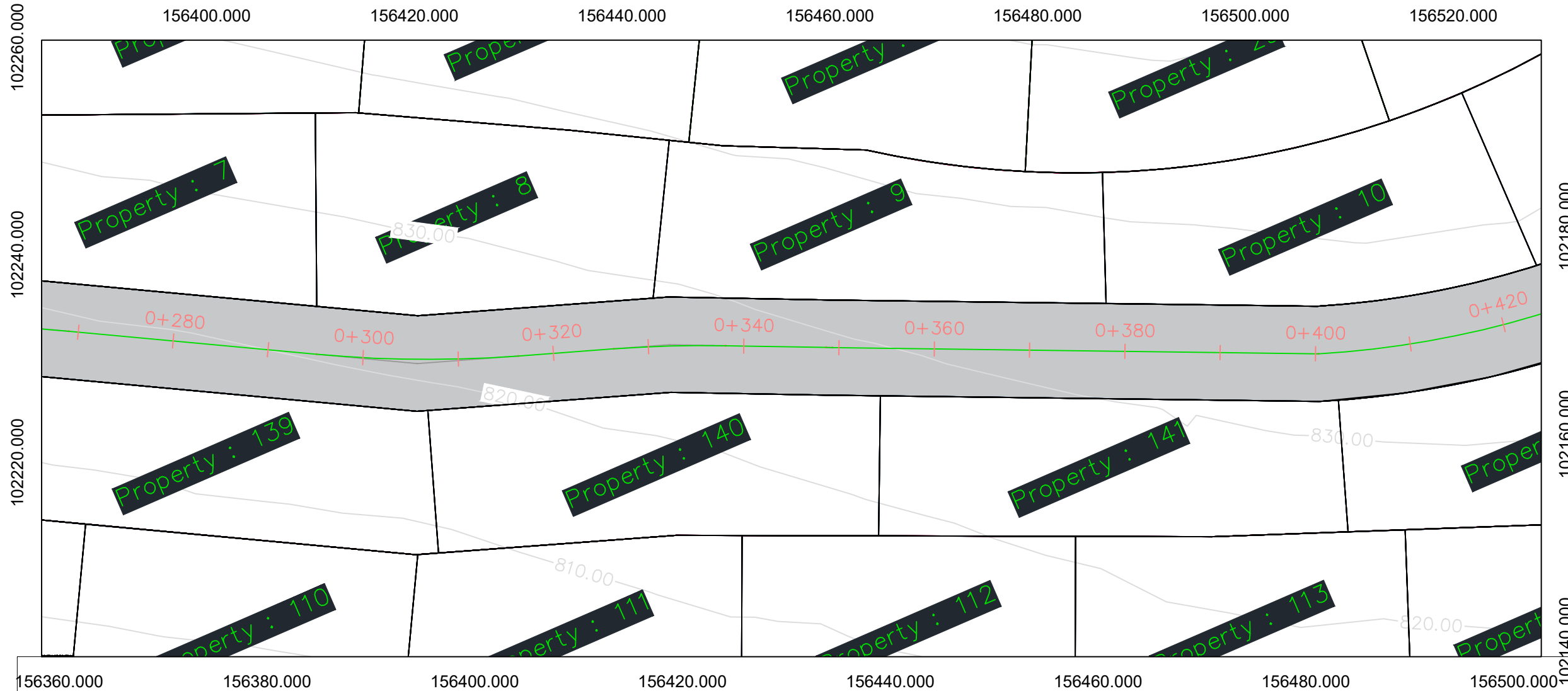

156360.000 156380.000 156400.000 156420.000 156440.000 156460.000 156480.000 156500.000

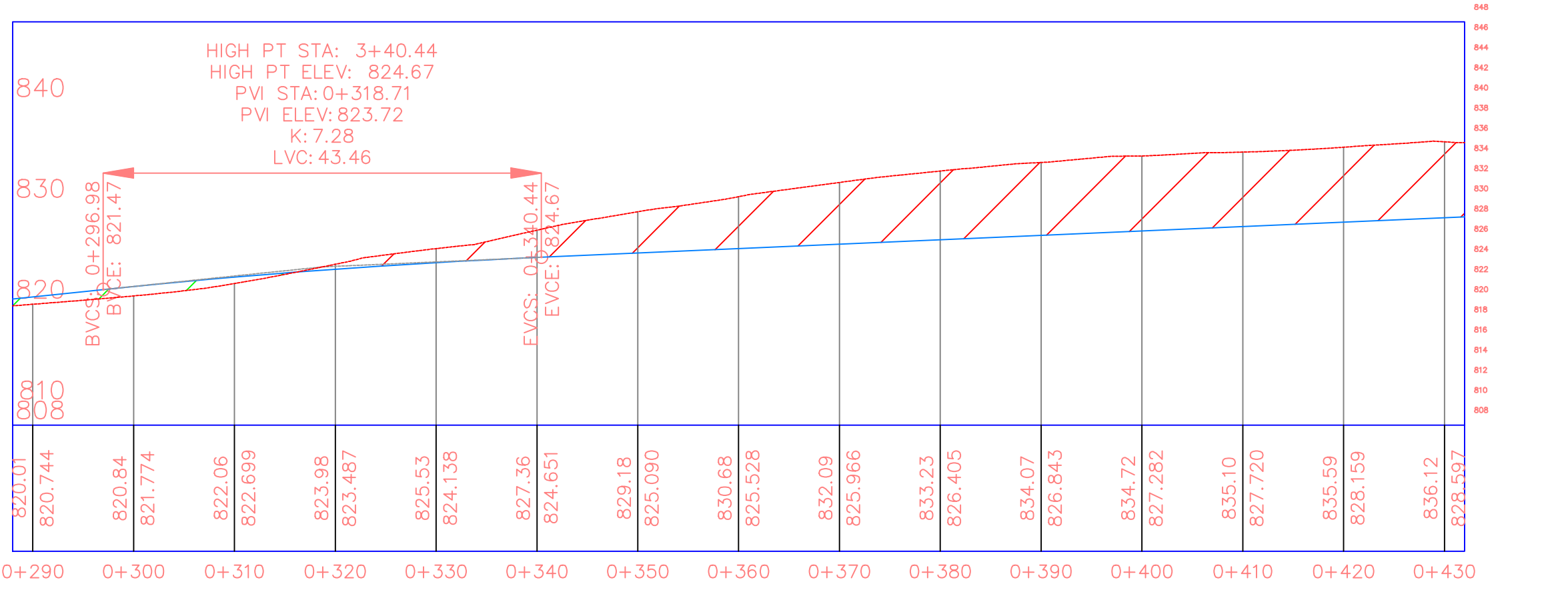

General Notes  
Palestine Polytechnic University  
College Of Engineering  
Civil Department  
Surveying & Geomatics Engineering

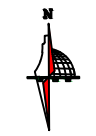

LEGEND

Property	
Road	
Contour line	

No.	Revisor/Issue	Date

DESIGN BY:  
Maha Khalaf  
Deema Nar  
Manar Abu Sharkh  
BY D. Musab Shahien

Project Name and Address  
Redesigning and planning part of the lands of Wadi al-Joz and Ain Naqar, located between the city of Hebron and Dura.

Project	Sheet
Redesigning and planning	
Date	12 / 1 / 2025
Scale	1 : 500

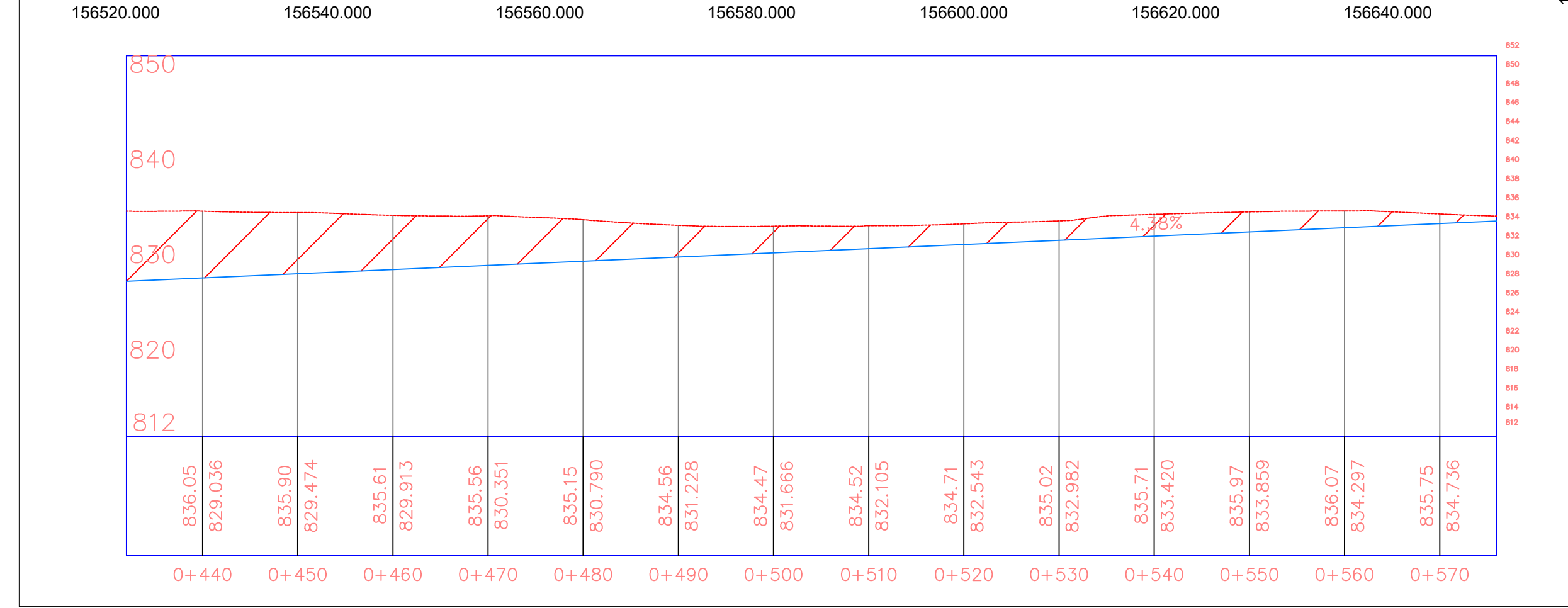
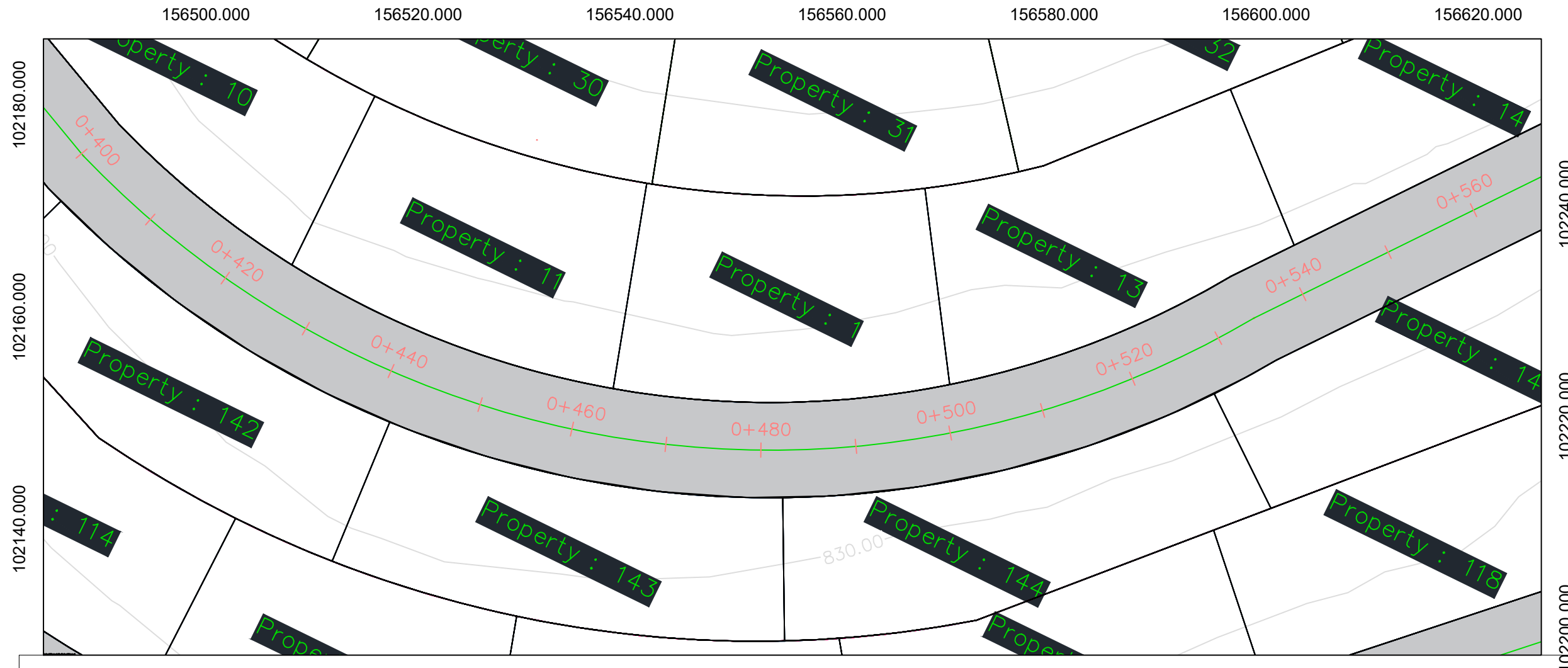

**General Notes**

Palestine Polytechnic University  
College Of Engineering  
Civil Department  
Surveying & Geomatics Engineering

**LEGAND**

- Property
- Road
- Contour line

No.	Revision/Issue	Date

**DESIGN BY:**  
Maha Khalaf  
Deema Nar  
Manor Abu Sharkh  
BY D. Musab Shahlen

**Project Name and Address**  
Redesigning and planning part of the lands of Wadi al-Joz and Ain Naqar, located between the city of Hebron and Dura.

**Project**  
Redesigning and planning

**Date**  
12 / 1 / 2025

**Scale**  
1 : 500

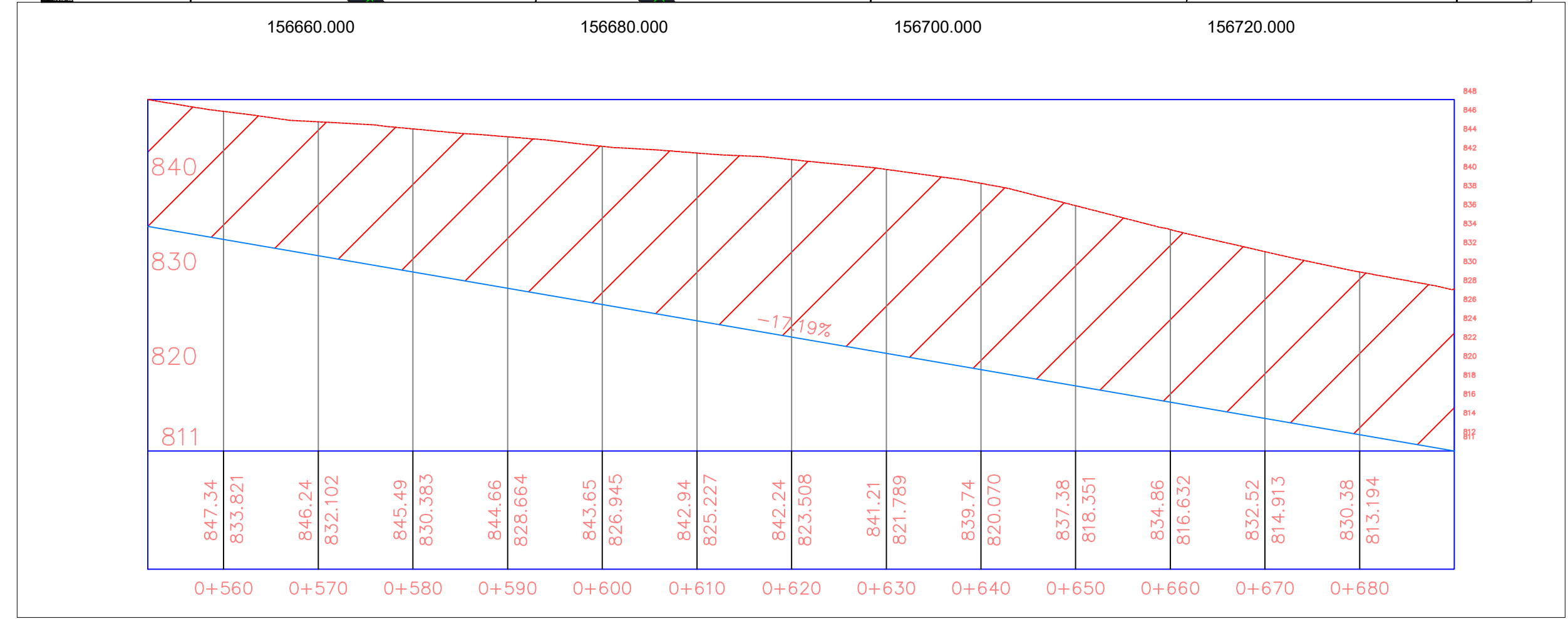
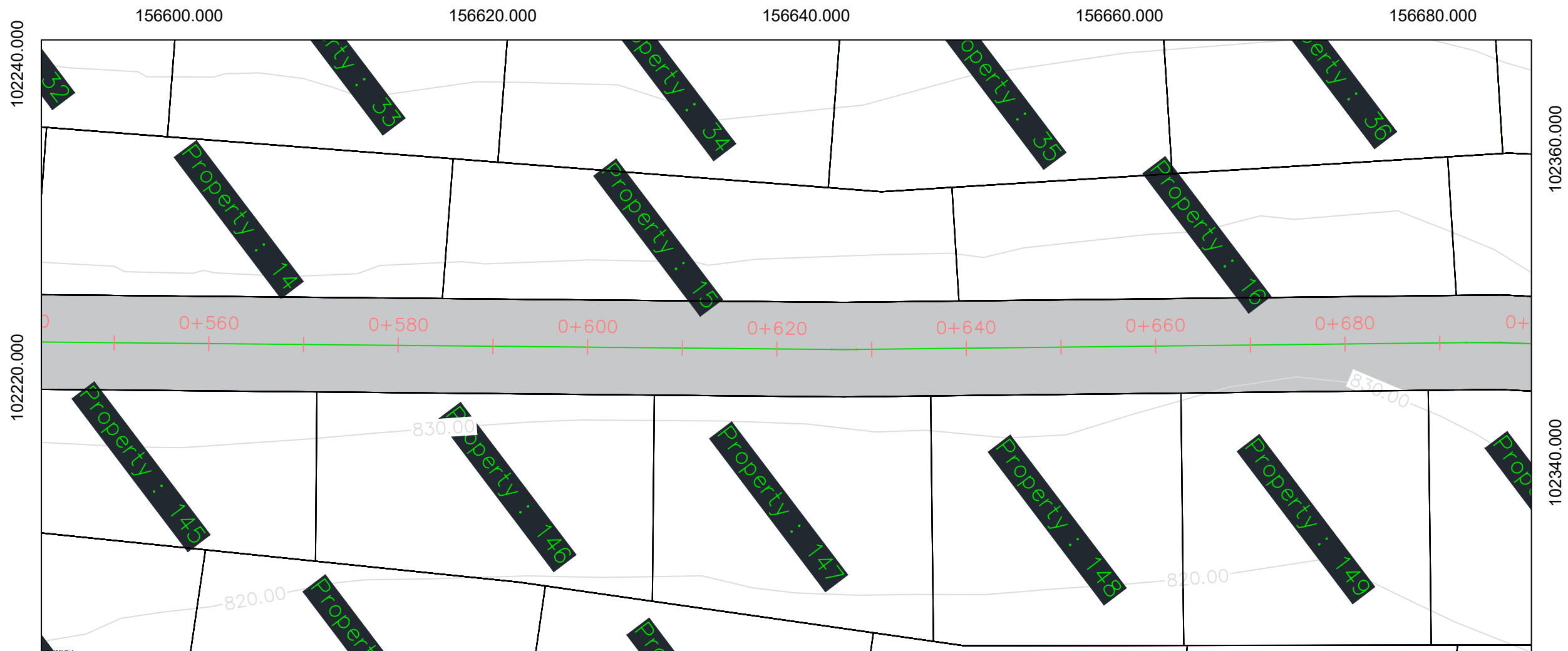

General Notes  
 Palestine Polytechnic University  
 College Of Engineering  
 Civil Department  
 Surveying & Geomatics Engineering



**LEGAND**

- Property
- Road
- Contour line

No.	Revision/Issue	Date

DESIGN BY:  
 Maha Khalaf  
 Deema Nar  
 Manar Abu Sharkh  
 BY D. Musab Shahien

Project Name and Address  
 Redesigning and planning part of the lands of Wadi al-Joz and Ain Naqur, located between the city of Hebron and Dura.

Project	Sheet
Redesigning and planning	
Date	12 / 1 / 2025
Scale	1 : 500

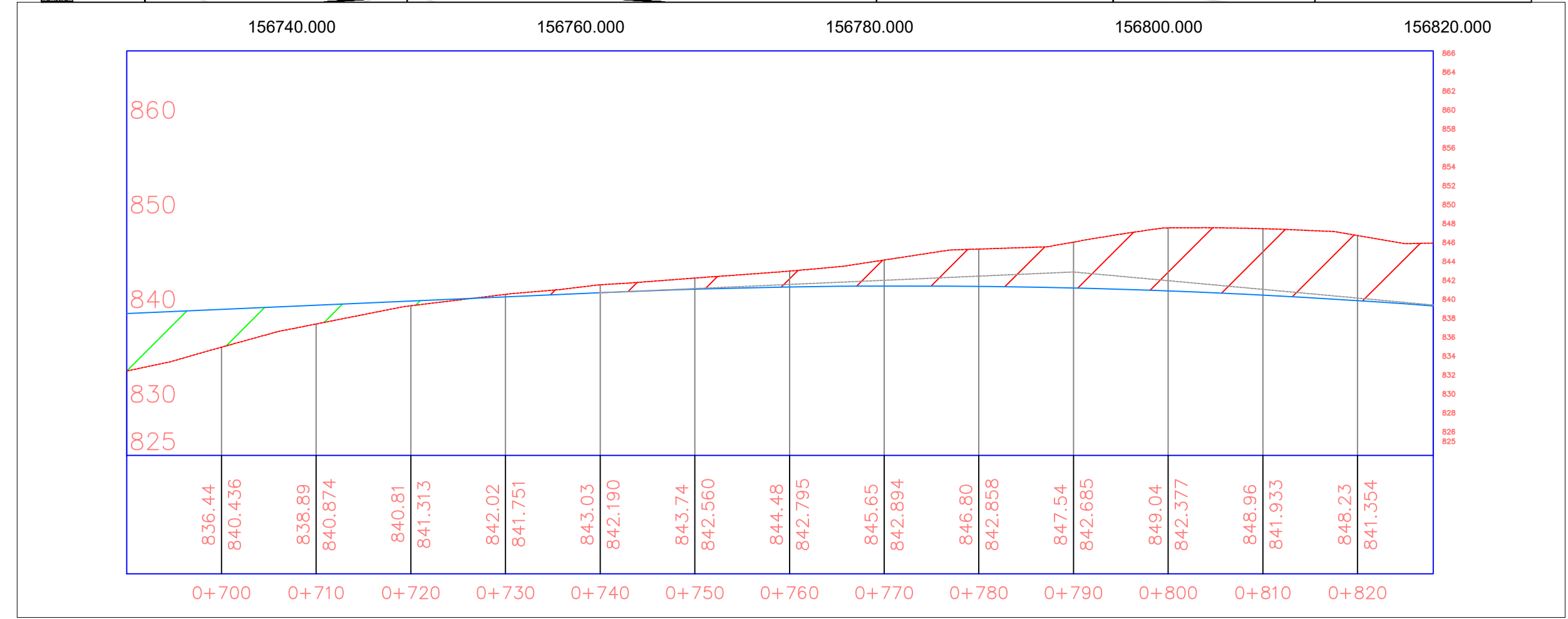
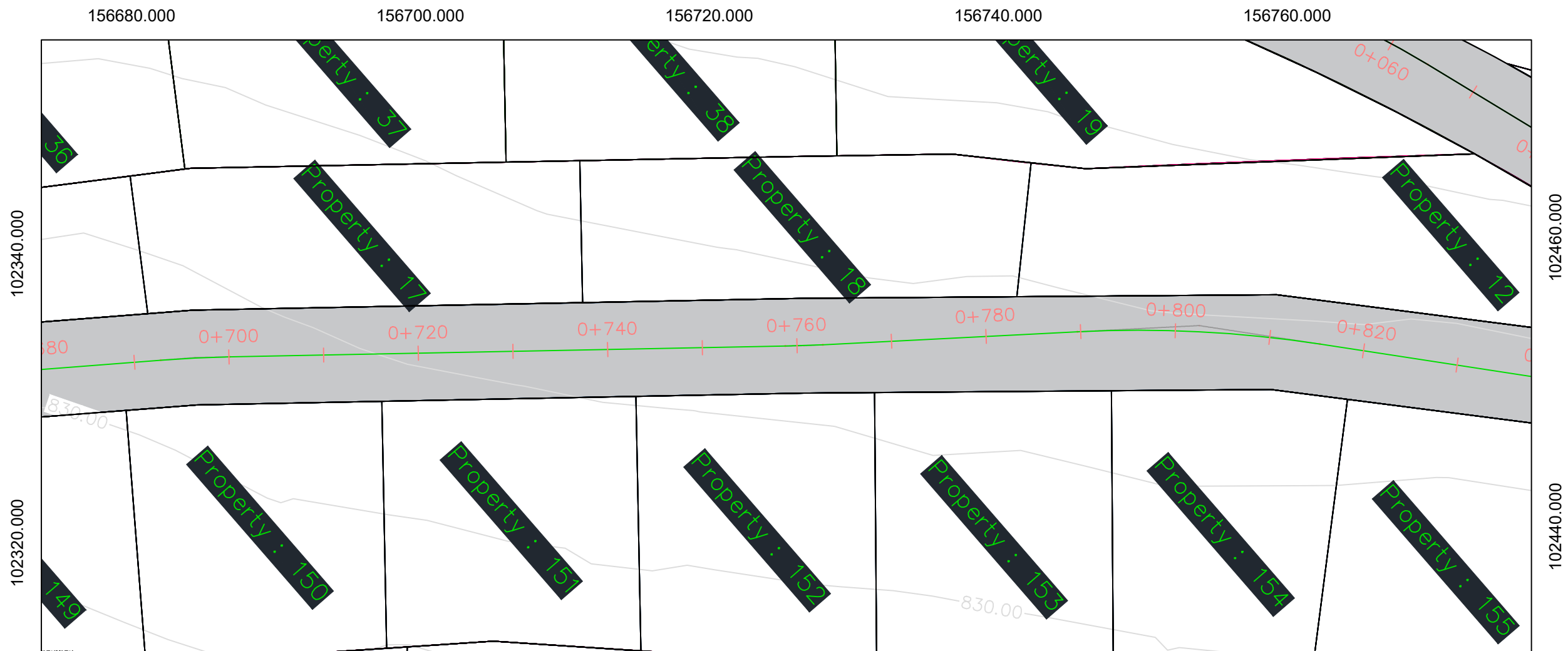

**General Notes**

Palestine Polytechnic University  
College Of Engineering  
Civil Department  
Surveying & Geomatics Engineering

**LEGAND**

- Property
- Road
- Contour line

No.	Revision/Issue	Date

**DESIGN BY:**  
Maha Khalaf  
Deema Nar  
Manar Abu Sharkh  
BY D. Musab Shahien

**Project Name and Address:**  
Redesigning and planning part of the lands of Wadi al-Joz and Ain Naqur, located between the city of Hebron and Dura.

Project	Sheet
Redesigning and planning	
Date	12 / 1/ 2025
Scale	1 : 500

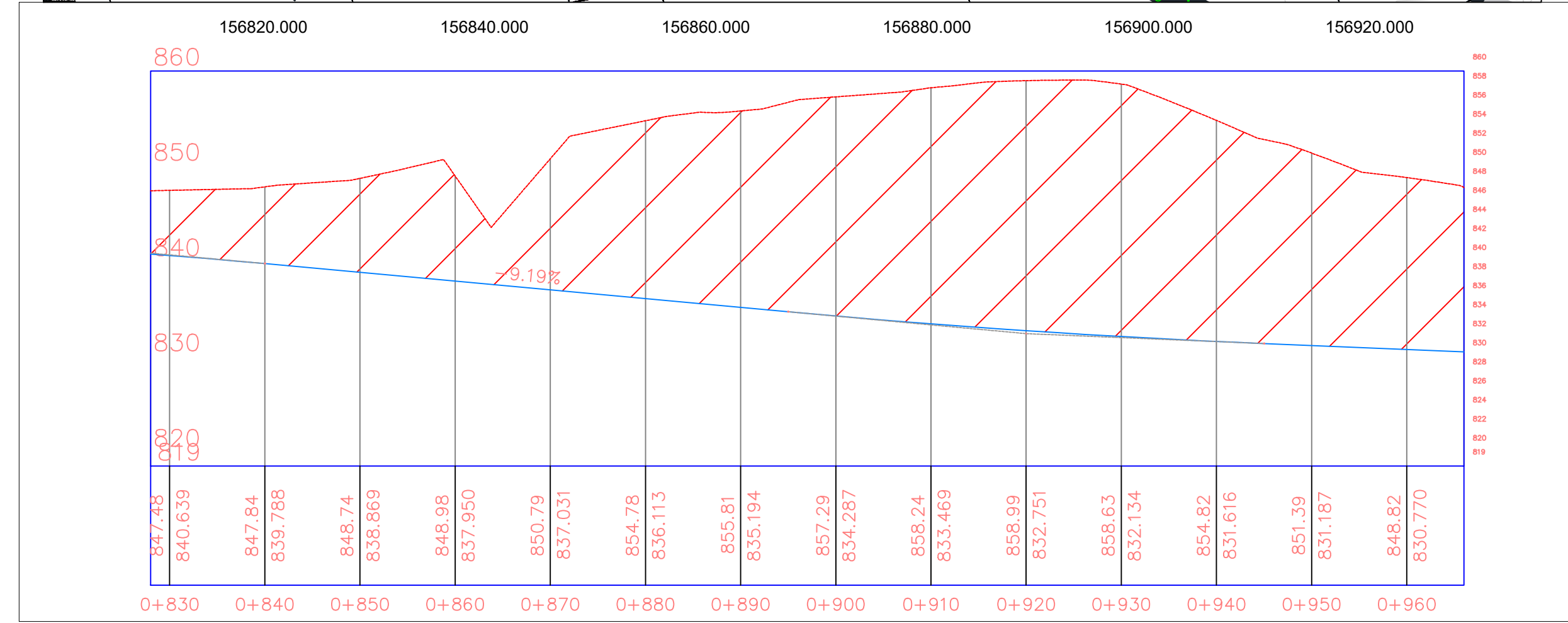
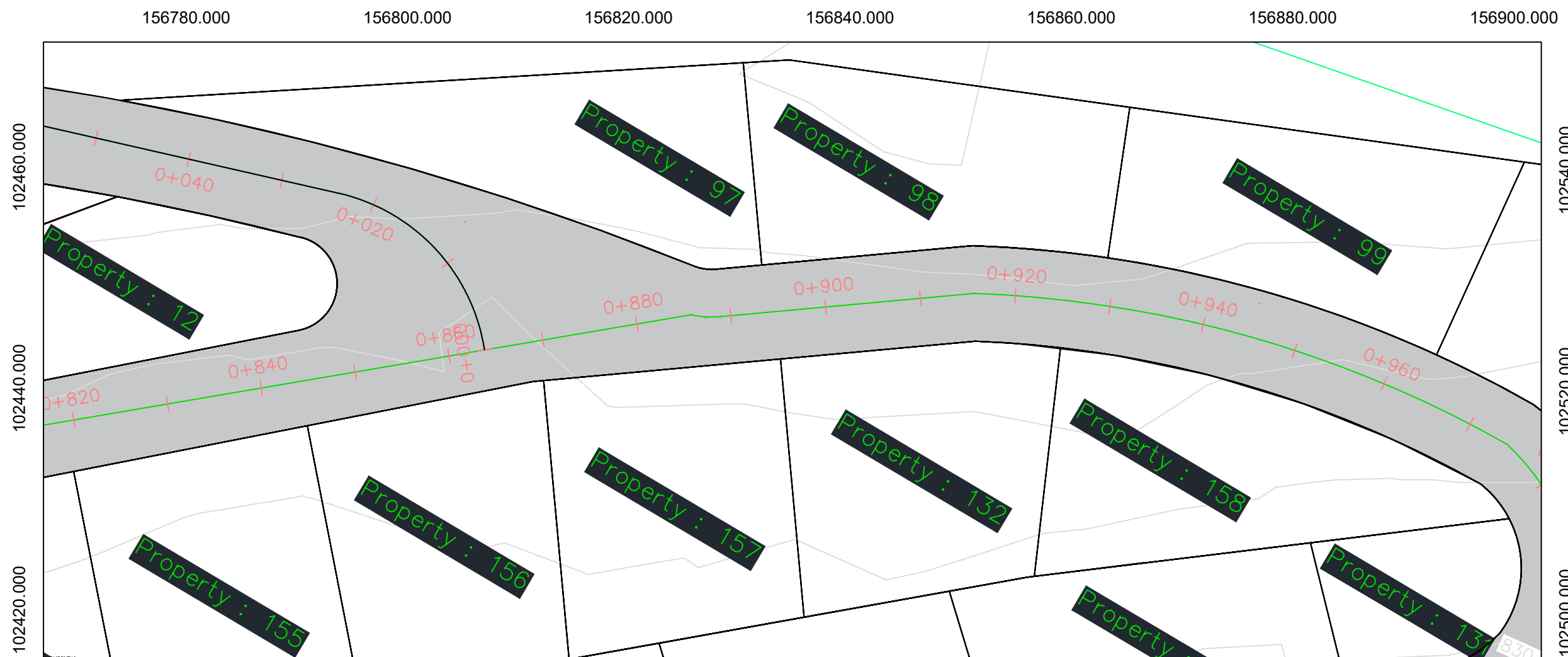

**General Notes**

Palestine Polytechnic University  
College Of Engineering  
Civil Department  
Surveying & Geomatics Engineering

**LEGAND**

- Property
- Road
- Contour line

No.	Revision/Issue	Date

**DESIGN BY:**  
Maha Khalaf  
Deema Nar  
Manar Abu Sharkh  
BY D. Musab Shahien

**Project Name and Address**  
Redesigning and planning part of the lands of Wadi al-Joz and Ain Naqar, located between the city of Hebron and Dura.

Project	Sheet
Redesigning and planning	
Date	12 / 1 / 2025
Scale	1 : 500

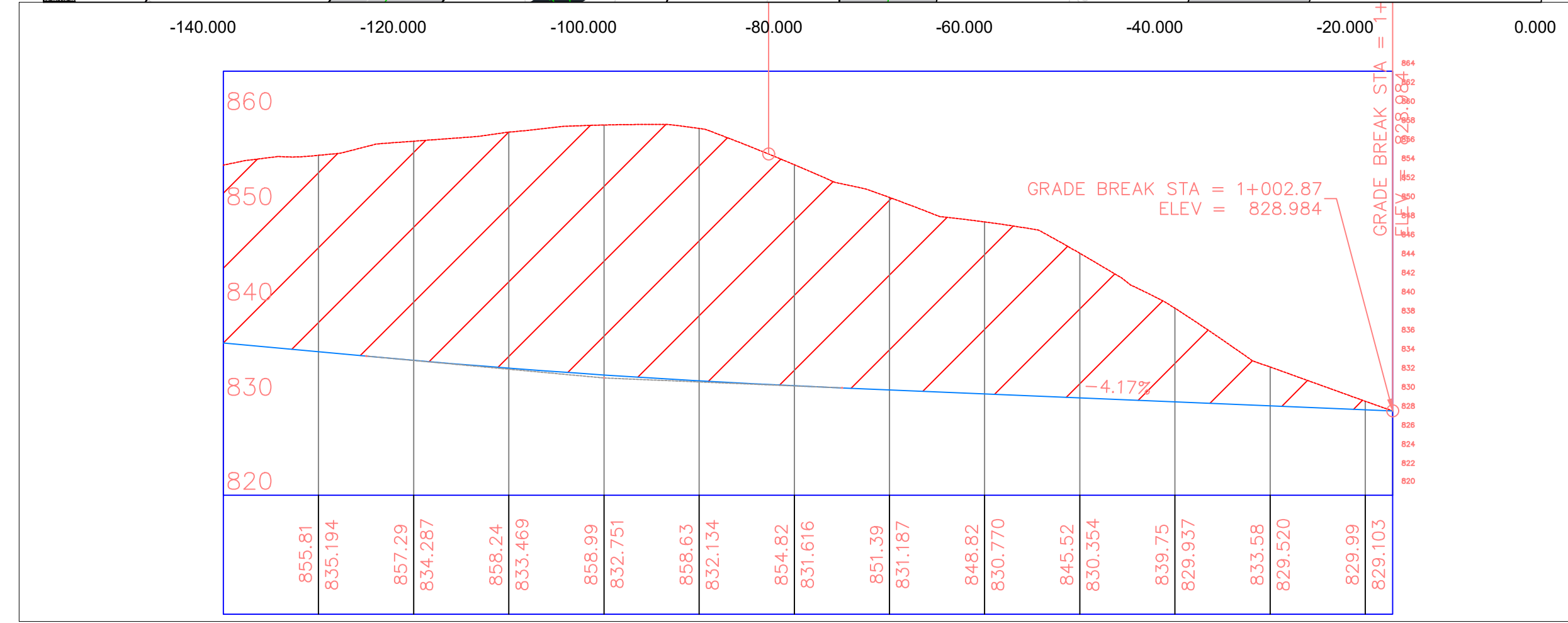
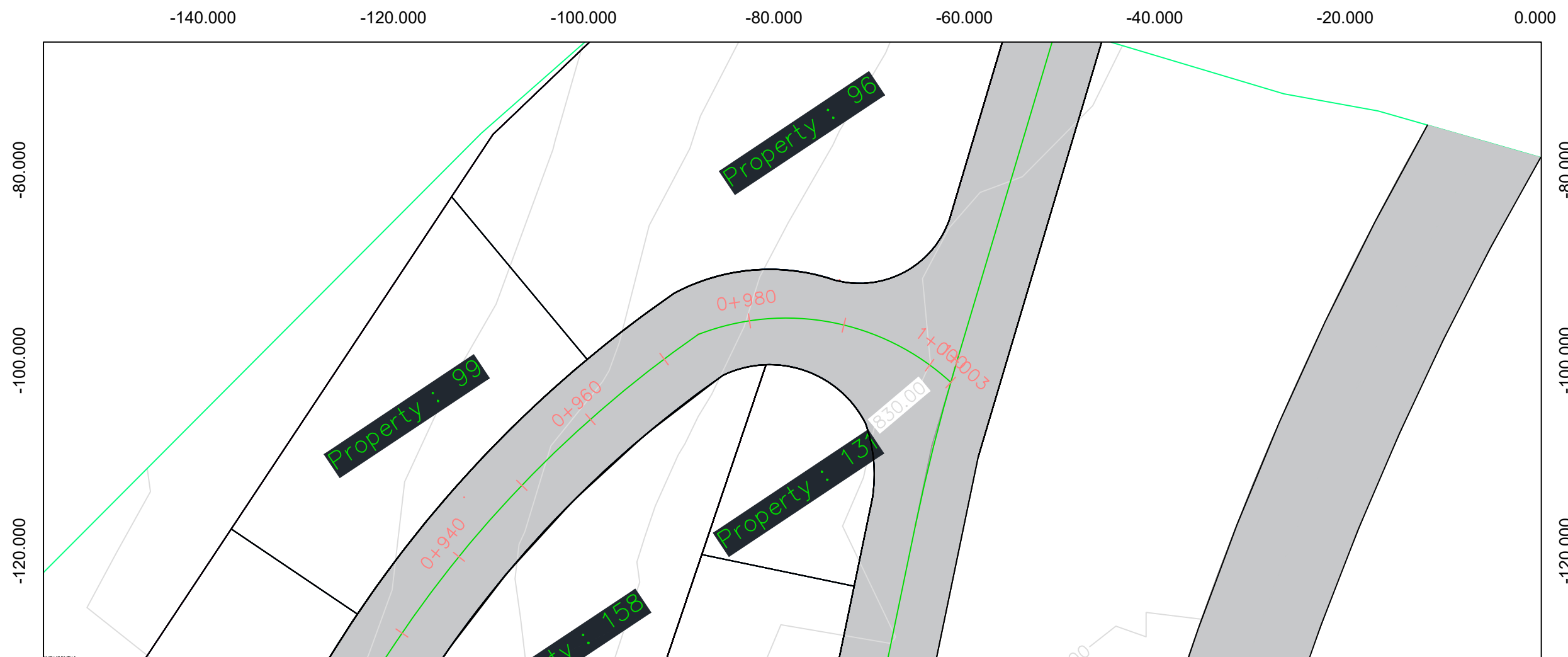

General Notes  
 Palestine Polytechnic University  
 College Of Engineering  
 Civil Department  
 Surveying & Geomatics Engineering



LEGAND

Property	
Road	
Contour line	

No.	Revision/Issue	Date

DESIGN BY:  
 Maha Khalaf  
 Deema Nar  
 Manar Abu Sharkh  
 BY D. Muab Shohien

Project Name and Address  
 Redesigning and planning part of the lands of Wadi al-Joz and Ain Naqar, located between the city of Hebron and Dura.

Project Redesigning and planning	Sheet
Date 12 / 1 / 2025	
Scale 1 : 500	