





General Notes

Palestine Polytechnic University
College Of Engineering
Civil Department
Surveying & Geomatics Engineering

LEGEND

- Property 
- Road 
- Contour line 

No.	Revision/Issue	Date

DESIGN BY:
Maha Khalilaf
Deema Nar
Manar Abu Sharkh
BY D. Musab Shahien

Project Name and Address
Redesigning and planning part of the lands of Wadi al-Joz and Ain Naqar, located between the city of Hebron and Dura.

Project	Sheet
Redesigning and planning	
Date	12 / 1 / 2025
Scale	1 : 500

156900.000 156880.000 156860.000 156840.000 156820.000 156800.000

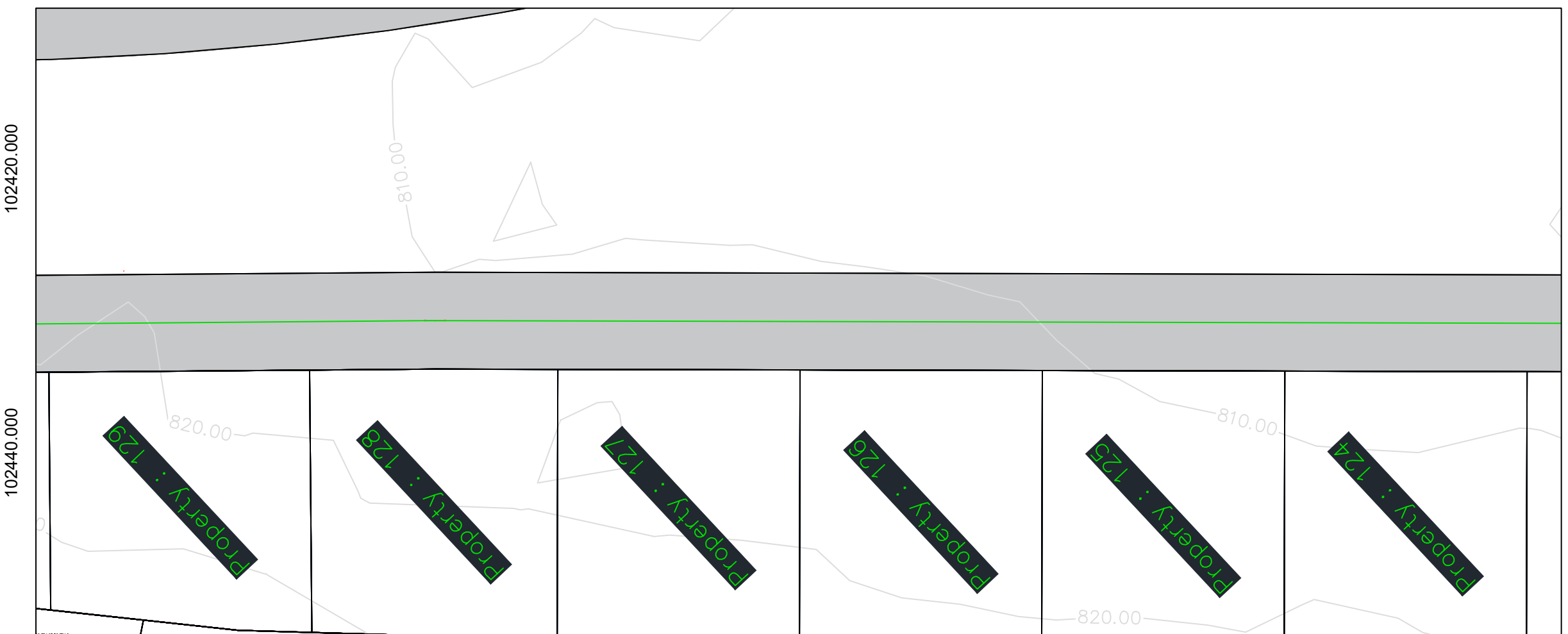

156840.000 156820.000 156800.000 156780.000 156760.000

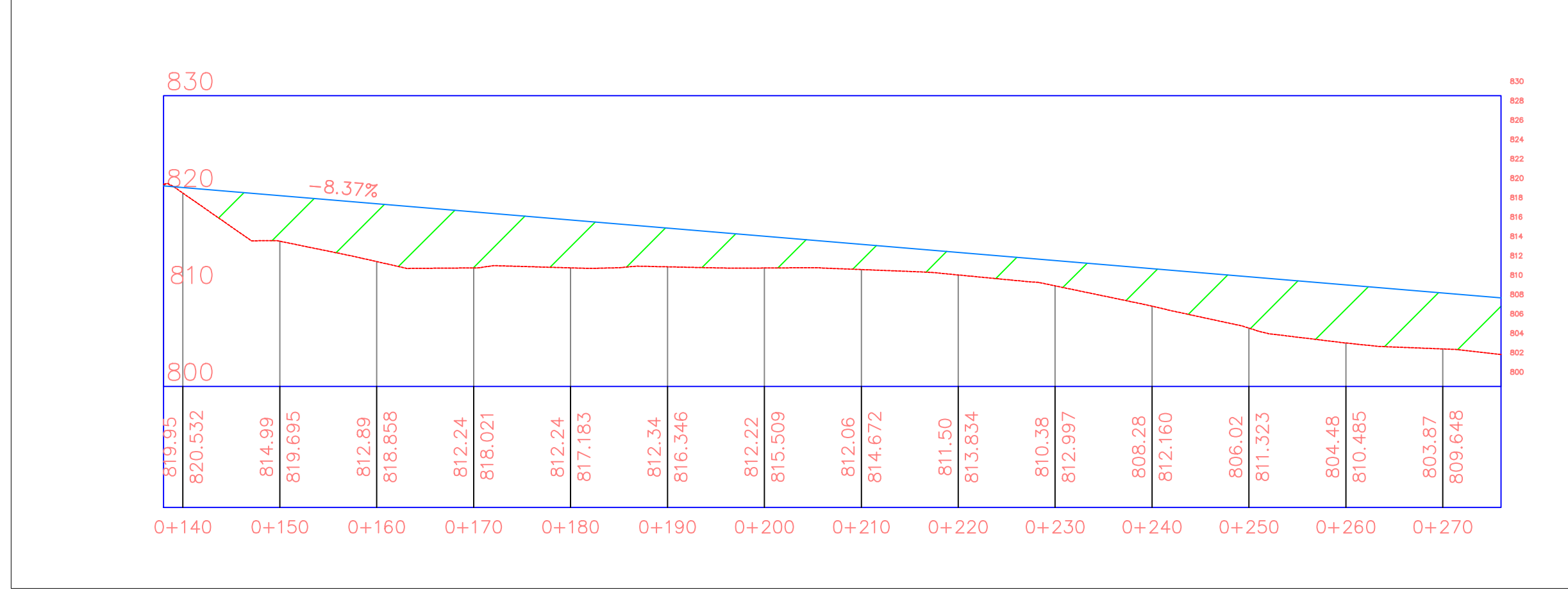

General Note
Palestine Polytechnic University
College Of Engineering
Civil Department
Surveying & Geomatics Engineering

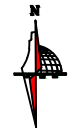

LEGAND

- Property
- Road
- Contour line

No.	Revision/Issue	Date

DESIGN BY:
Maha Khalaf
Deema Nar
Manor Abu Sharkh
BY D. Musab Shahien

Project Name and Address
Redesigning and planning part of the lands of Wadi al-Joz and Ain Nasar, located between the city of Hebron and Dura.

Project Redesigning and planning	Sheet
Date 12 / 1 / 2025	
Scale 1 : 500	

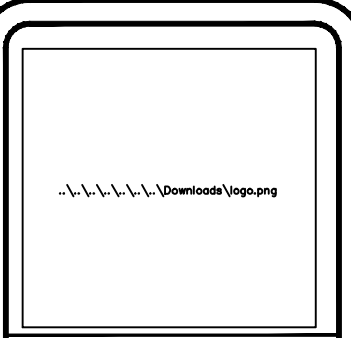
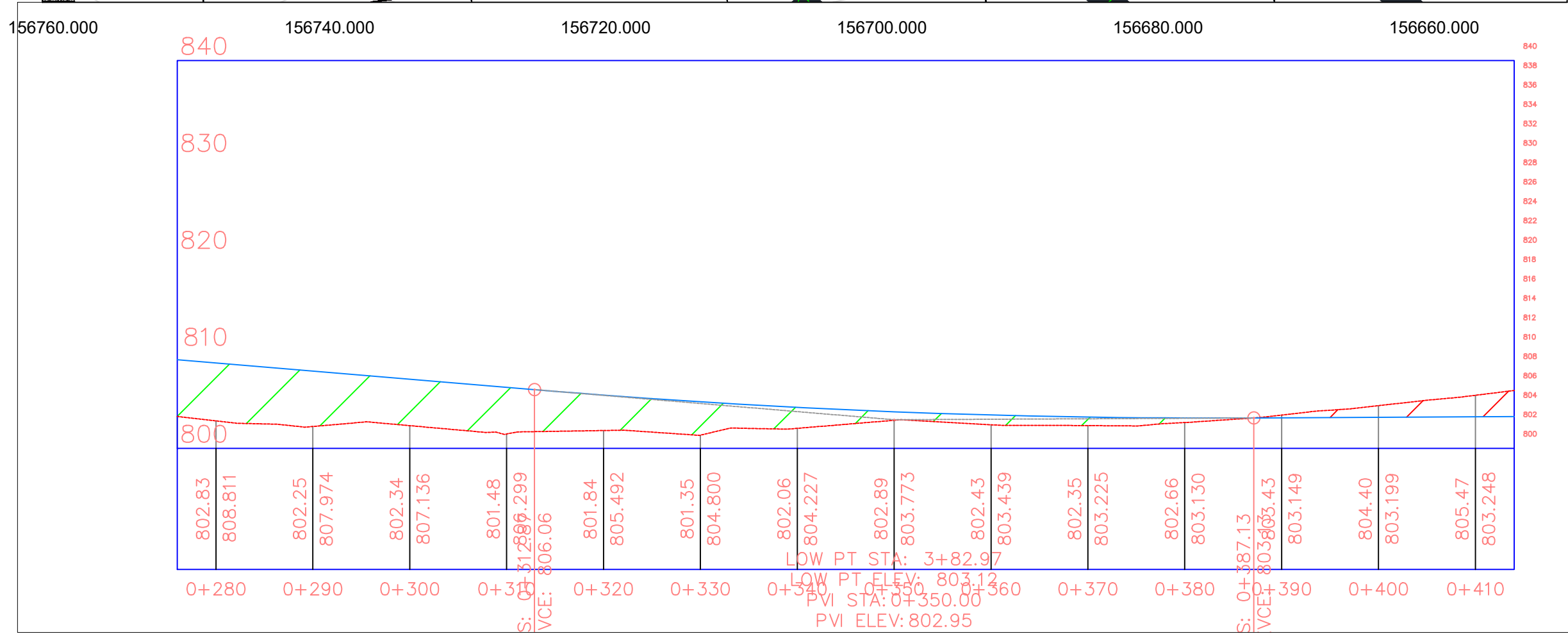
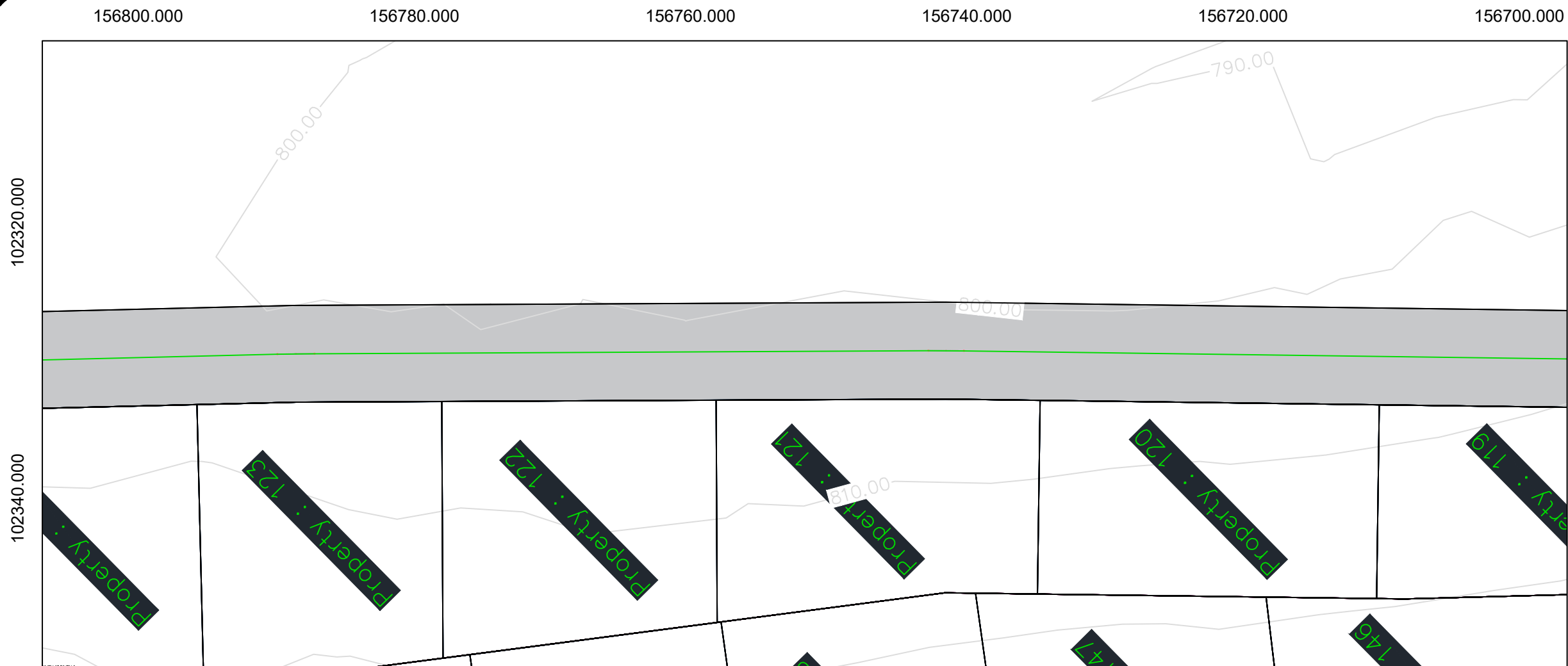

Palestinian Polytechnic University
 College of Engineering and Technology
 Civil & Architecture Department

Design of Wadi Aziz Street

- GENERAL NOTES:
1. ALL STATIONS, COORDINATES AND LEVELS ARE IN METERS.
 2. COORDINATES AND ELEVATIONS REFER TO THE PALESTINIAN GRID SYSTEM.
 3. DESIGN SPEED 60Km/h

Legend

- STONE WALL
- CONCREAT WALL
- Proposed Centerline
- Design Profile

Asphalt, Building, Water Well, Monhel, vehicle

Signs

DRAWING TITLE :
 Design of Wadi Aziz Street

Supervisor : BY D. MOTAZ QAFISHA

Desined by :
 MAHMOUD HASHLAMOUN
 SHAHD IMAR

SCALE	NO.OP	DATE
V : 1/50 H : 1/200	DRAW	24/1/2024
		3

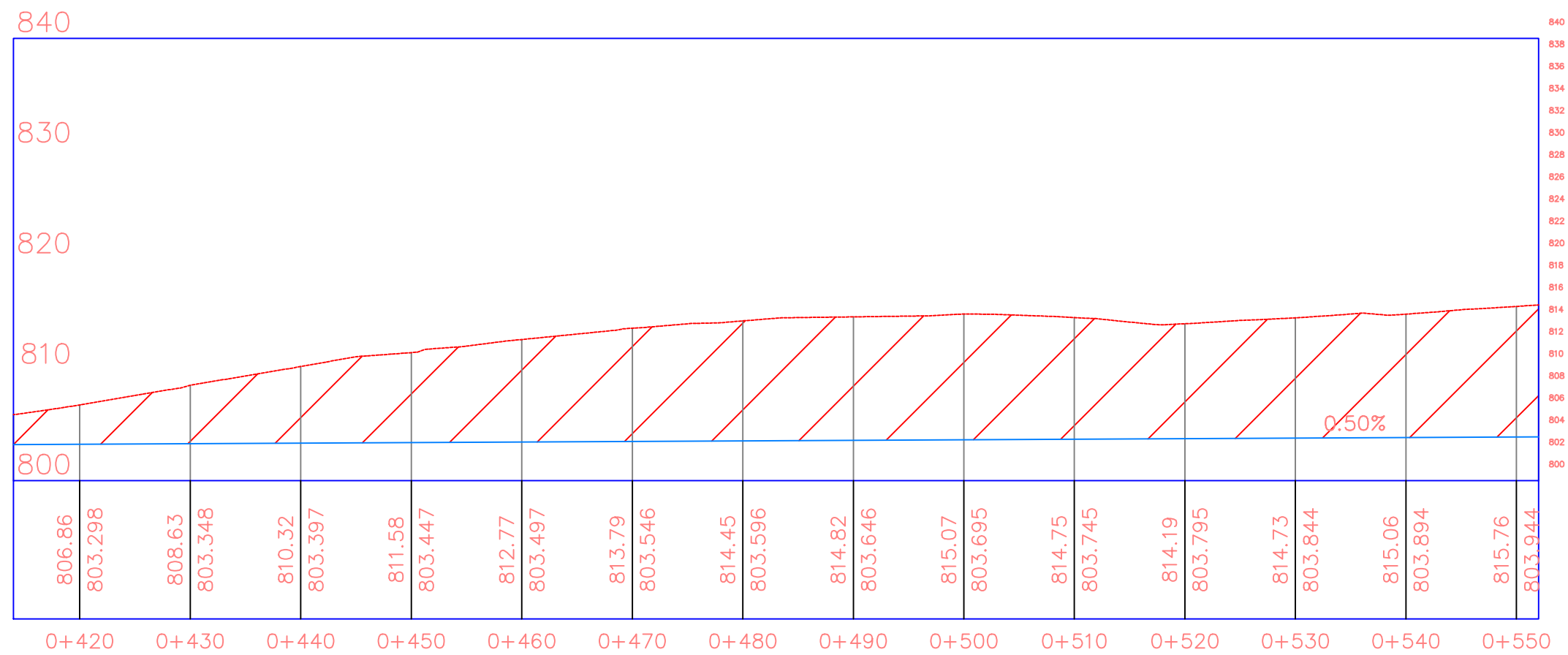
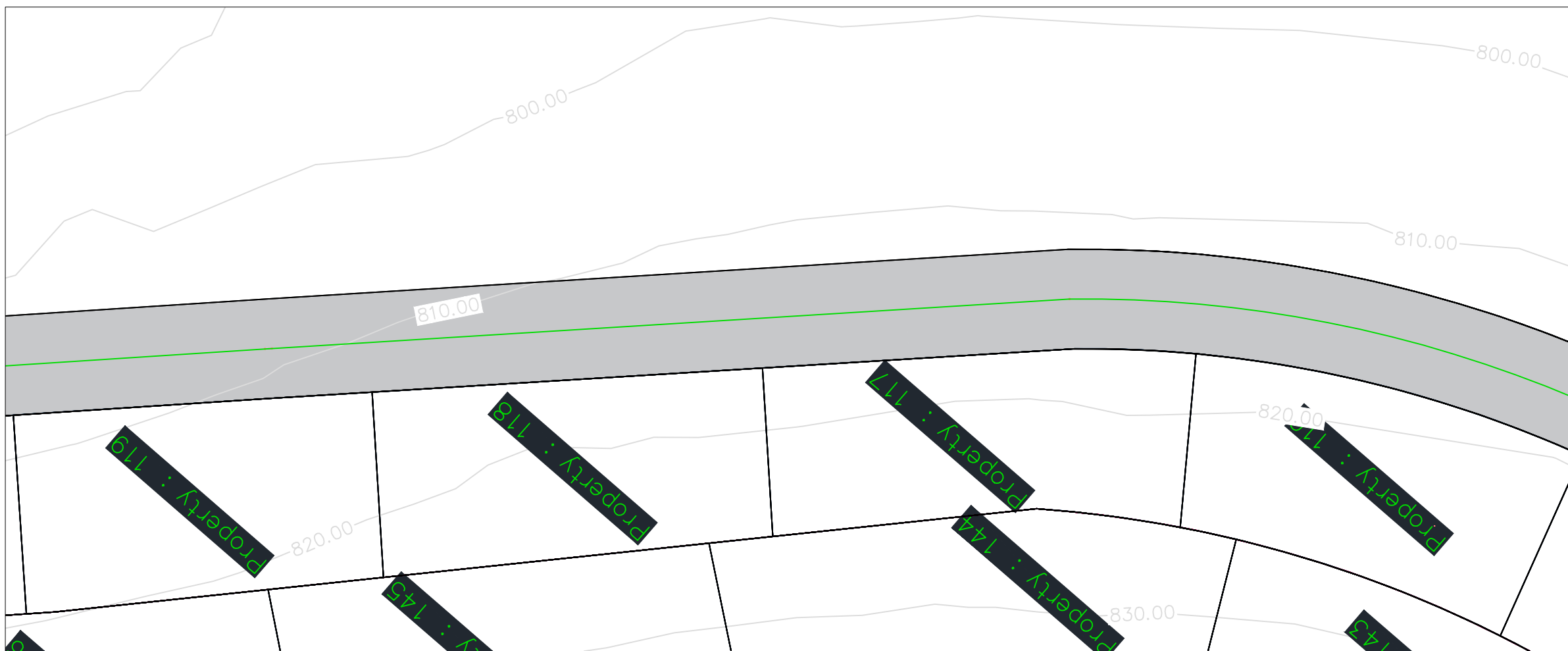

General Notes
 Palestine Polytechnic University
 College Of Engineering
 Civil Department
 Surveying & Geomatics Engineering



LEGAND

- Property
- Road
- Contour line

No.	Revision/Issue	Date

DESIGN BY:
 Maha Khalaf
 Deema Nar
 Manar Abu Sharkh
 BY D. Musab Shahien

Project Name and Address
 Redesigning and planning part of the lands of Wadi al-Joz and Ain Naqar, located between the city of Hebron and Dura.

Project	Sheet
Surveying and planning	
Date 12 / 1 / 2025	
Scale 1 : 500	

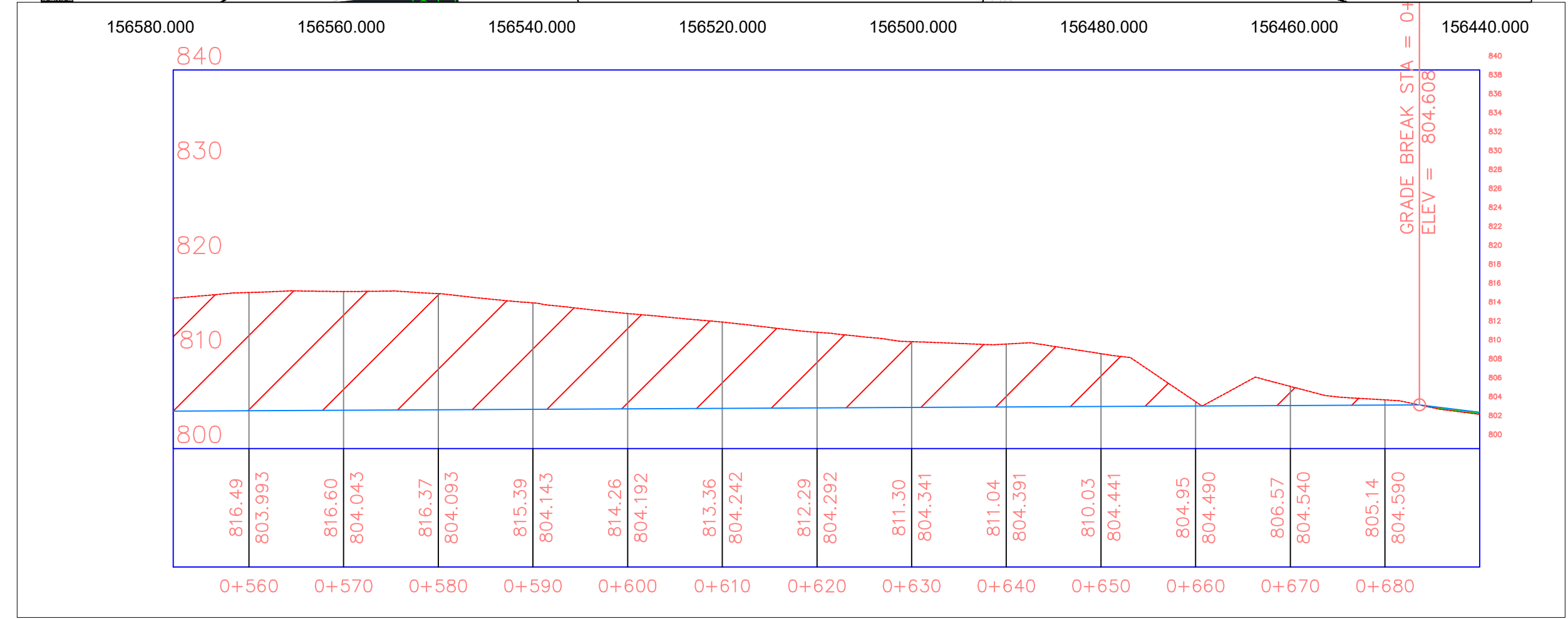
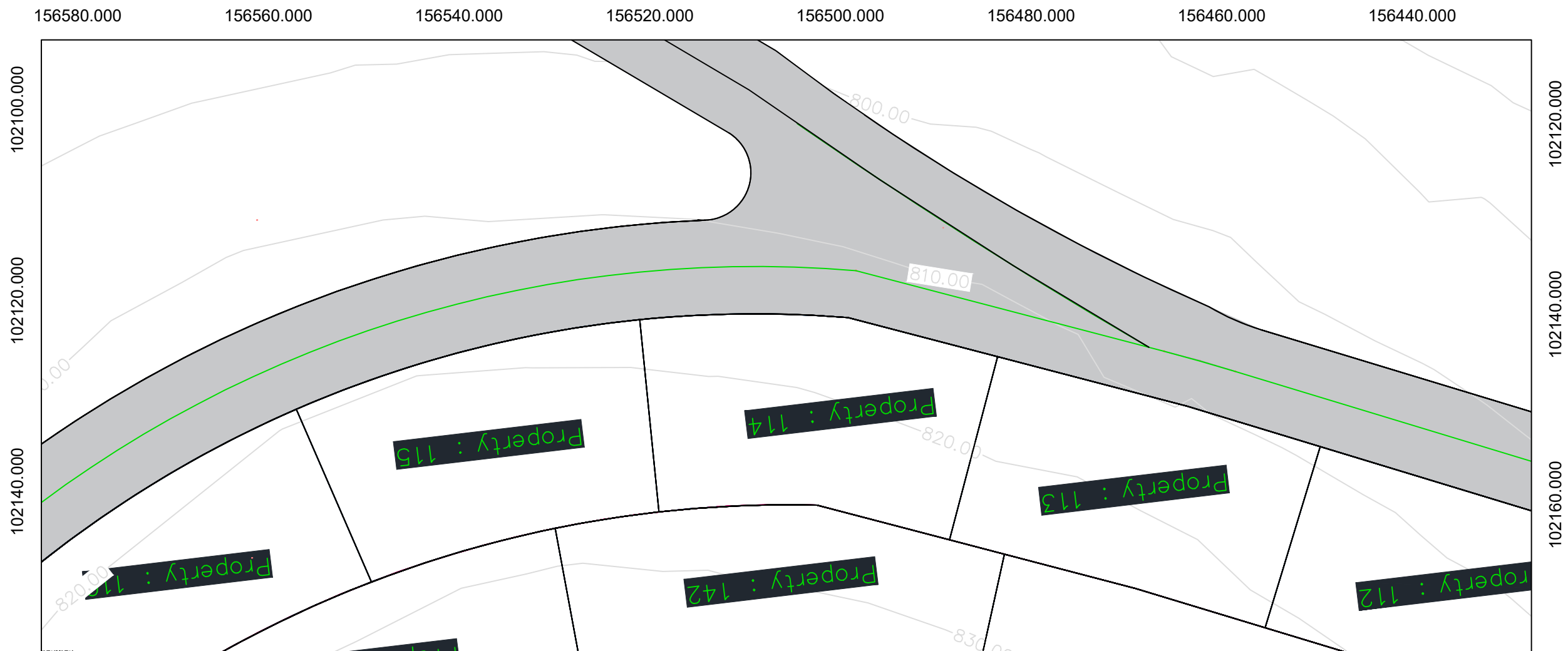

General Notes

Palestine Polytechnic University
College Of Engineering
Civil Department
Surveying & Geomatics Engineering

N

LEGAND

- Property
- Road
- Contour line

No.	Revisor/Issue	Date

DESIGN BY:
Maha Khalaf
Daema Nar
Manar Abu Sharkh
BY D. Musab Shahien

Project Name and Address
Redesigning and planning part of the lands of Wadi al-Joz and Ain Najar, located between the city of Hebron and Dura.

Project: Redesigning and planning Sheet:
Date: 12 / 1/ 2025
Scale: 1 : 500

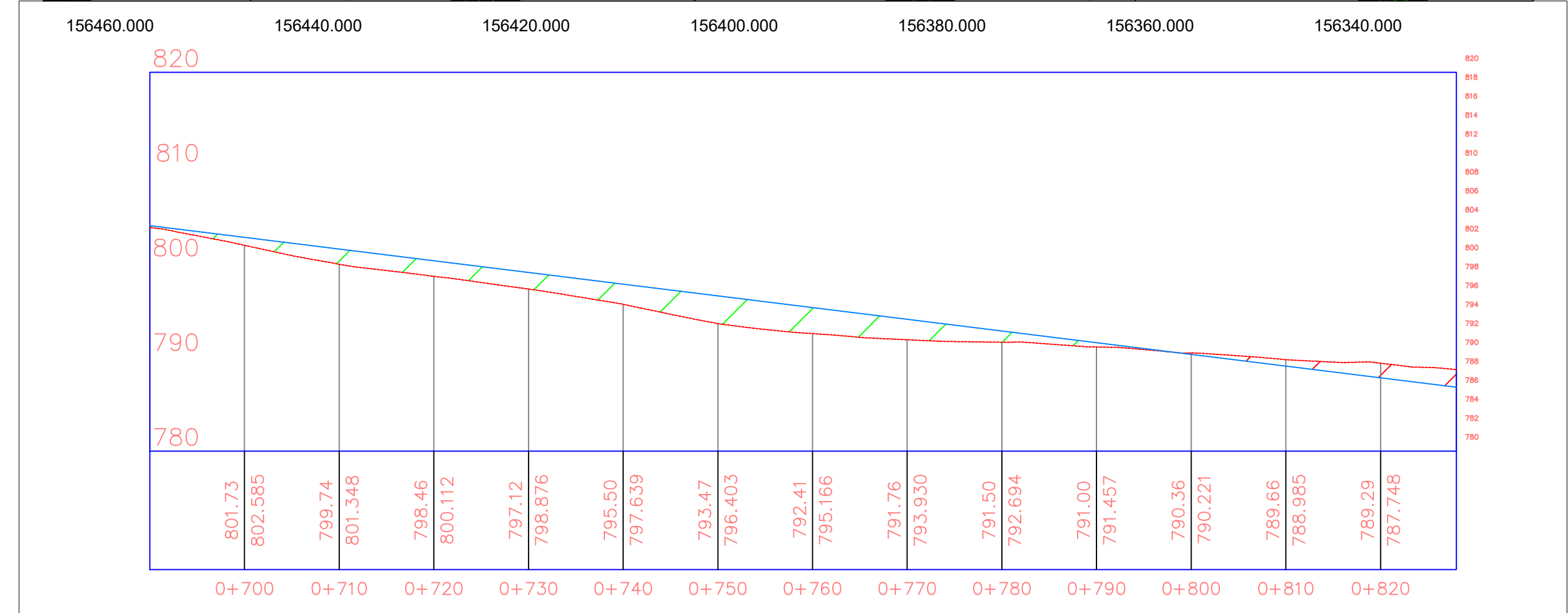
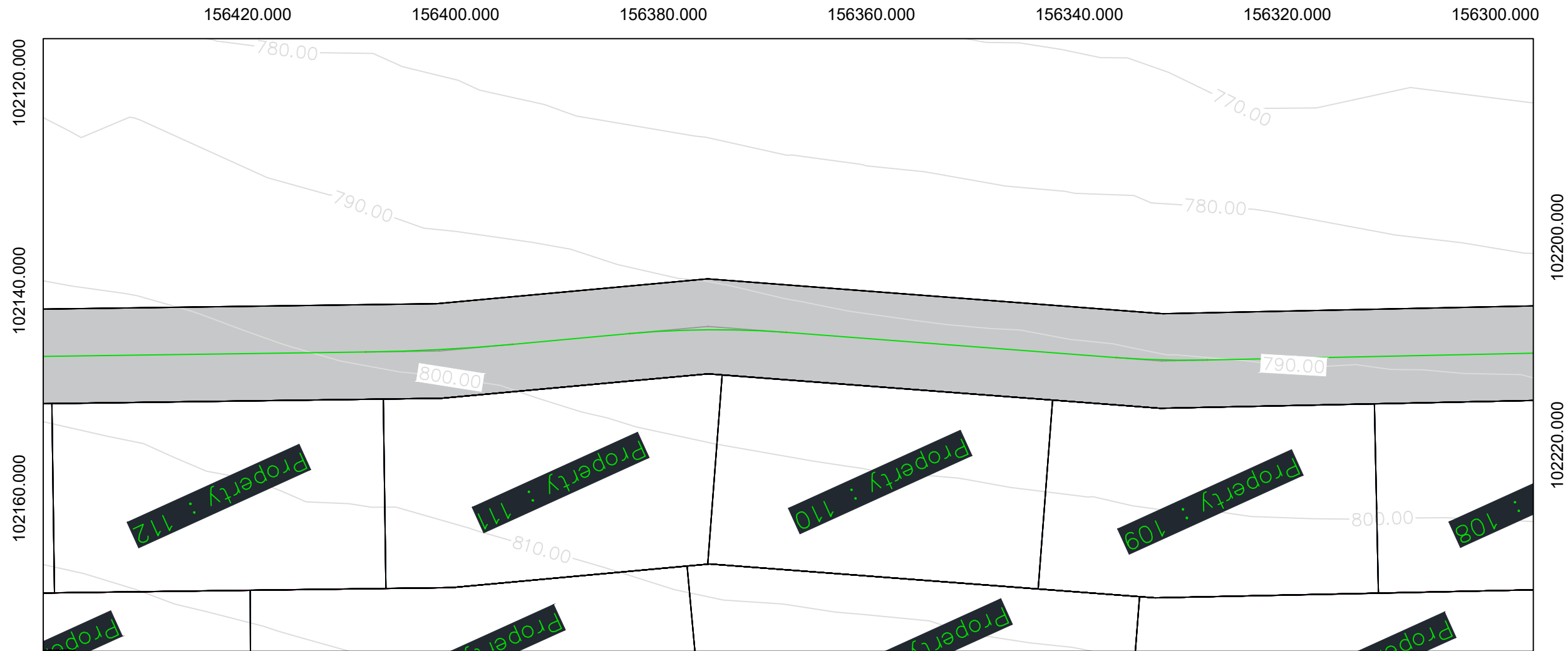

General Notes

Palestine Polytechnic University
College Of Engineering
Civil Department
Surveying & Geomatics Engineering

LEGAND

- Property
- Road
- Contour line

No.	Revision/Issue	Date

DESIGN BY:
Maha Khalaf
Deema Nar
Manar Abu Sharkh
BY D. Musab Shahien

Project Name and Address
Redesigning and planning part of the lands of Wadi al-Joz and Ain Naqar, located between the city of Hebron and Dura.

Project	Sheet
Redesigning and planning	
Date	12 / 1 / 2025
Scale	1 : 500

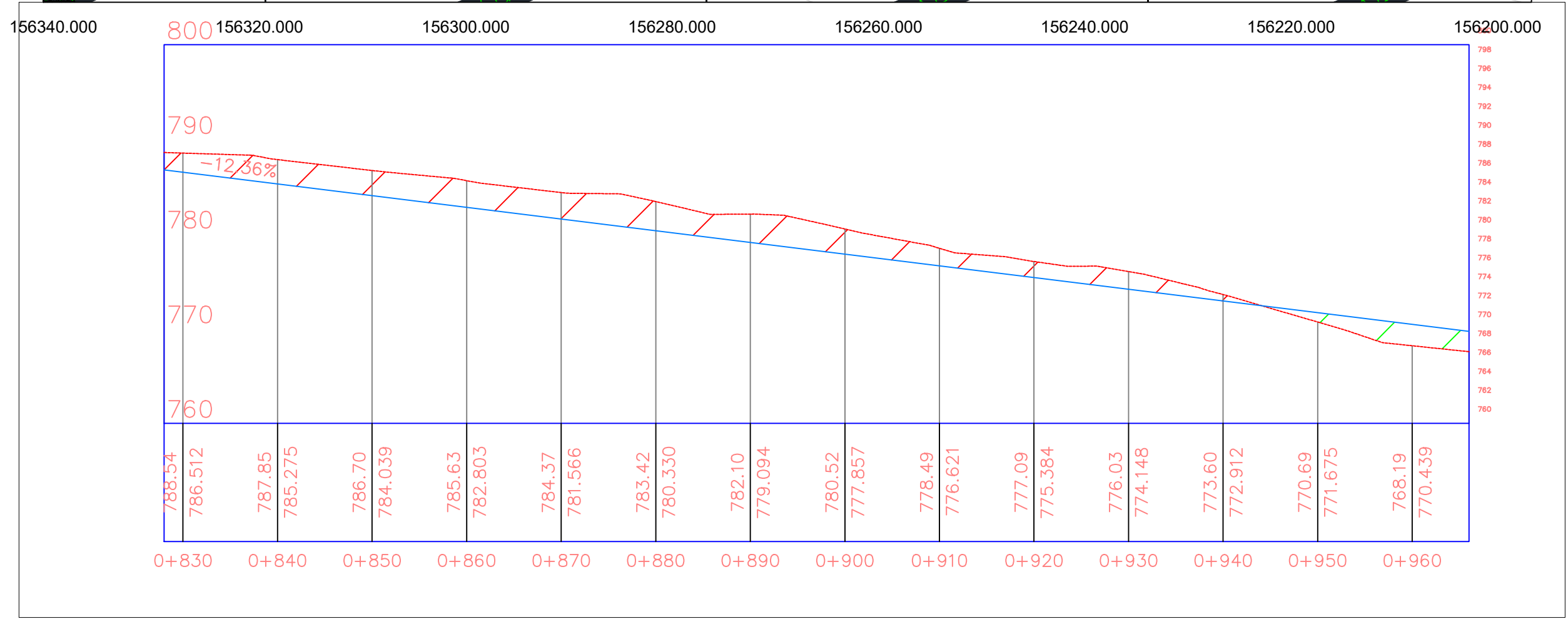
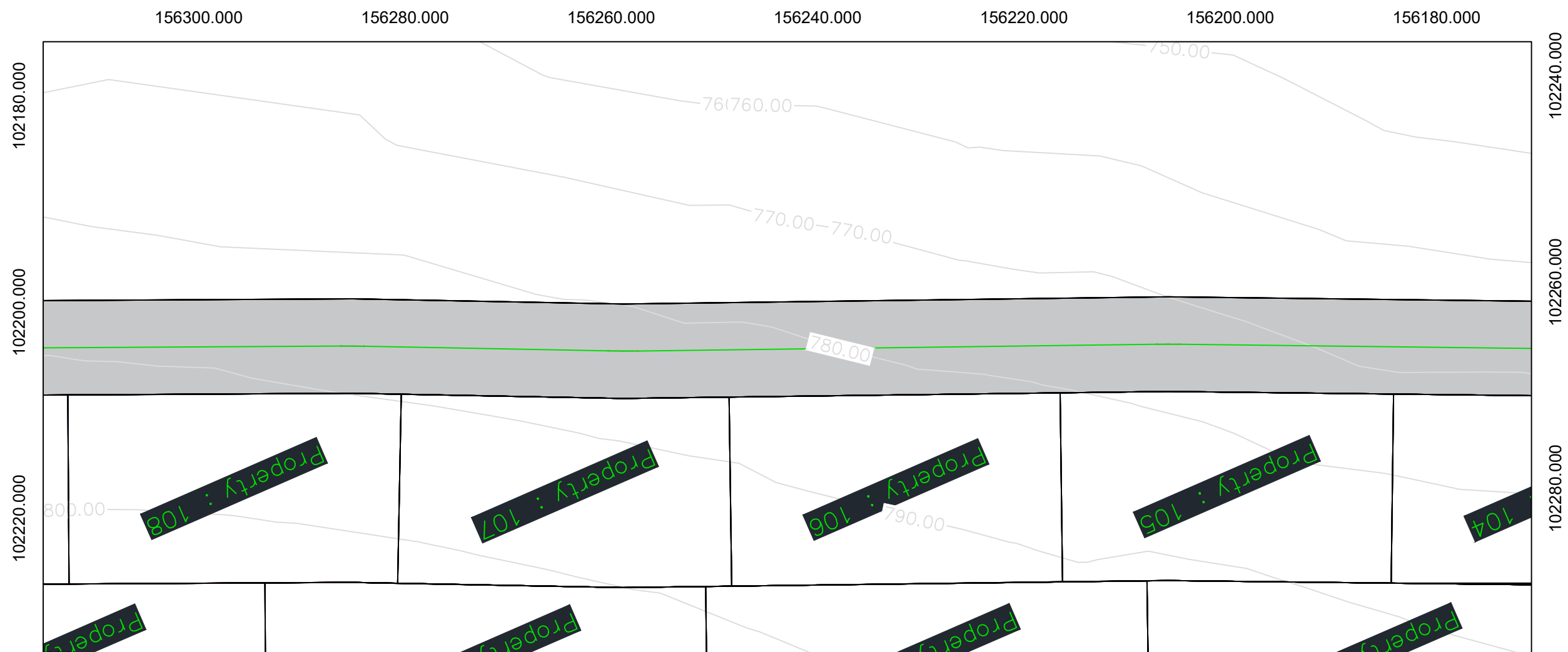

General Note

Palestine Polytechnic University
College Of Engineering
Civil Department
Surveying & Geomatics Engineering

LEGAND

- Property
- Road
- Contour line

No.	Revision/Issue	Date

DESIGN BY:
Maha Khalaf
Deema Nar
Manar Abu Sharkh
BY D. Musab Shahien

Project Name and Address
Redesigning and planning part of the lands of Wadi al-Joz and Ain Naqar, located between the city of Hebron and Dura.

Project	Sheet
Redesigning and planning	
Date	12 / 1 / 2025
Scale	1 : 500

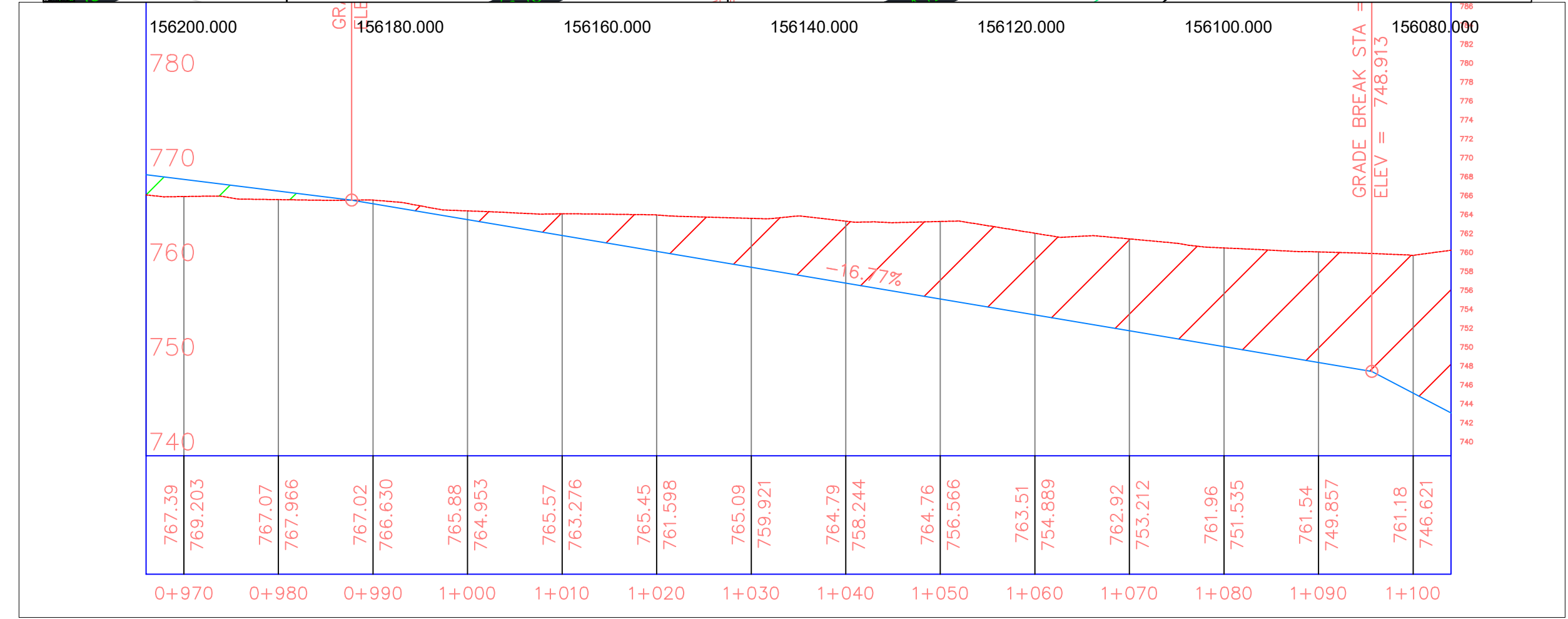
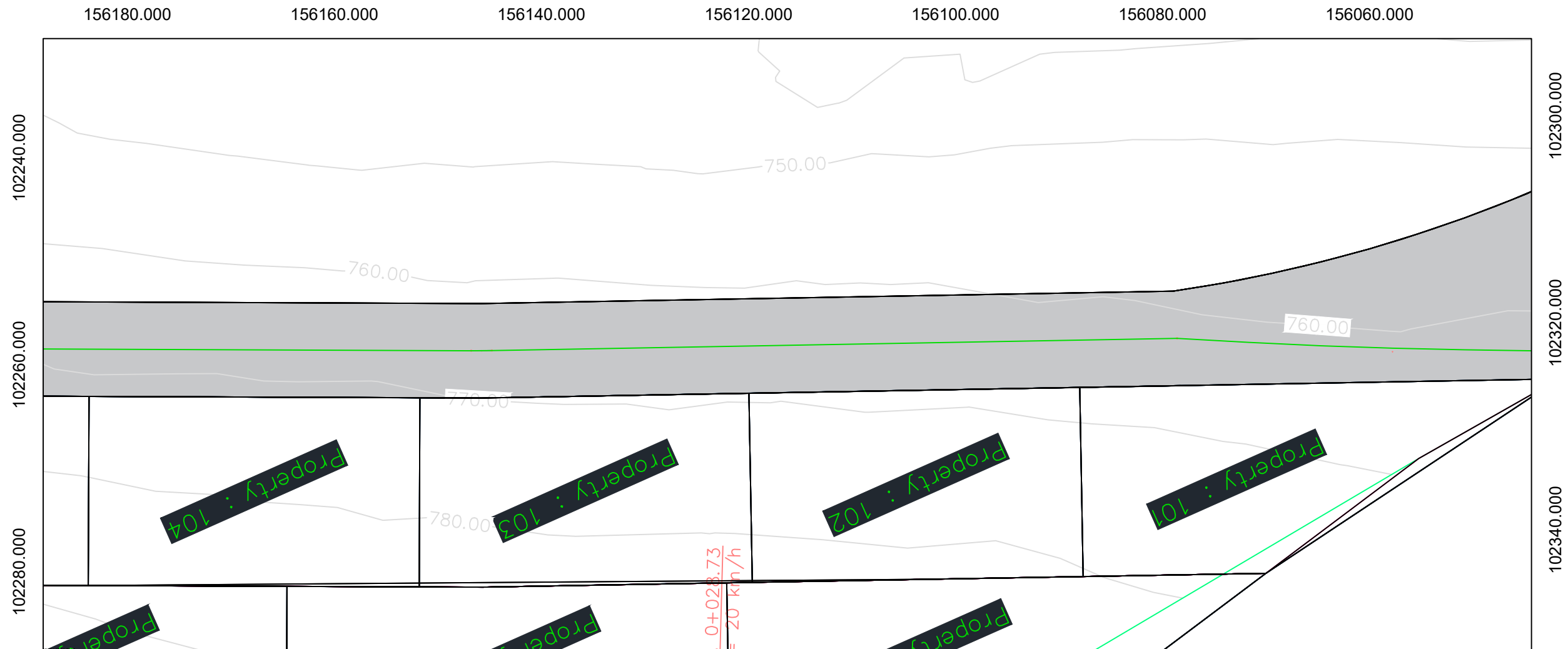

General Notes

Palestine Polytechnic University
College Of Engineering
Civil Department
Surveying & Geomatics Engineering

LEGAND

- Property (Green outline)
- Road (Grey fill)
- Contour line (Black line)

No.	Revision/Issue	Date

DESIGN BY:
Maha Khalaf
Deema Nsr
Manar Abu Sharkh
BY D. Musab Shahien

Project Name and Address:
Redesigning and planning part of the lands of Wadi al-Joz and Ain Naqar, located between the city of Hebron and Dura.

Project: Redesigning and planning
Date: 12 / 1 / 2025
Scale: 1 : 500

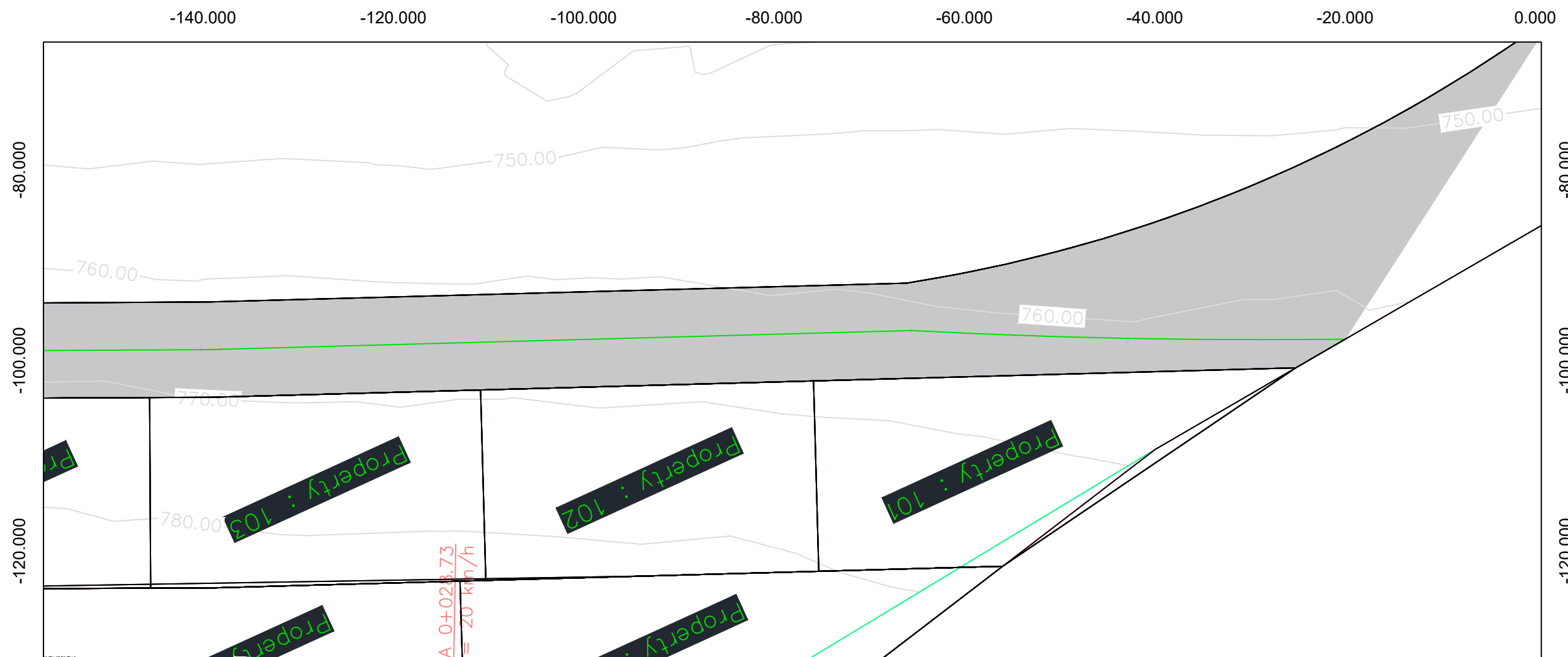

General Notes

Palestine Polytechnic University
College Of Engineering
Civil Department
Surveying & Geomatics Engineering

LEGAND

- Property
- Road
- Contour line

No.	Revision/Issue	Date

DESIGN BY:
Maha Khalaf
Deema Nar
Manor Abu Sharkh
BY D. Musab Shahlen

Project Name and Address

Redesigning and planning part of the lands of Wadi al-Joz and Ain Naqar, located between the city of Hebron and Dura.

Project	Sheet
Redesigning and planning	

Date: 12 / 1 / 2025
Scale: 1 : 500