

General Notes

Palestine Polytechnic University
College Of Engineering
Civil Department
Surveying & Geomatics Engineering

N

LEGAND

- Property
- Road
- Contour line

No.	Revision/Issue	Date

DESIGN BY:
Maha Khalaf
Deerna Nar
Manar Abu Sharh
BY D. Musab Shahien

Project Name and Address
Redesigning and planning part of the lands of Wadi al-Joz and Ain Naqar, located between the city of Hebron and Dura.

Project
Redesigning and planning

Sheet

Date: 12 / 1 / 2025
Scale: 1 : 500

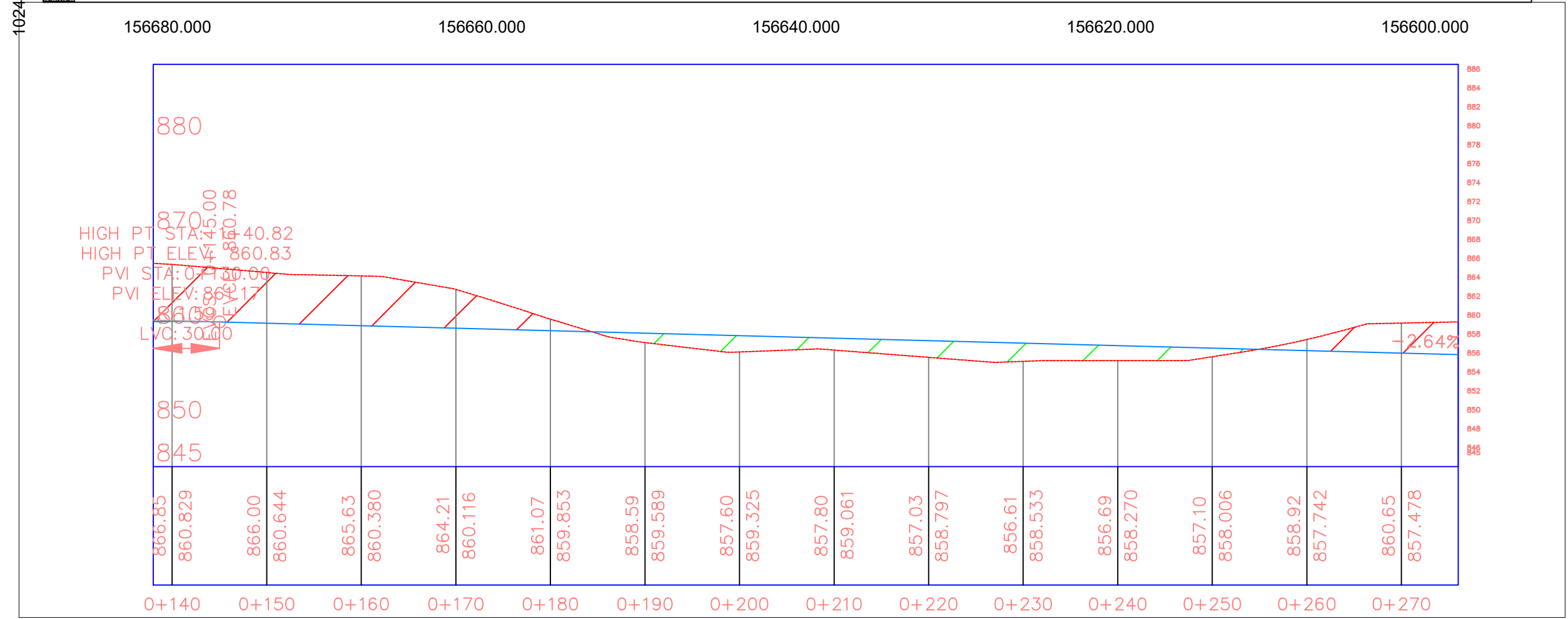
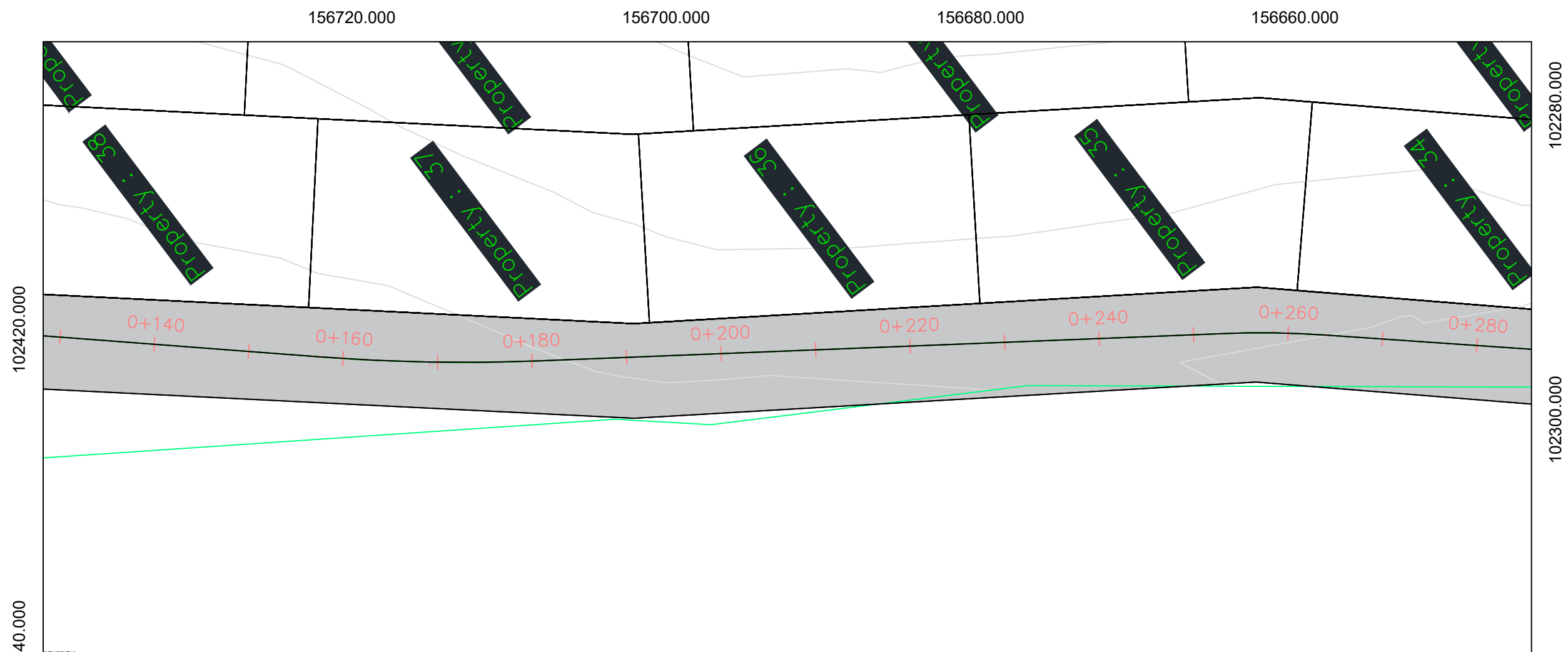

General Notes

Palestine Polytechnic University
College Of Engineering
Civil Department
Surveying & Geomatics Engineering

LEGAND

- Property
- Road
- Contour line

No.	Revision/Issue	Date

DESIGN BY:
Maha Khallaf
Deema Ner
Manar Abu Sharikh
BY D. Musab Shahlen

Project Name and Address
Redesigning and planning part of the lands of Wadi al-Joz and Ain Naqar, located between the city of Hebron and Dura.

Project	Sheet
Redesigning and planning	
Date: 12 / 1 / 2025	
Scale: 1 : 500	

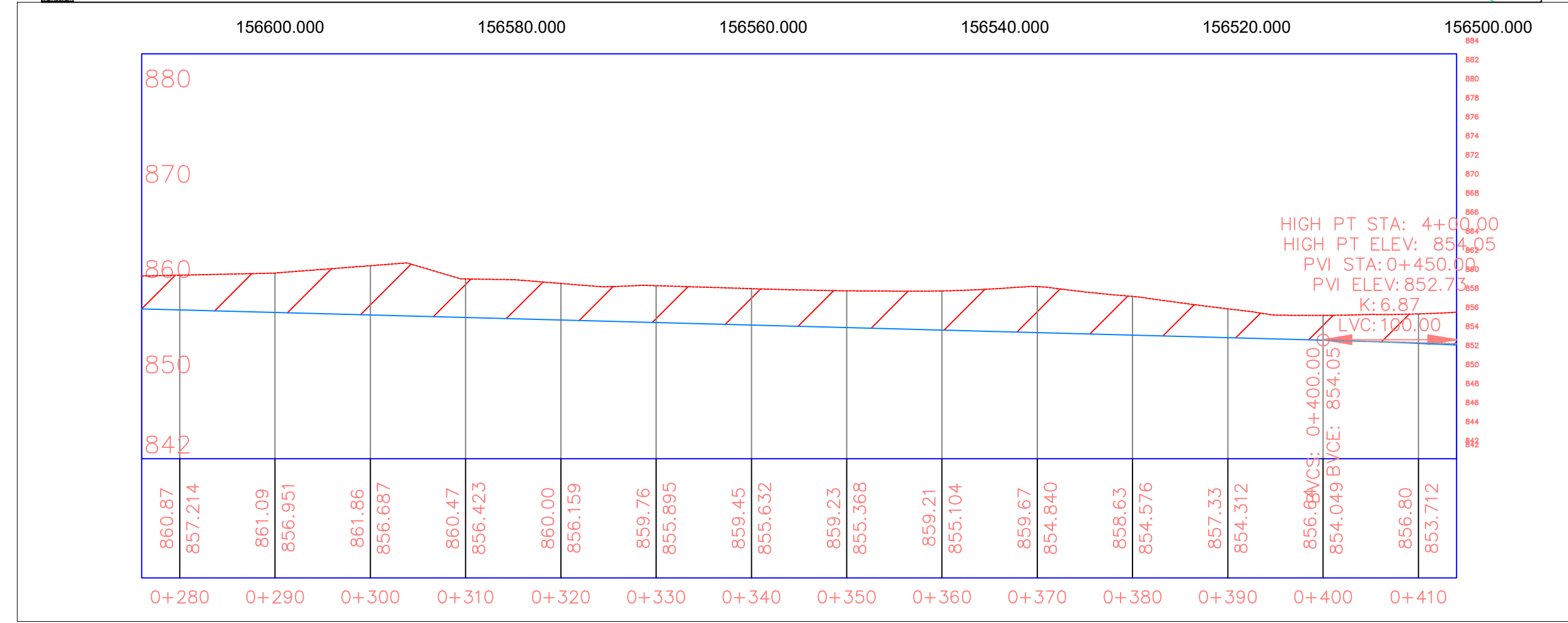
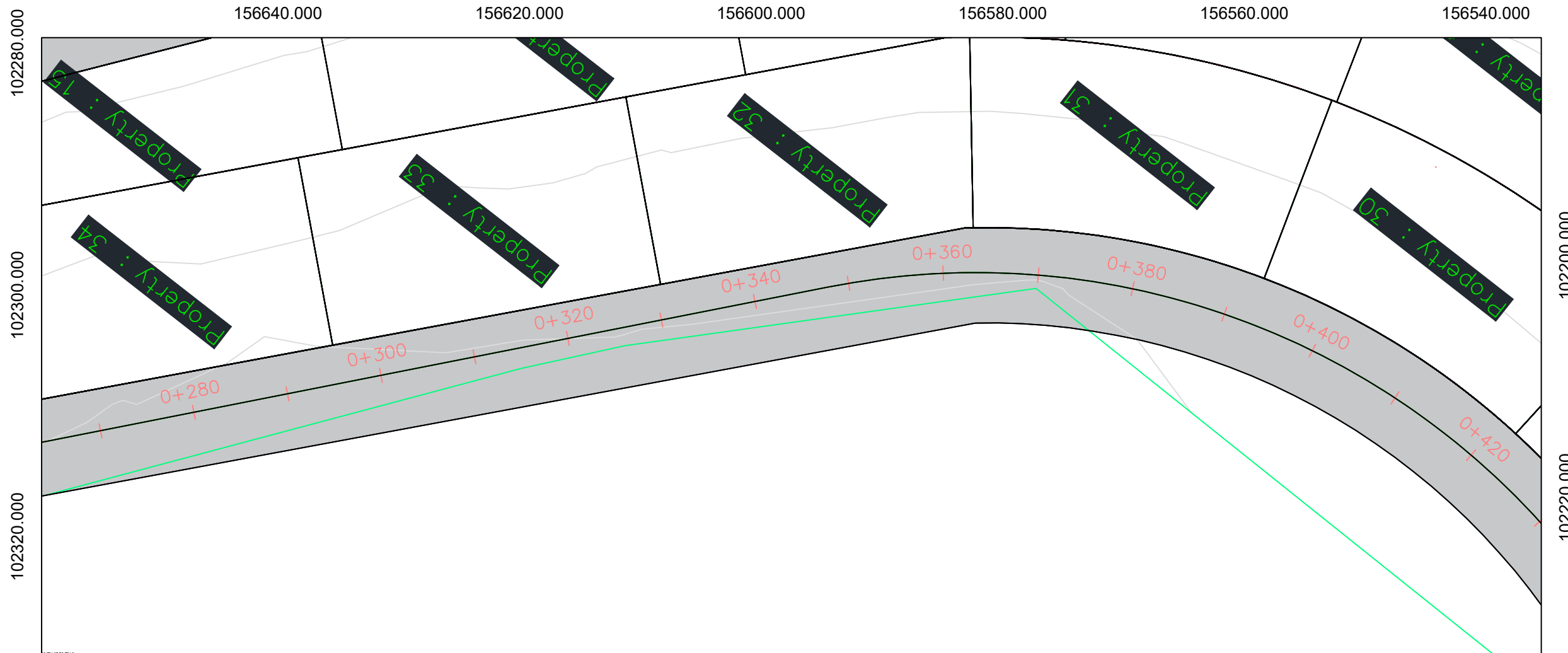

General Notes

Palestine Polytechnic University
College Of Engineering
Civil Department
Surveying & Geomatics Engineering

LEGAND

- Property
- Road
- Contour line

No.	Revision/Issue	Date

DESIGN BY:
Maha Khalaf
Deema Nar
Manor Abu Sharkh
BY D. Musab Shahlen

Project Name and Address

Redesigning and planning part of the lands of Wadi al-Joz and Ain Naqar, located between the city of Hebron and Dura.

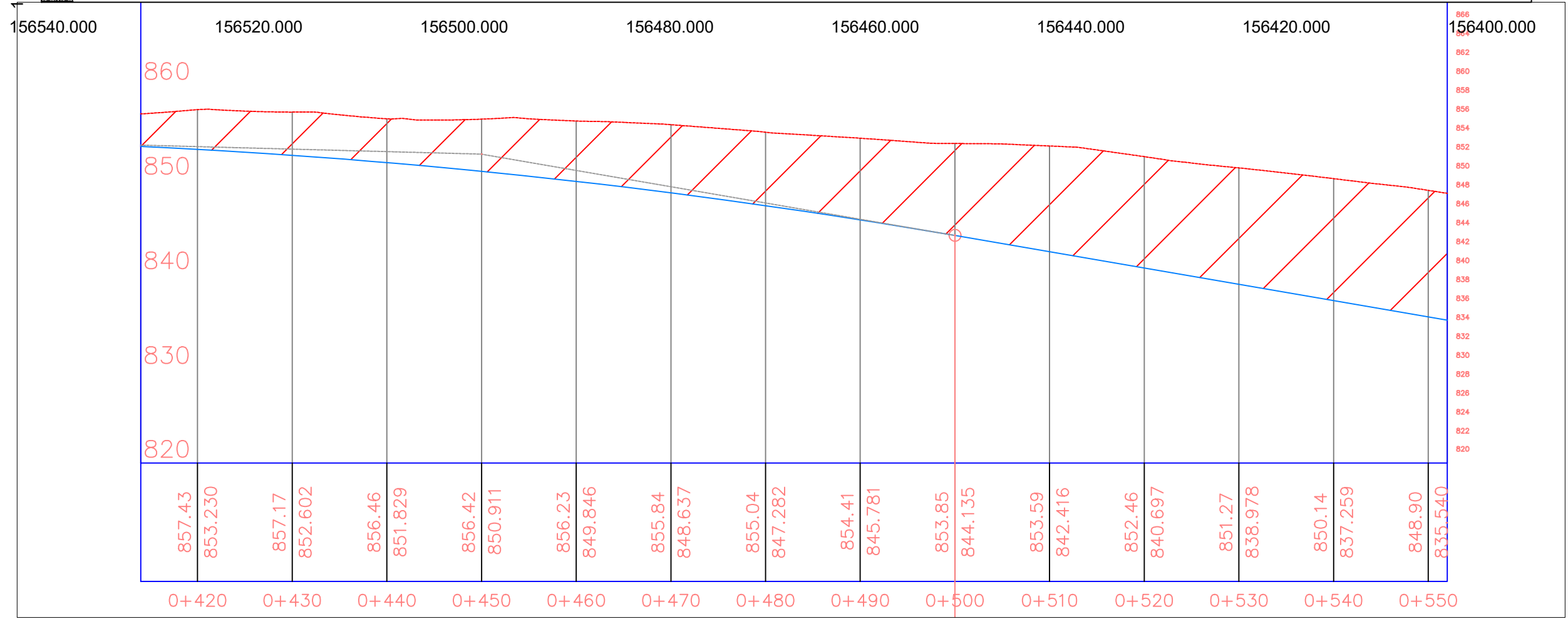
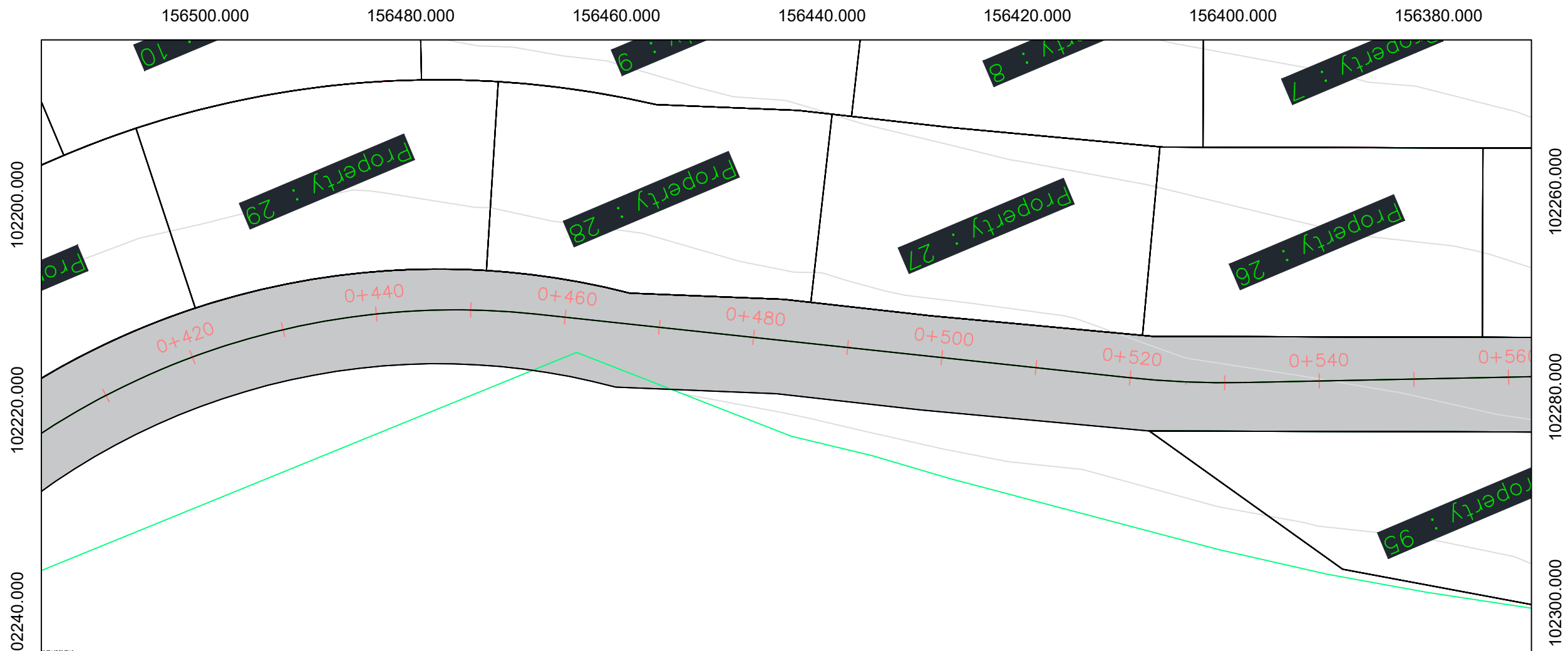

Project	Sheet
Redesigning and planning	

Date: 12 / 1 / 2025
Scale: 1 : 500





General Notes

Palestine Polytechnic University
College Of Engineering
Civil Department
Surveying & Geomatics Engineering

LEGAND

- Property 
- Road 
- Contour line 

No.	Revision/Issue	Date

DESIGN BY:
Maha Khalaf
Deema Niar
Mansour Abu Sharkh
BY D. Musab Shahien

Project Name and Address:
Redesigning and planning part of the lands of Wadi al-Joz and Ain Naqar, located between the city of Hebron and Dura.

Project	Sheet
Redesigning and planning	
Date: 12 / 1 / 2025	
Scale: 1 : 500	

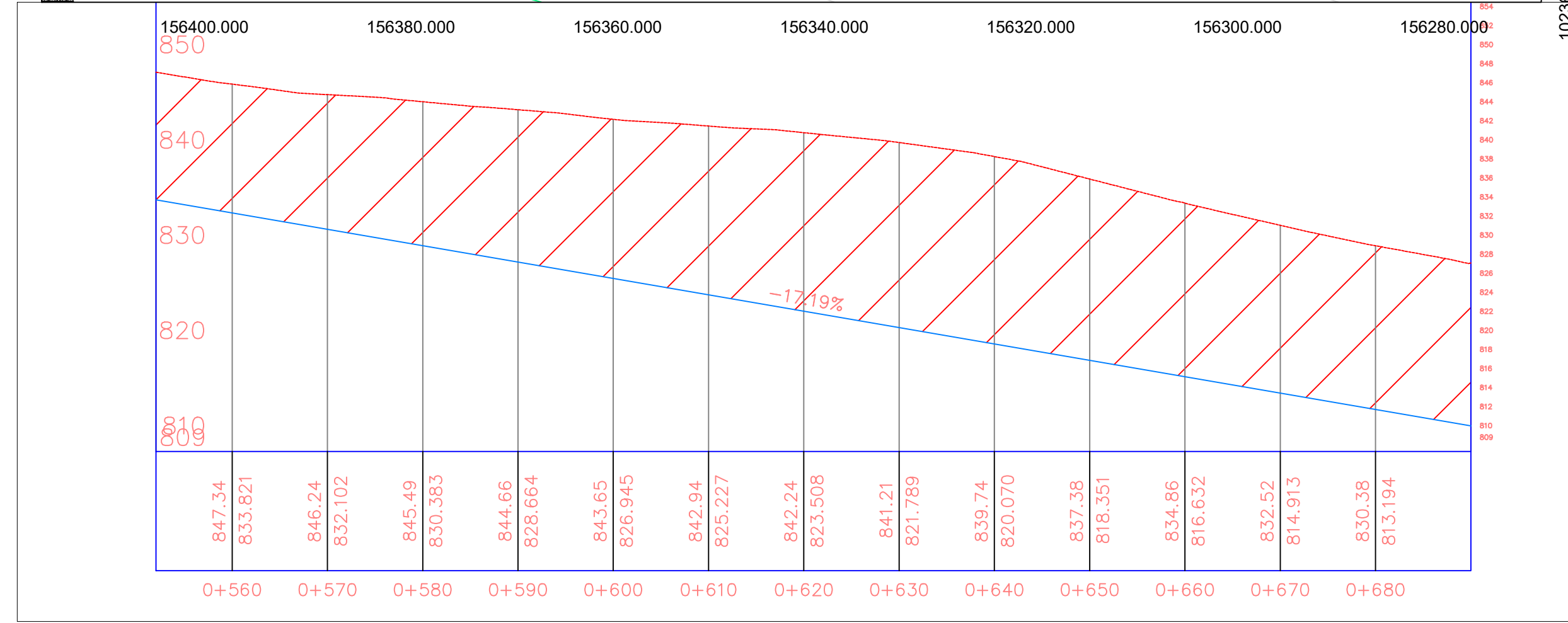
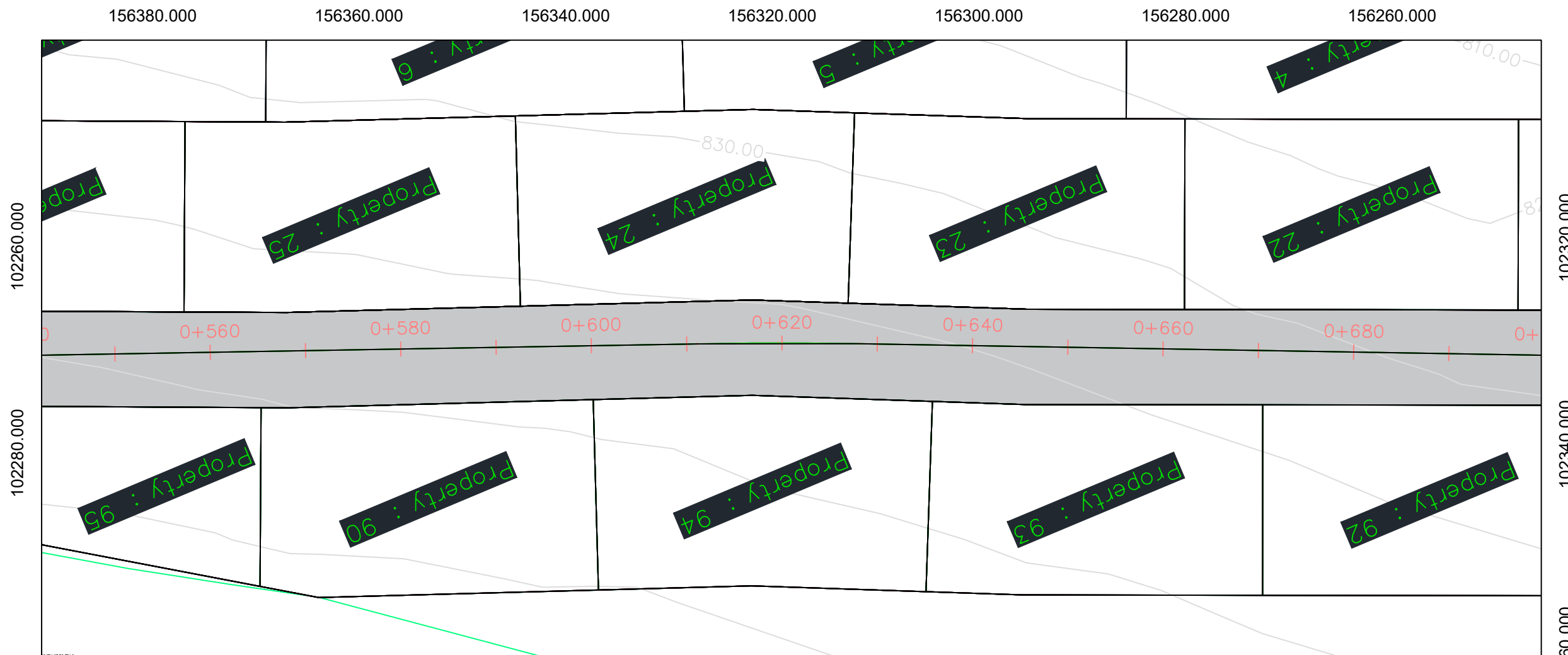

General Notes
 Palestine Polytechnic University
 College Of Engineering
 Civil Department
 Surveying & Geomatics Engineering

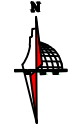

LEGAND

- Property
- Road
- Contour line

No.	Revision/Issue	Date

DESIGN BY:
 Maha Khalaf
 Deema Nsr
 Manar Abu Sharkh
 BY D. Musab Shahien

Project Name and Address
 Redesigning and planning part of the lands of Wadi al-Joz and Ain Naqar, located between the city of Hebron and Dura.

Project	Sheet
Surveying and planning	
Date	12 / 1 / 2025
Scale	1 : 500

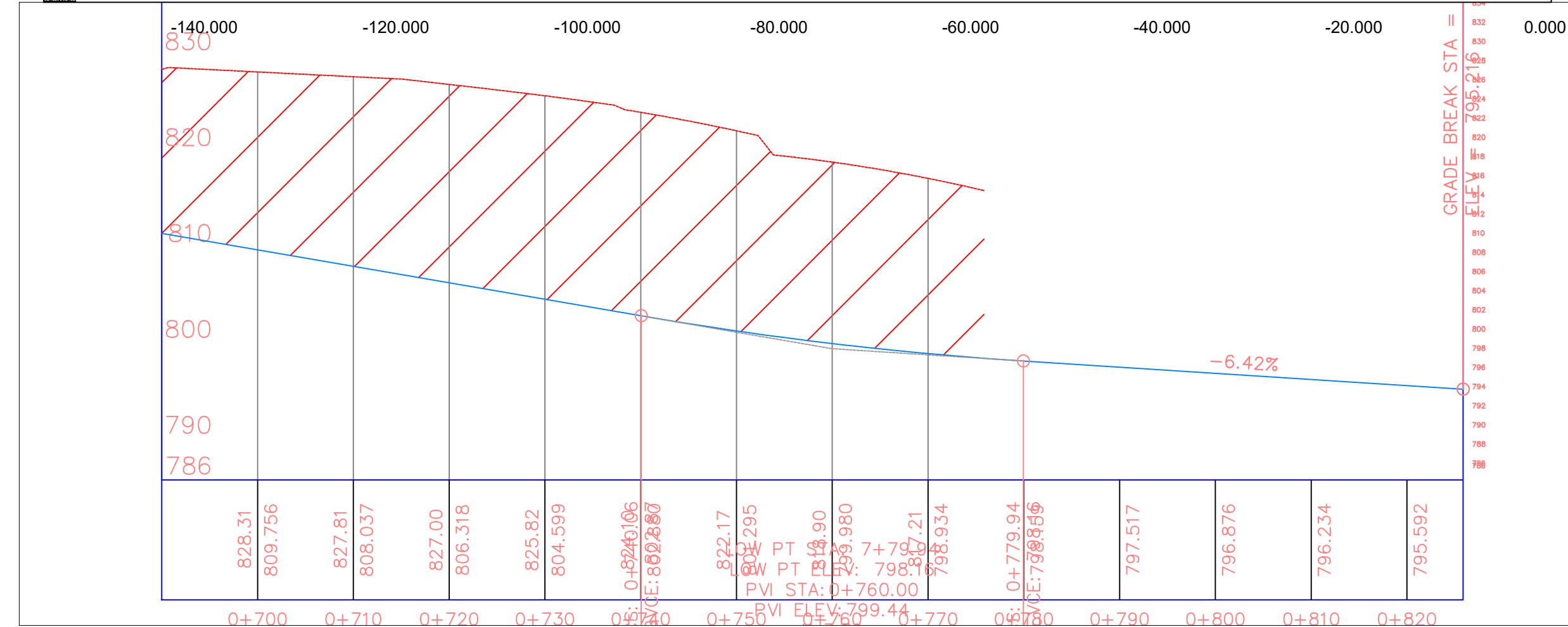
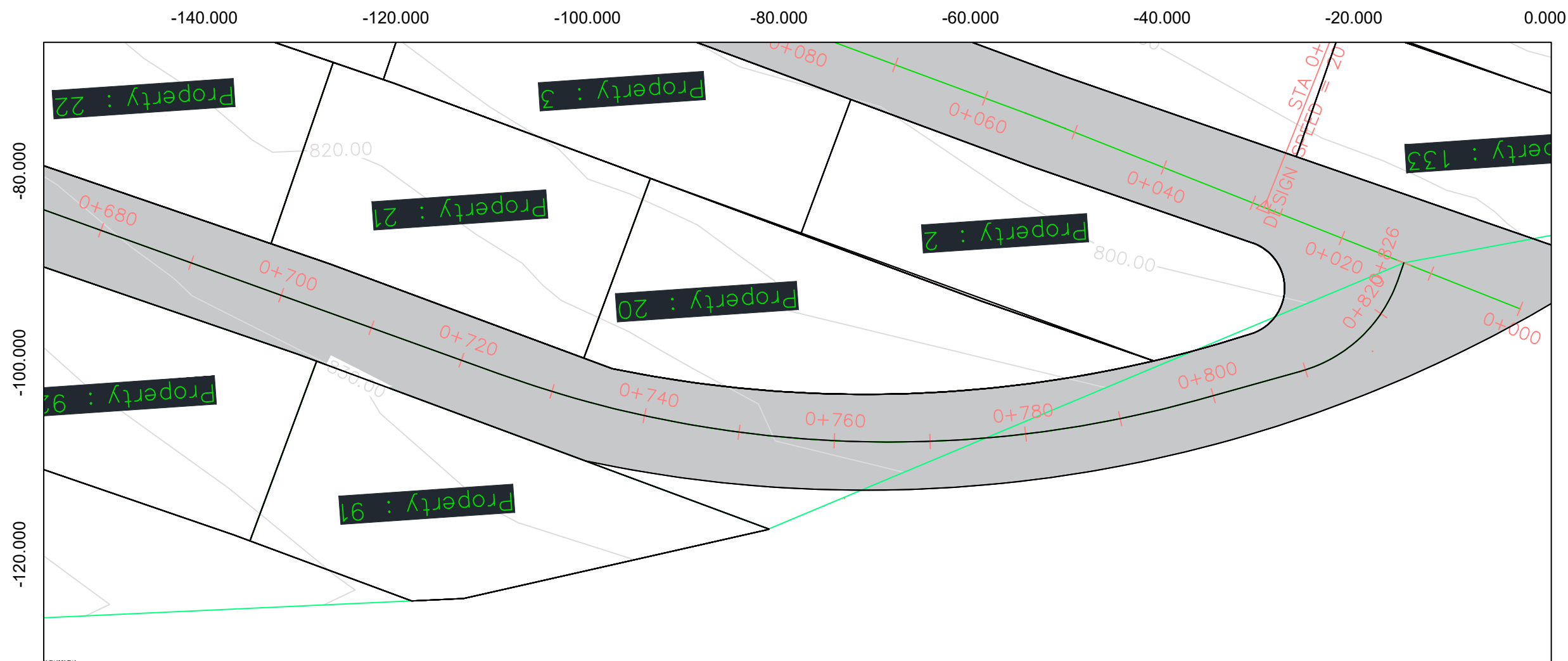

General Notes

Palestine Polytechnic University
College Of Engineering
Civil Department
Surveying & Geomatics Engineering

LEGEND

- Property
- Road
- Contour line

No.	Revision/Issue	Date

DESIGN BY:
Maha Khallaf
Deema Nar
Manar Abu Sharkh
BY D. Musab Shahien

Project Name and Address
Redesigning and planning part of the lands of Wadi al-Joz and Ain Naqar, located between the city of Hebron and Dura.

Project	Sheet
Redesigning and planning	
Date: 12 / 1 / 2025	
Scale: 1 : 500	