

COLLEGE OF ENGINEERING
CIVIL ENGINEERING DEPARTMENT
SURVEY ENGINEERING

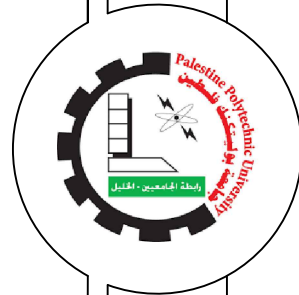

Project:

SEVENTY ROAD Project

Done by: _____

MOHAMMAD YASIN
OSAI D ASHQAR
MAHMOUD ABU SALAH

Supervisors: _____

ENG. NIDAL ABU RAJAB

Project sheet 's

Submitted to the College of Engineering
in partial fulfillment of the requirements
for the Bachelor degree in Civil Engineering

January - 2025

Sheet
#0

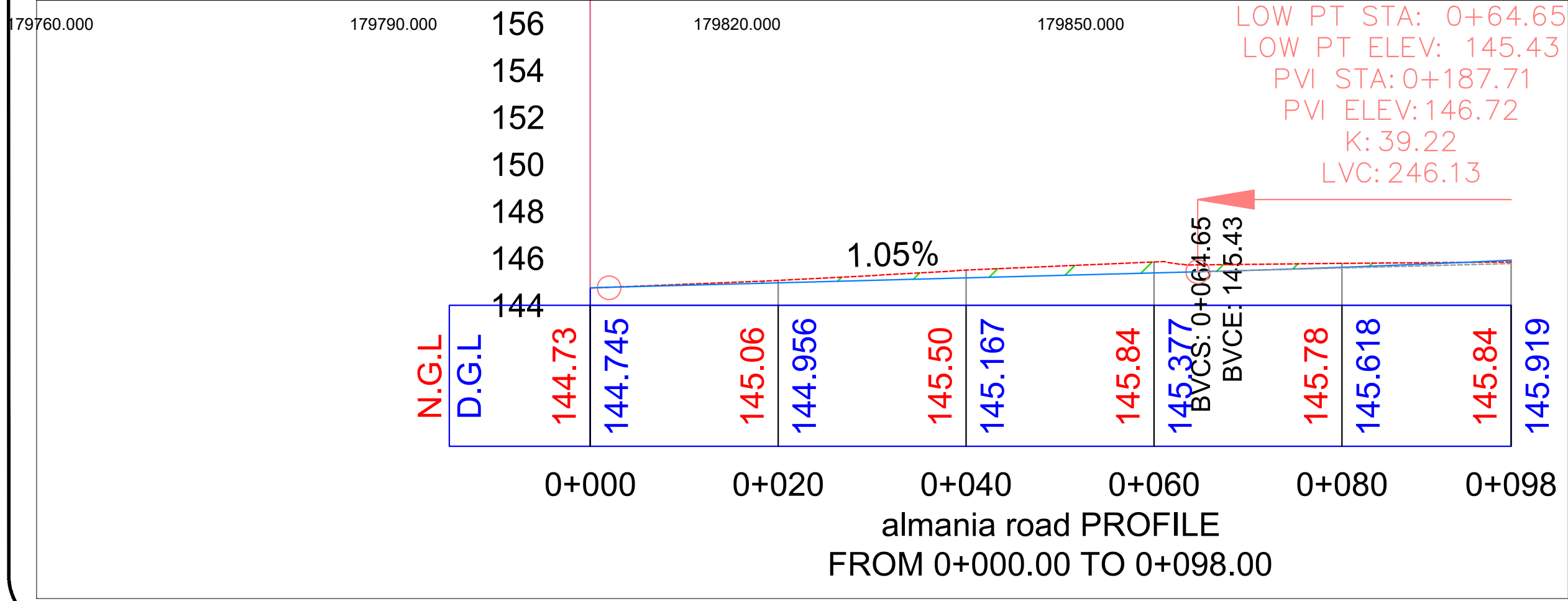
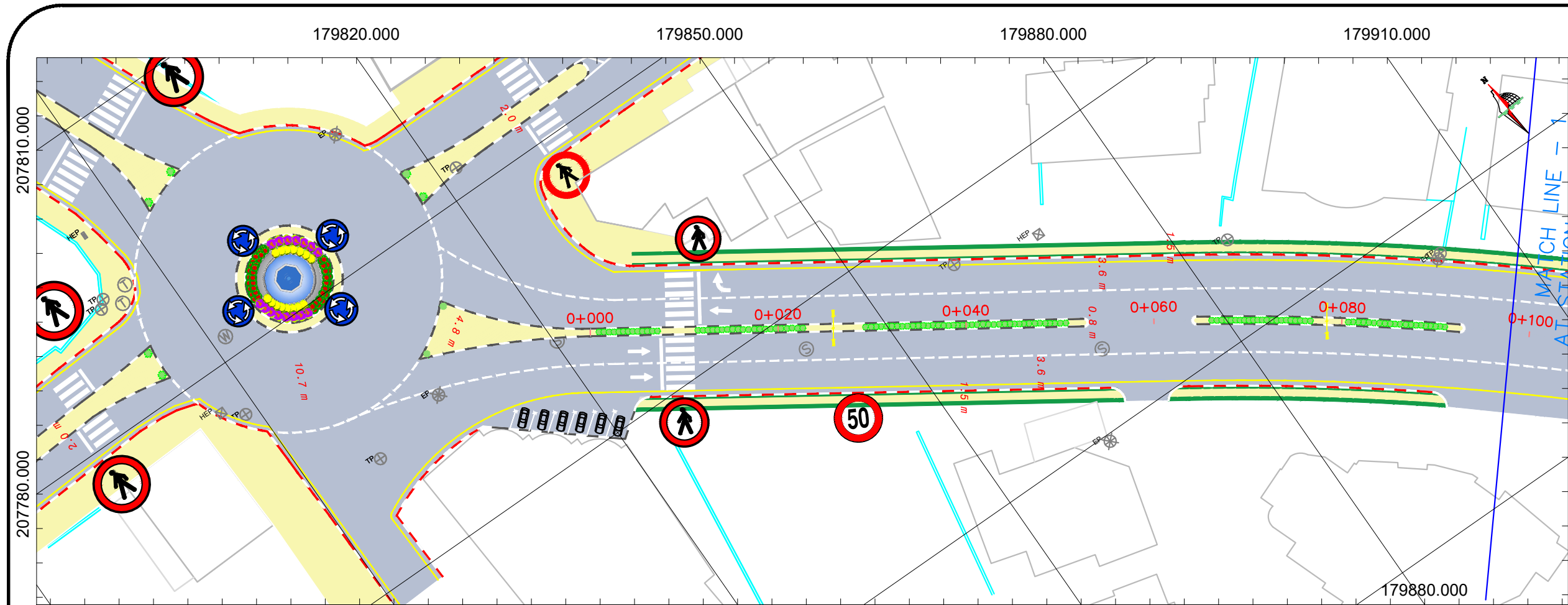

General Notes



PALESTINE POLYTECHNIC UNIVERSITY
college of engineering
Civil Engineering Department
Survey and Geomatics Engineering

LEGAND

- EP: Electric power
- TP: Telephone Power
- HEB: High Electron Beam
- S: Sewer Manhole
- ROUNDABOUT SIGN
- 50: SPEED LIMIT SIGN
- FOOT PATH SIGN
- : Curbstone
- : Asphalt
- : Concrete Wall
- : Building
- : SIDE WALK

No.	Revision/Issue	Date

Supervisor
Eng: Nidal abu rajab

Student Name
MOHAMAD YASIN
OSOID ASHQAR
MAHMOUD ABU SALAH

Project
design of Seventy Road

Sheet
Date: 10/1/2025
Scale: 1 : 500
1

almania road PROFILE
FROM 0+000.00 TO 0+098.00

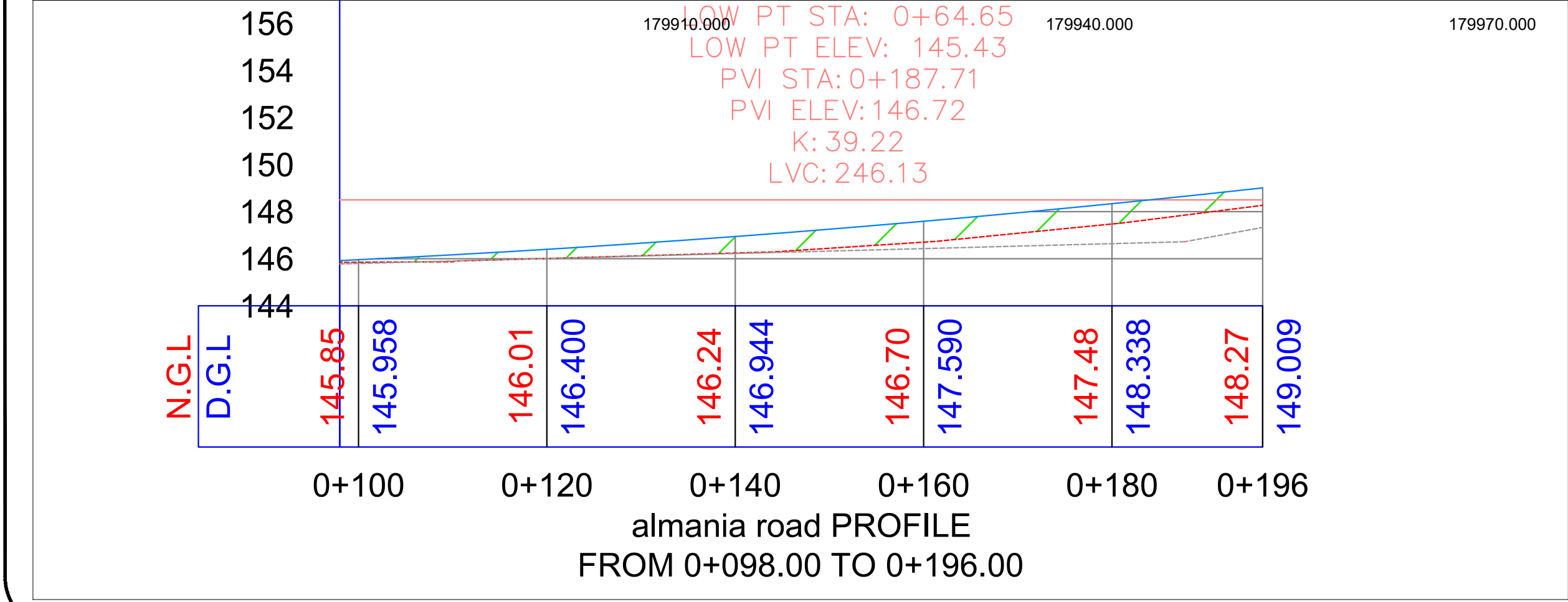
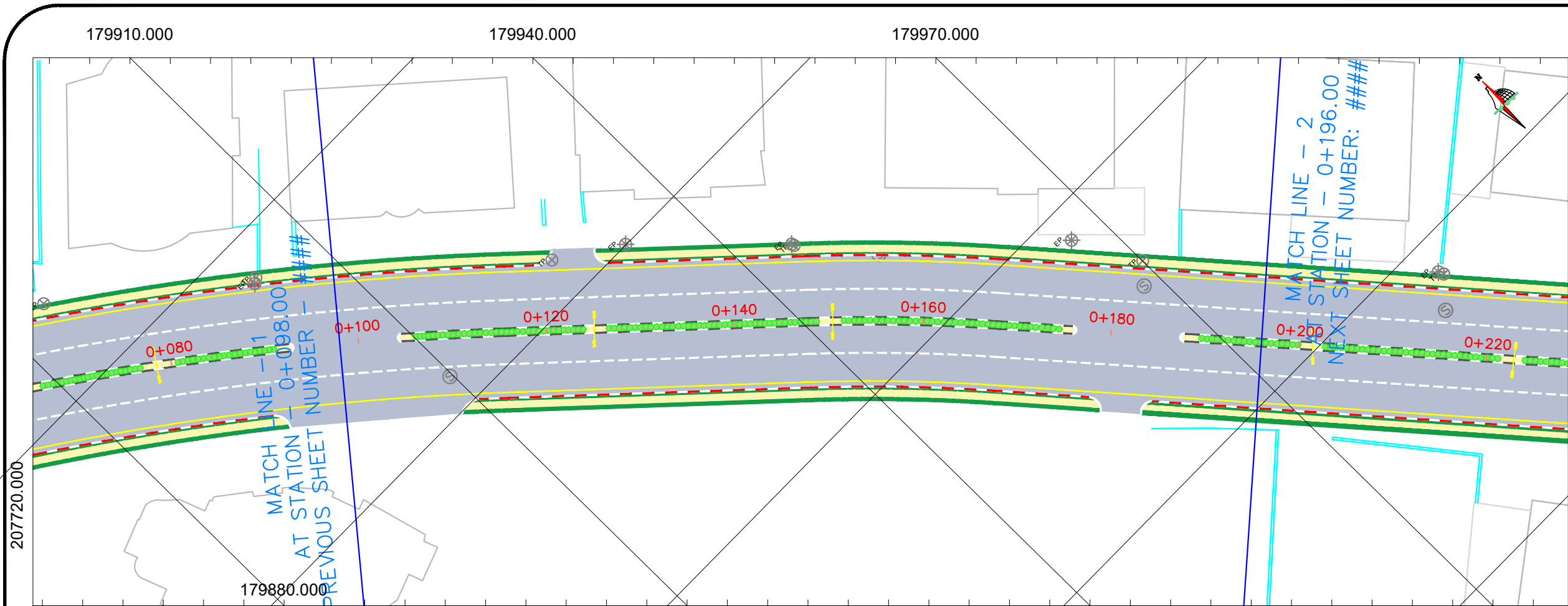

General Notes



PALESTINE POLYTECHNIC UNIVERSITY
 college of engineering
 Civil Engineering Department
 Survey and Geomatics Engineering

LEGAND

- EP Electric power
- TP Telephone Power
- Sewer Manhole
- ROUNDABOUT SIGN
- SPEED LIMIT SIGN
- FOOT PATH SIGN
- Curbstone
- Asphalt
- Concrete Wall
- Building
- SIDE WALK

No.	Revision/Issue	Date

Supervisor
 Eng: Nidal abu rajab

Student Name
 MOHAMAD YASIN
 OSAID ASHQAR
 MAHMOUD ABU SALAH

Project design of Seventy Road	Sheet 2
Date 10/1/2025	
Scale 1 : 500	

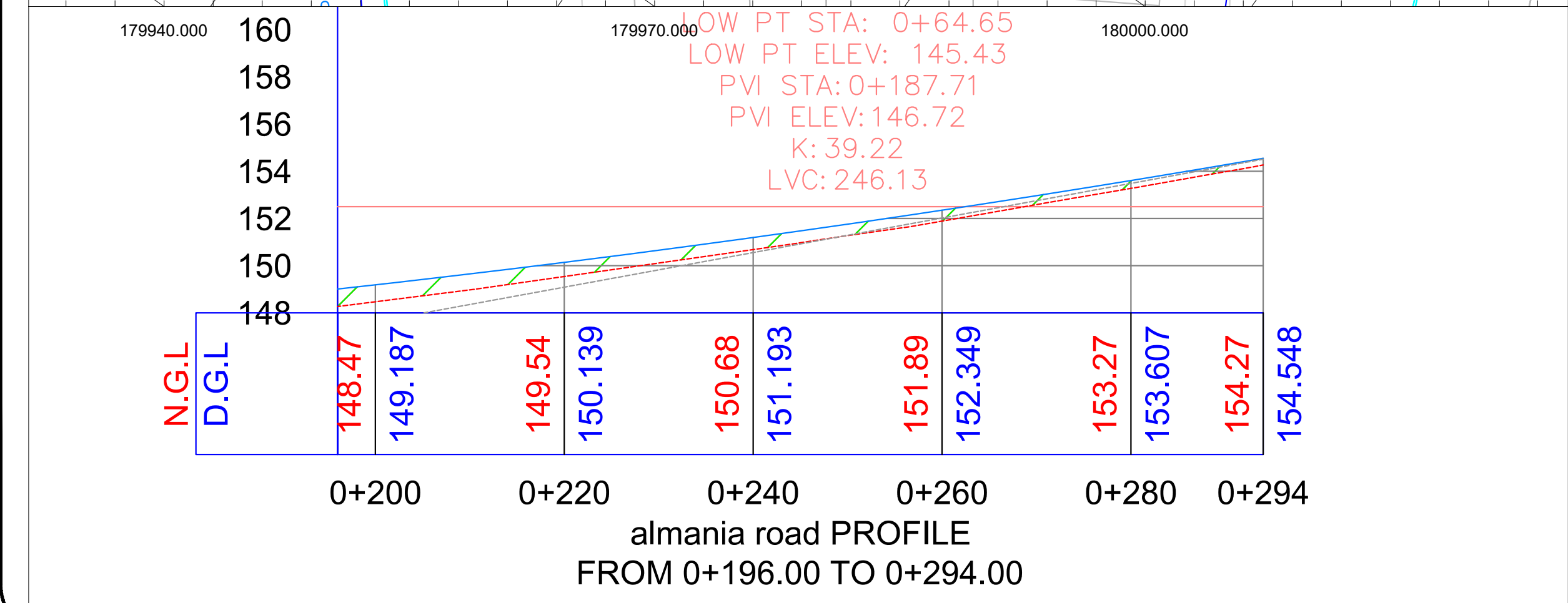
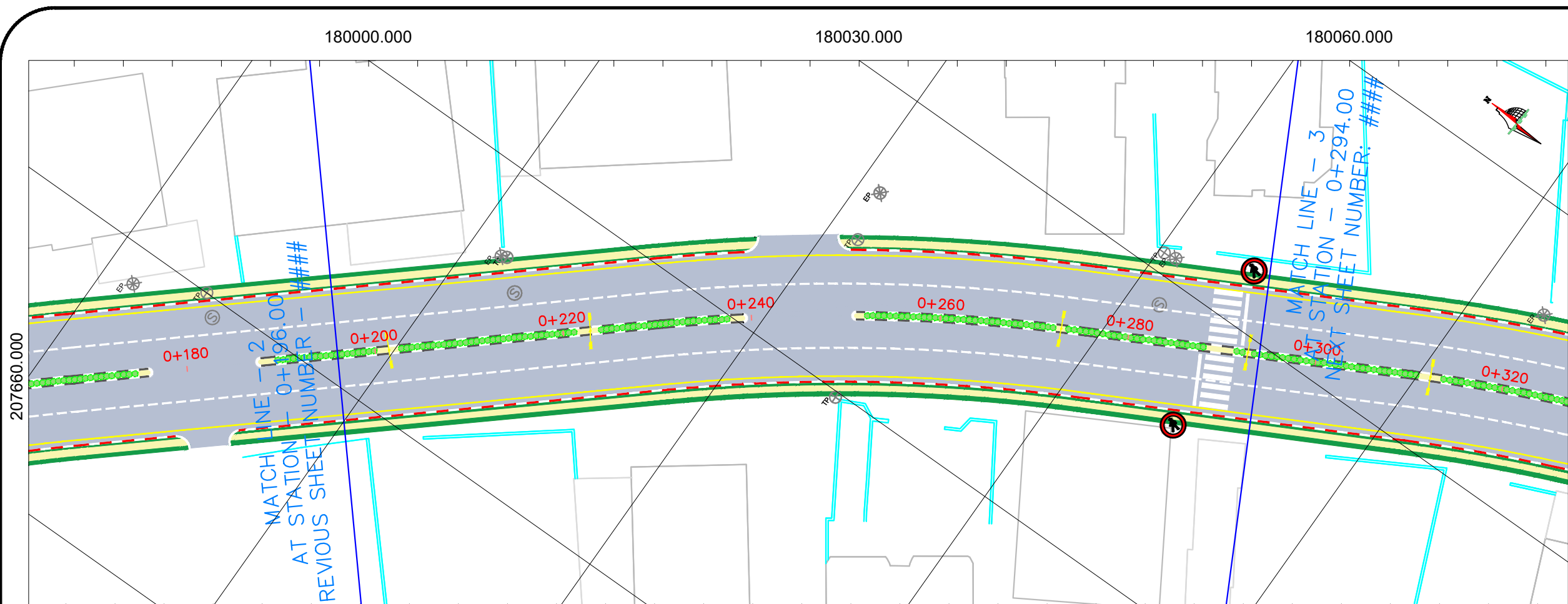

almania road PROFILE
FROM 0+196.00 TO 0+294.00

General Notes



PALESTINE POLYTECHNIC UNIVERSITY
college of engineering
Civil Engineering Department
Survey and Geomatics Engineering

LEGAND

- EP Electric power
- TP Telephone Power
- S Sewer Manhole
- ROUNDABOUT SIGN
- 50 SPEED LIMIT SIGN
- FOOT PATH SIGN
- Curbstone
- Asphalt
- Concrete Wall
- Building
- SIDE WALK

No.	Revision/Issue	Date

Supervisor
Eng: Nidal abu rajab

Student Name
MOHAMAD YASIN
OSAID ASHQAR
MAHMOUD ABU SALAH

Project design of Seventy Road	Sheet 3
Date 10/1/2025	
Scale 1 : 500	

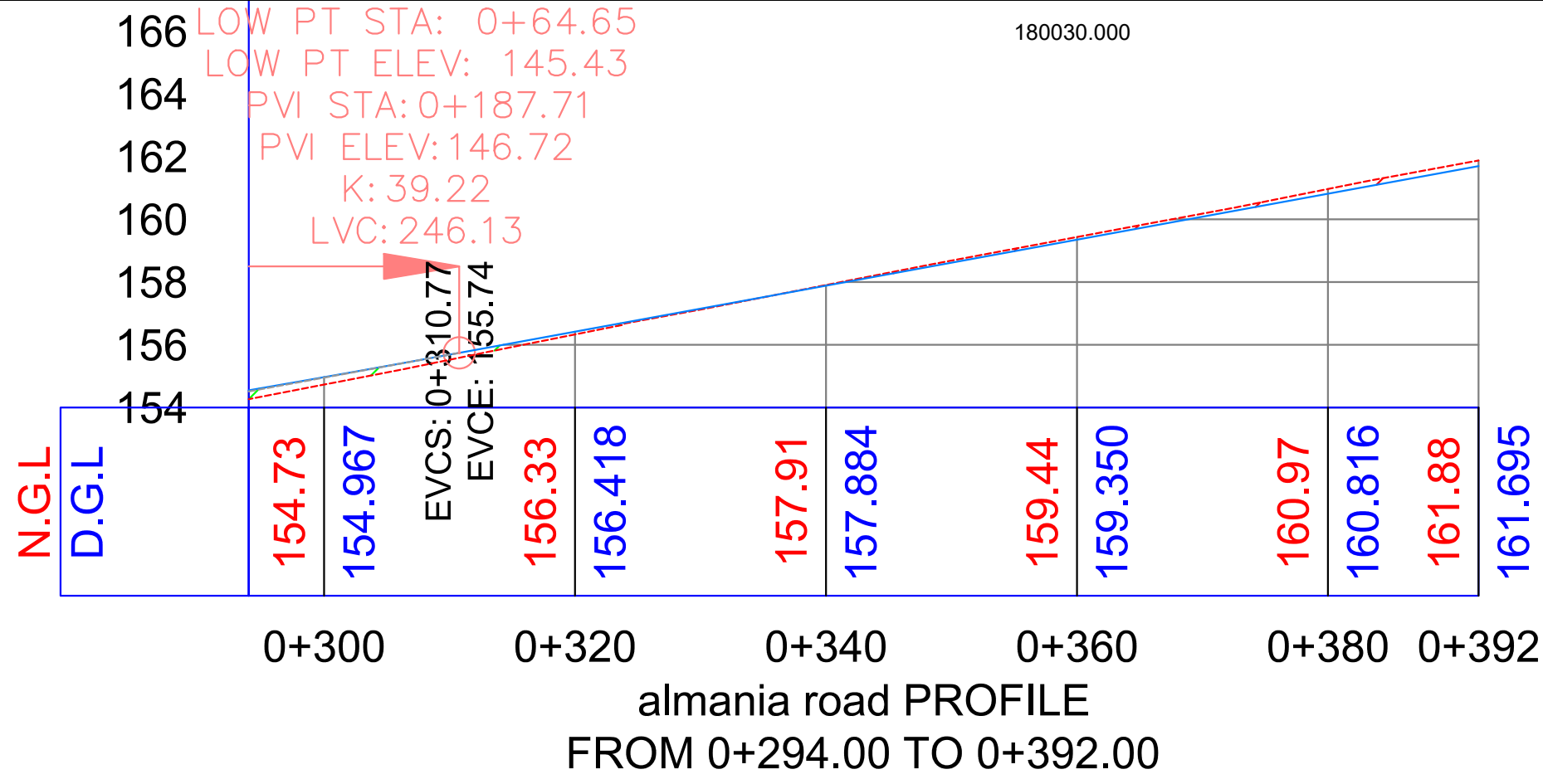
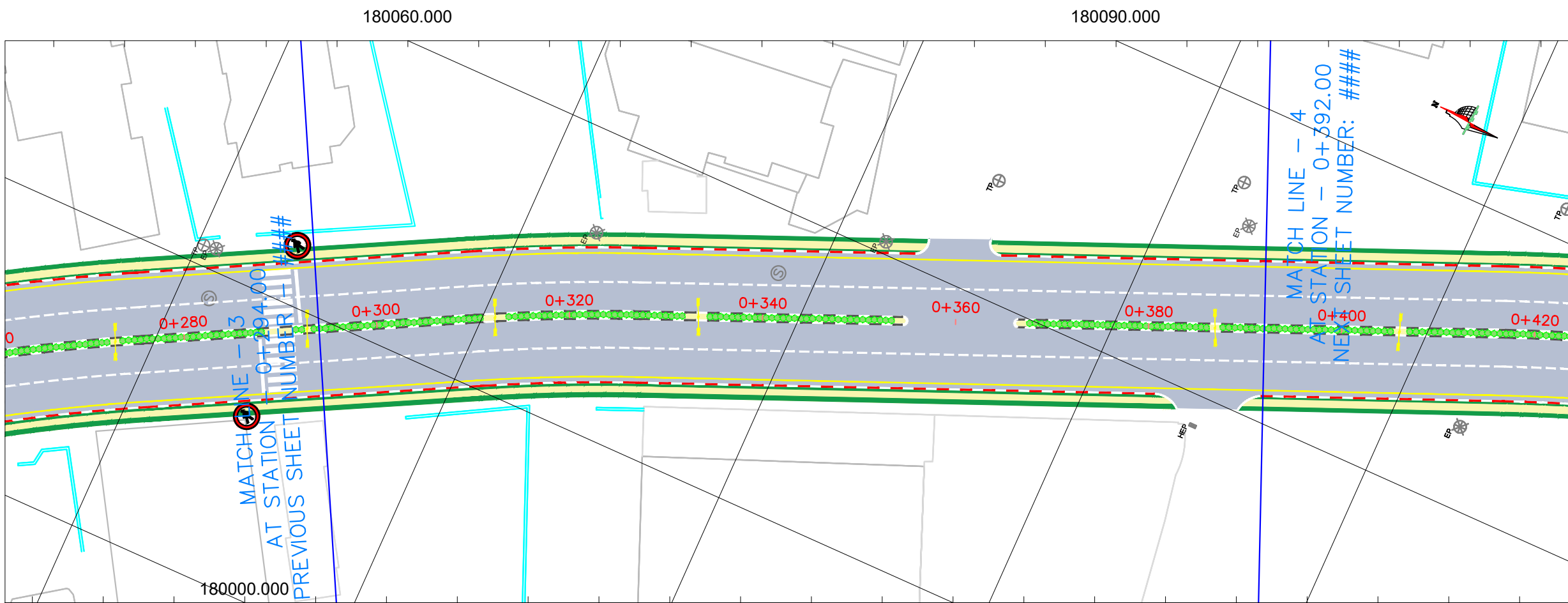

almania road PROFILE
 FROM 0+294.00 TO 0+392.00

General Notes



PALESTINE POLYTECHNIC UNIVERSITY
 college of engineering
 Civil Engineering Department
 Survey and Geomatics Engineering

LEGAND

- EP Electric power
- TP Telephone Power
- S Sewer Manhole
- ROUNDABOUT SIGN
- 50 SPEED LIMIT SIGN
- FOOT PATH SIGN
- Curbstone
- Asphalt
- Concrete Wall
- Building
- SIDE WALK

No.	Revision/Issue	Date

Supervisor
 Eng: Nidal abu rajab

Student Name
 MOHAMAD YASIN
 OSAID ASHQAR
 MAHMOUD ABU SALAH

Project design of Seventy Road	Sheet 4
Date 10/1/2025	
Scale 1 : 500	

180090.000

180120.000

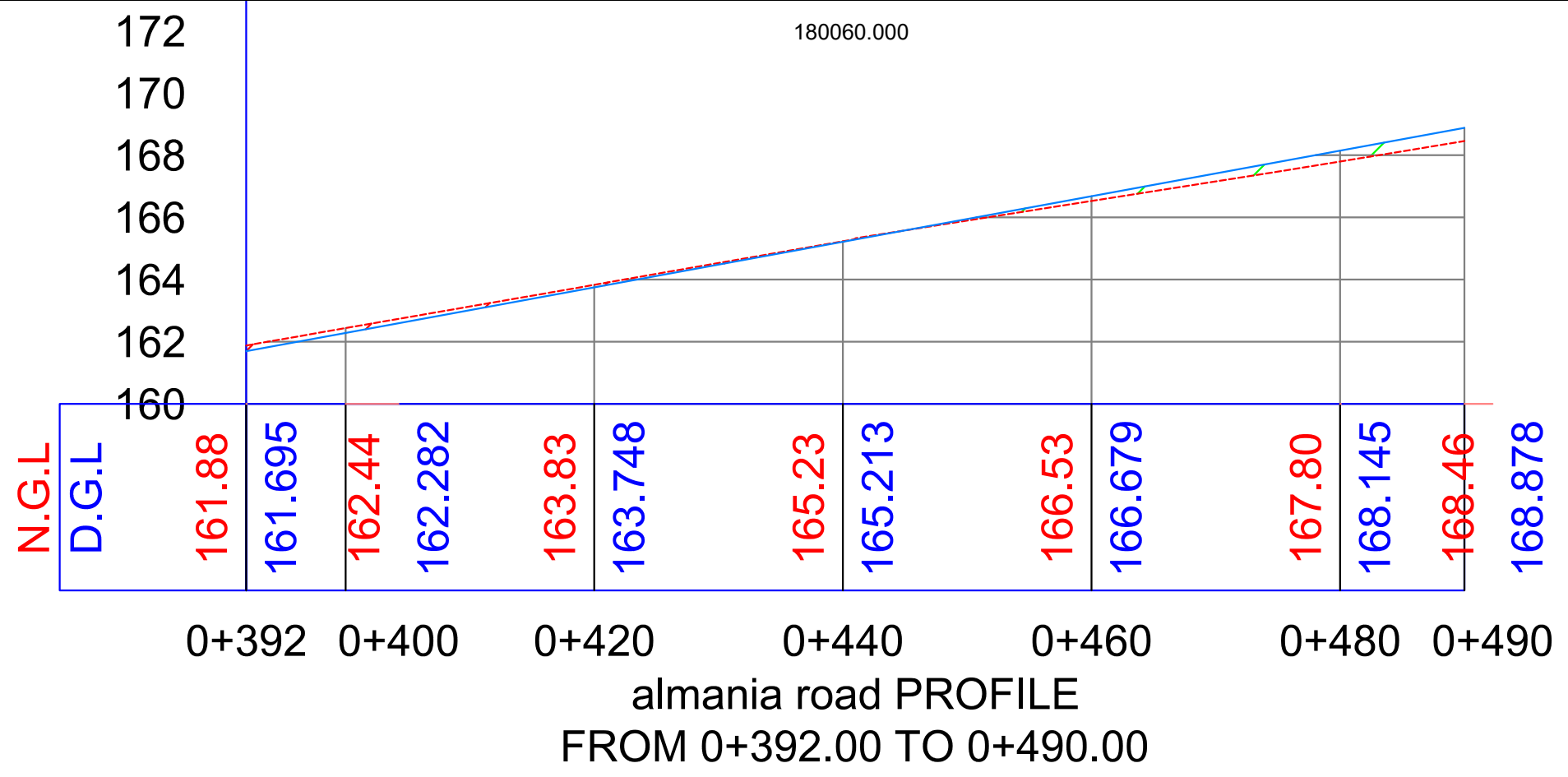
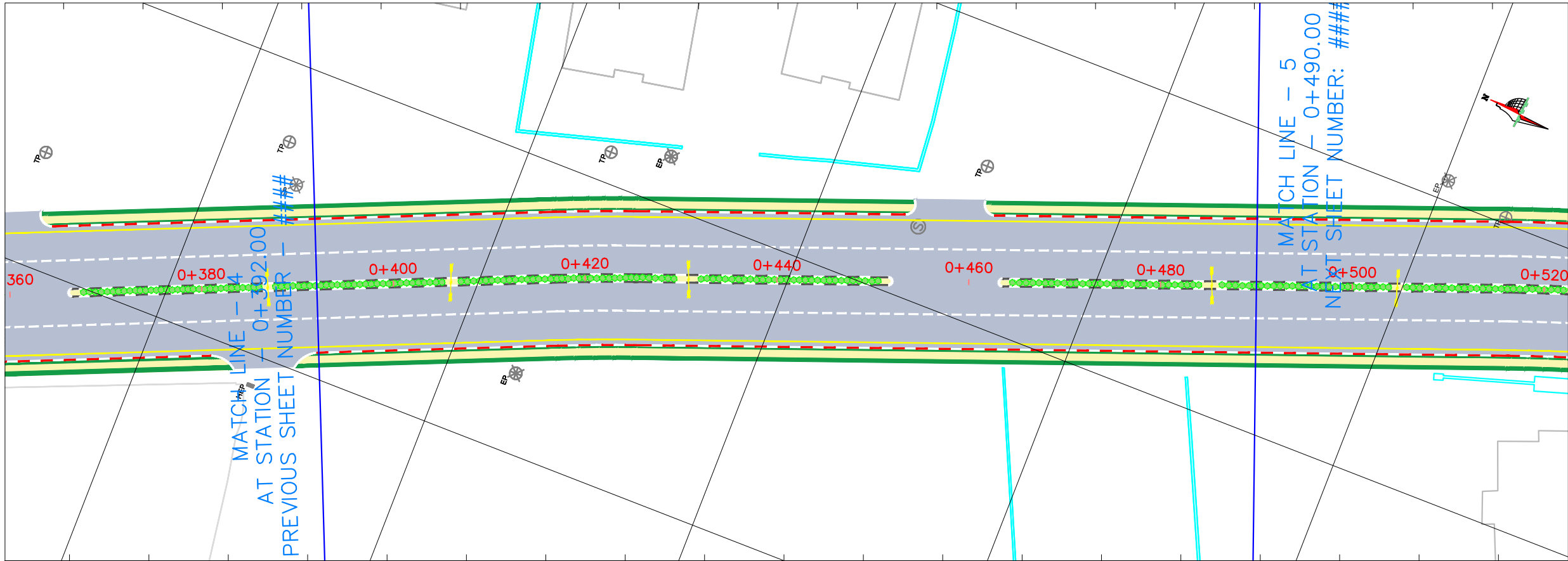

General Notes



PALESTINE POLYTECHNIC UNIVERSITY
college of engineering
Civil Engineering Department
Survey and Geomatics Engineering

LEGAND

- EP Electric power
- TP Telephone Power
- S Sewer Manhole
- ROUNDABOUT SIGN
- 50 SPEED LIMIT SIGN
- FOOT PATH SIGN
- Curbstone
- Asphalt
- Concrete Wall
- Building
- SIDE WALK

No.	Revision/Issue	Date

Supervisor
Eng: Nidal abu rajab

Student Name
MOHAMAD YASIN
OSAID ASHQAR
MAHMOUD ABU SALAH

Project design of Seventy Road	Sheet 5
Date 10/1/2025	
Scale 1 : 500	

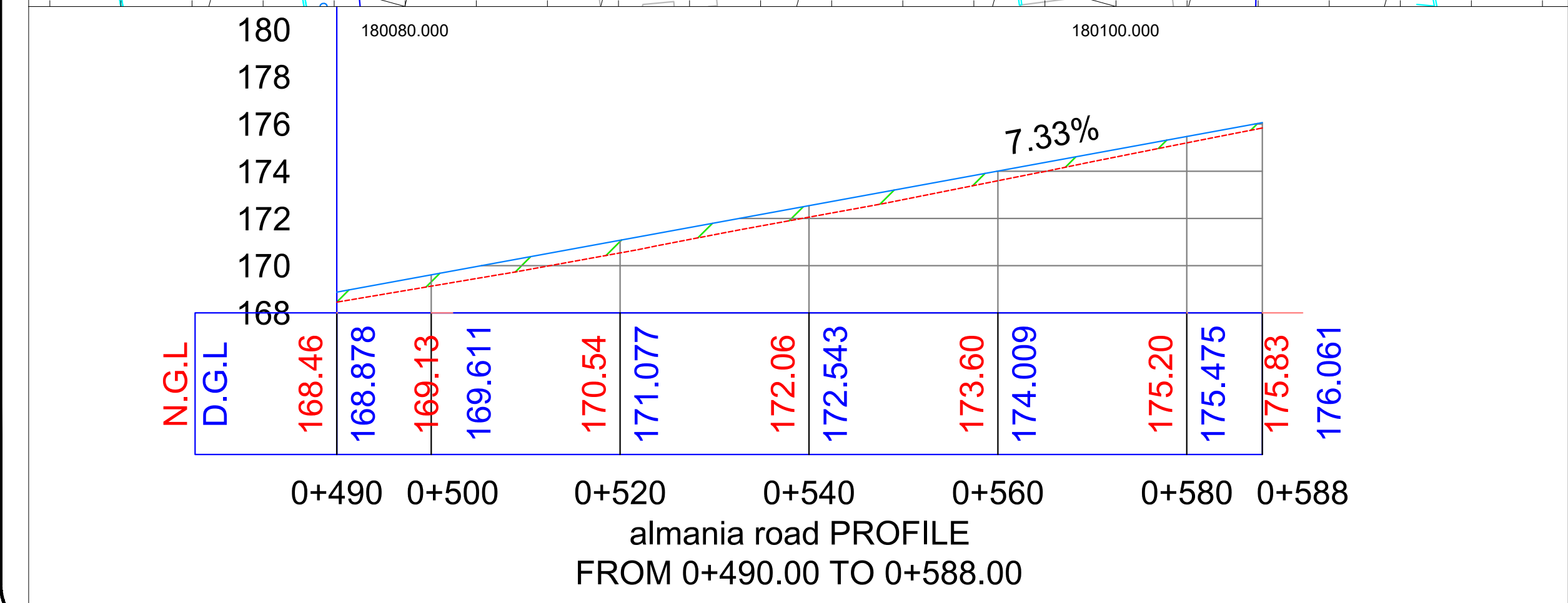
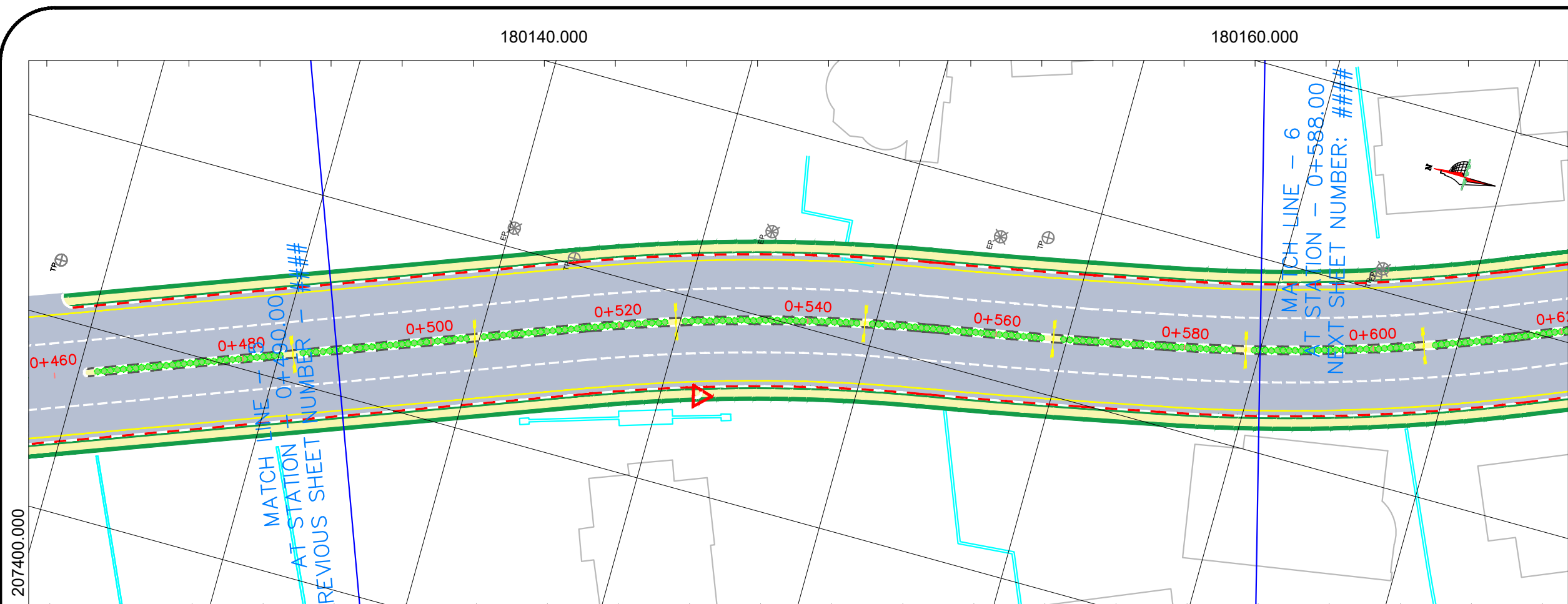

almania road PROFILE
FROM 0+490.00 TO 0+588.00

General Notes



PALESTINE POLYTECHNIC UNIVERSITY
college of engineering
Civil Engineering Department
Survey and Geomatics Engineering

LEGEND

- EP: Electric power
- TP: Telephone Power
- S: Sewer Manhole
- ROUNDABOUT SIGN
- 50: SPEED LIMIT SIGN
- ROAD TURN SIGN
- FOOT PATH SIGN
- : Curbstone
- Asphalt
- Concrete Wall
- Building
- SIDE WALK

No.	Revision/Issue	Date

Supervisor
Eng: Nidal abu rajab

Student Name
MOHAMAD YASIN
OSAID ASHQAR
MAHMOUD ABU SALAH

Project design of Seventy Road	Sheet 6
Date 10/1/2025	
Scale 1 : 500	

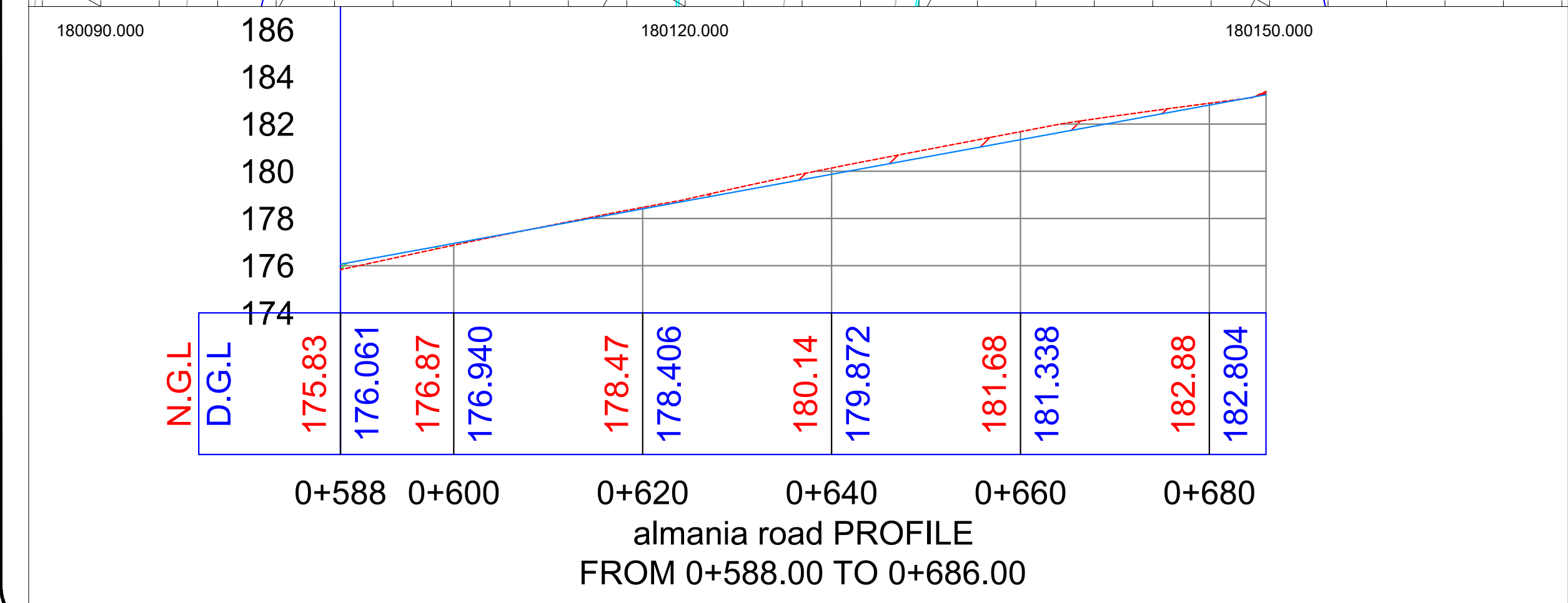
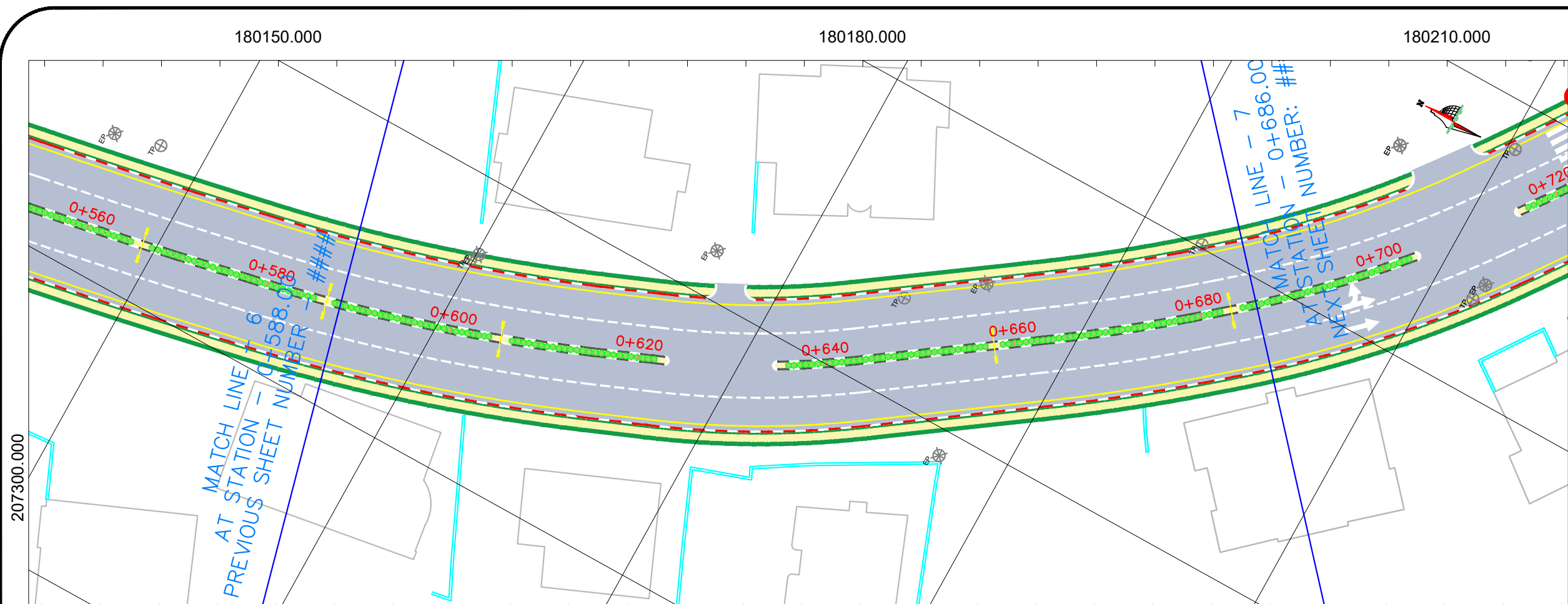

almania road PROFILE
FROM 0+588.00 TO 0+686.00

General Notes



PALESTINE POLYTECHNIC UNIVERSITY
college of engineering
Civil Engineering Department
Survey and Geomatics Engineering

LEGEND

- EP Electric power
- TP Telephone Power
- Sewer Manhole
- ROUNDABOUT SIGN
- SPEED LIMIT SIGN
- ROAD TURN SIGN
- FOOT PATH SIGN
- Curbstone
- Asphalt
- Concrete Wall
- Building
- SIDE WALK

No.	Revision/Issue	Date

Supervisor
Eng: Nidal abu rajab

Student Name
MOHAMAD YASIN
OSAID ASHQAR
MAHMOUD ABU SALAH

Project design of Seventy Road	Sheet 7
Date 10/1/2025	
Scale 1 : 500	

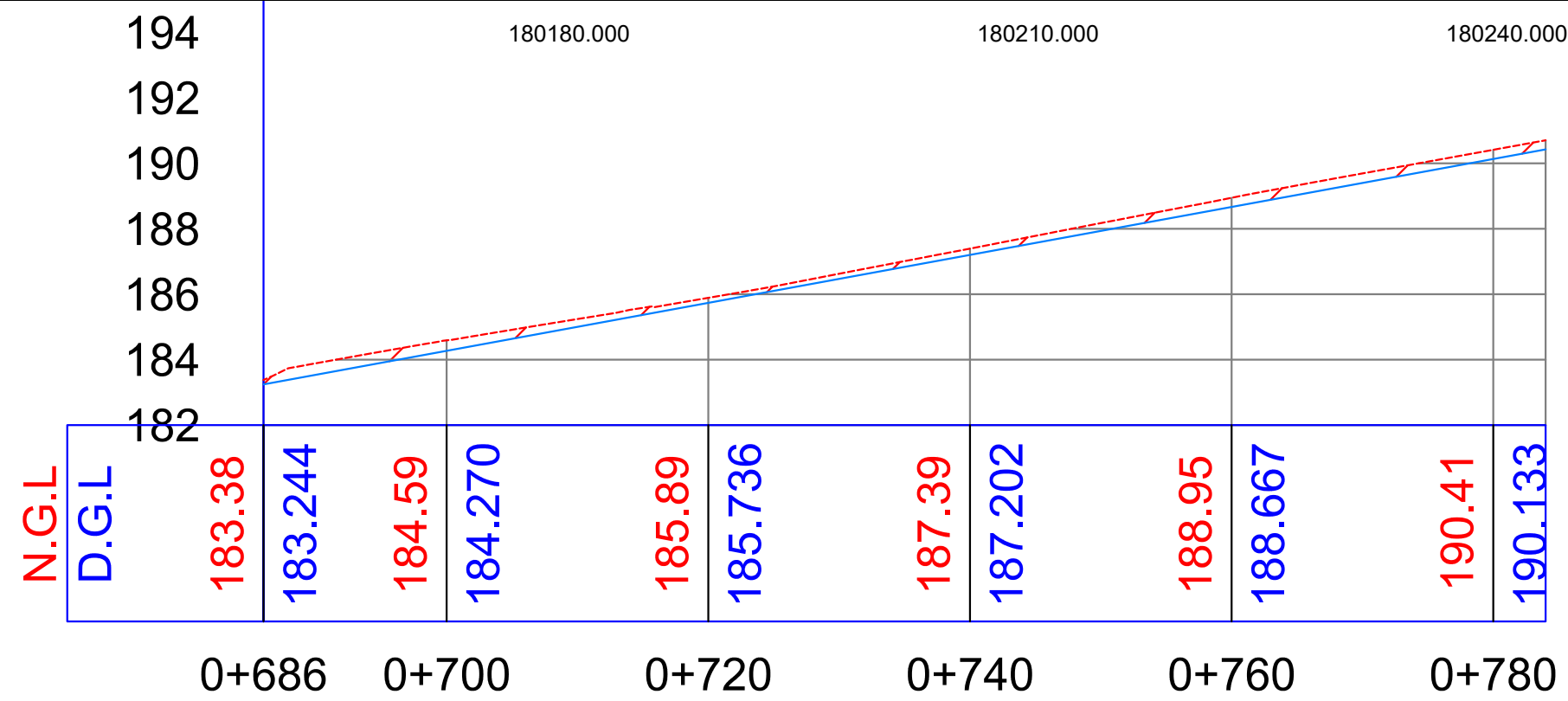
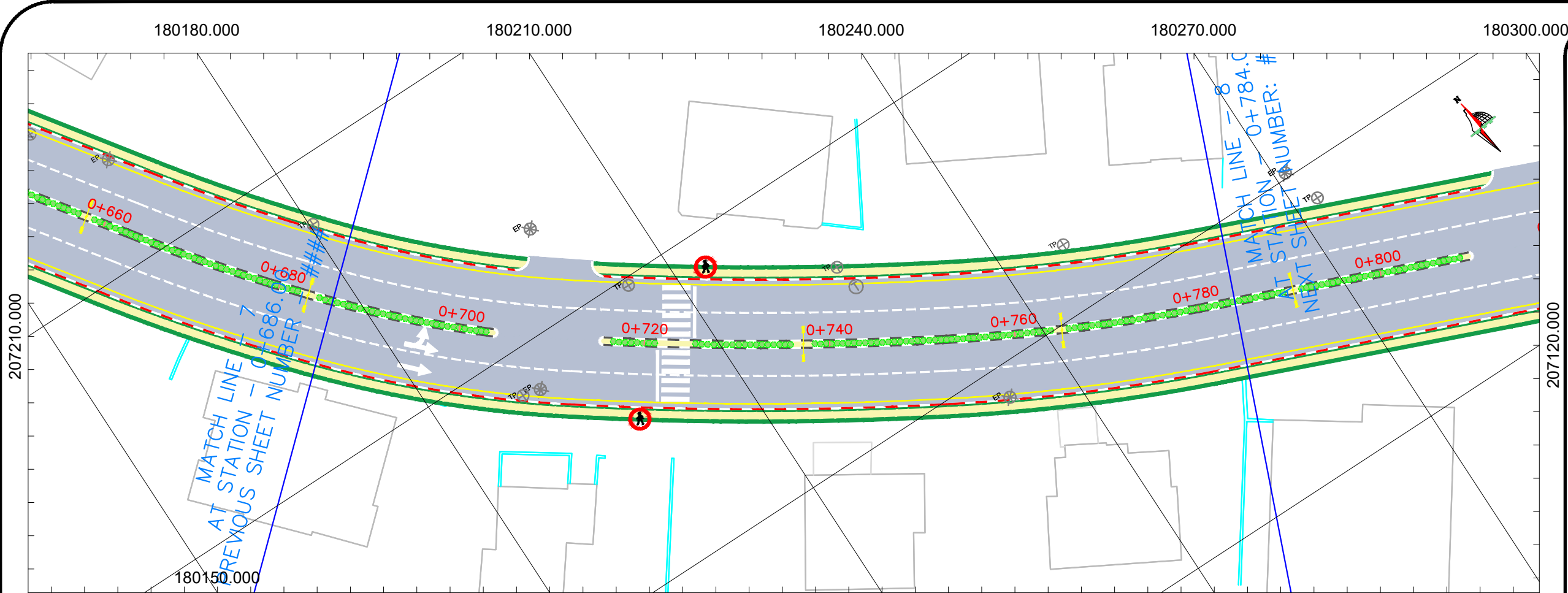

almania road PROFILE
FROM 0+686.00 TO 0+784.00

General Notes



PALESTINE POLYTECHNIC UNIVERSITY
college of engineering
Civil Engineering Department
Survey and Geomatics Engineering

LEGEND

- EP Electric power
- TP Telephone Power
- S Sewer Manhole
- ROUNDABOUT SIGN
- 50 SPEED LIMIT SIGN
- ROAD TURN SIGN
- FOOT PATH SIGN
- Curbstone
- Asphalt
- Concrete Wall
- Building
- SIDE WALK

No.	Revision/Issue	Date

Supervisor
Eng: Nidal abu rajab

Student Name
MOHAMAD YASIN
OSAID ASHQAR
MAHMOUD ABU SALAH

Project design of Seventy Road	Sheet 8
Date 10/1/2025	
Scale 1 : 500	

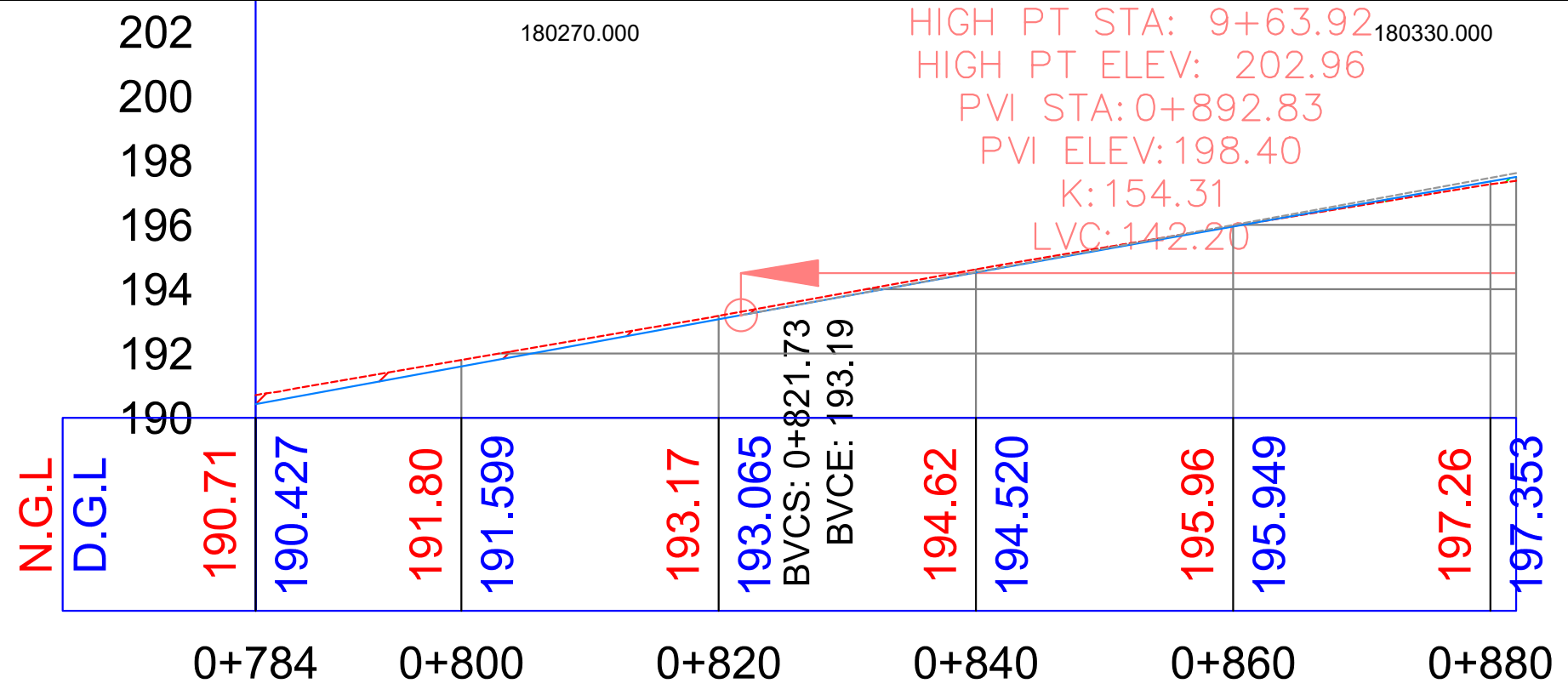
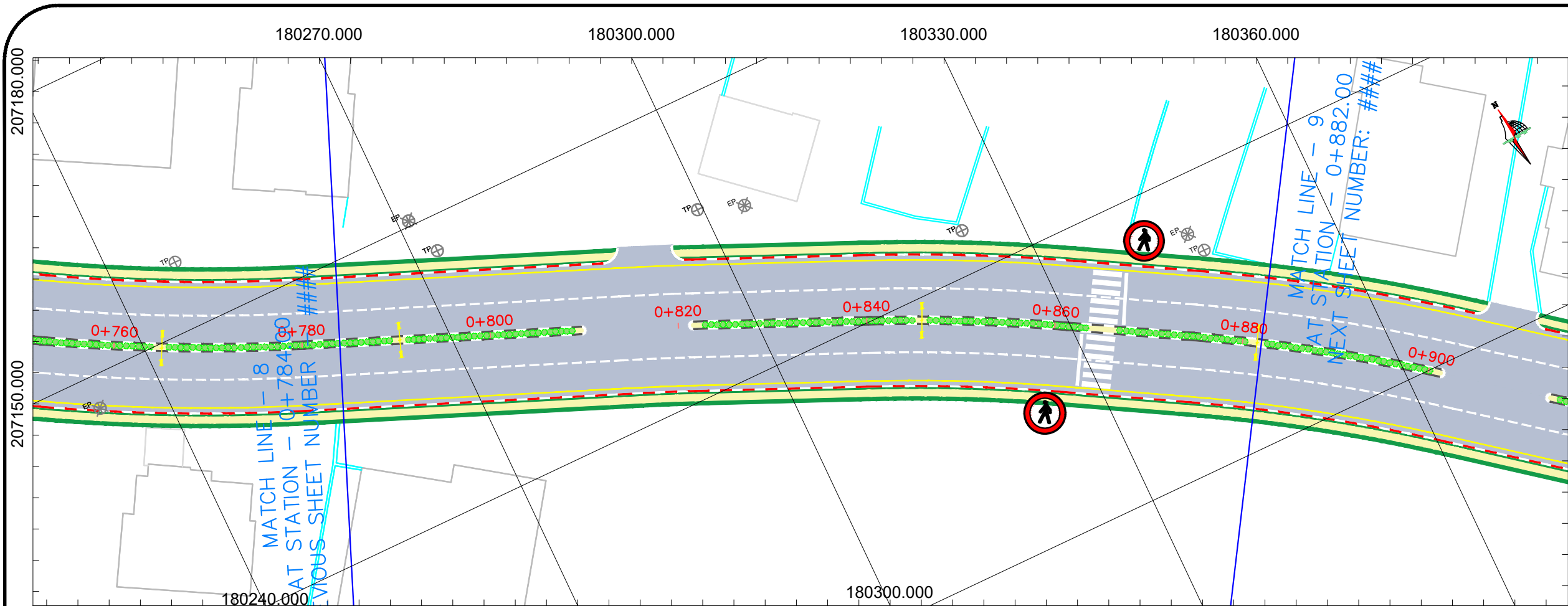

almania road PROFILE
 FROM 0+784.00 TO 0+882.00

General Notes



PALESTINE POLYTECHNIC UNIVERSITY
 college of engineering
 Civil Engineering Department
 Survey and Geomatics Engineering

LEGEND

- EP: Electric power
- TP: Telephone Power
- S: Sewer Manhole
- ROUNDABOUT SIGN
- 50: SPEED LIMIT SIGN
- ROAD TURN SIGN
- FOOT PATH SIGN
- : Curbstone
- : Asphalt
- : Concrete Wall
- : Building
- : SIDE WALK

No.	Revision/Issue	Date

Supervisor

Eng: Nidal abu rajab

Student Name

MOHAMAD YASIN
 OSAID ASHQAR
 MAHMOUD ABU SALAH

Project design of Seventy Road	Sheet 9
Date 10/1/2025	
Scale 1 : 500	

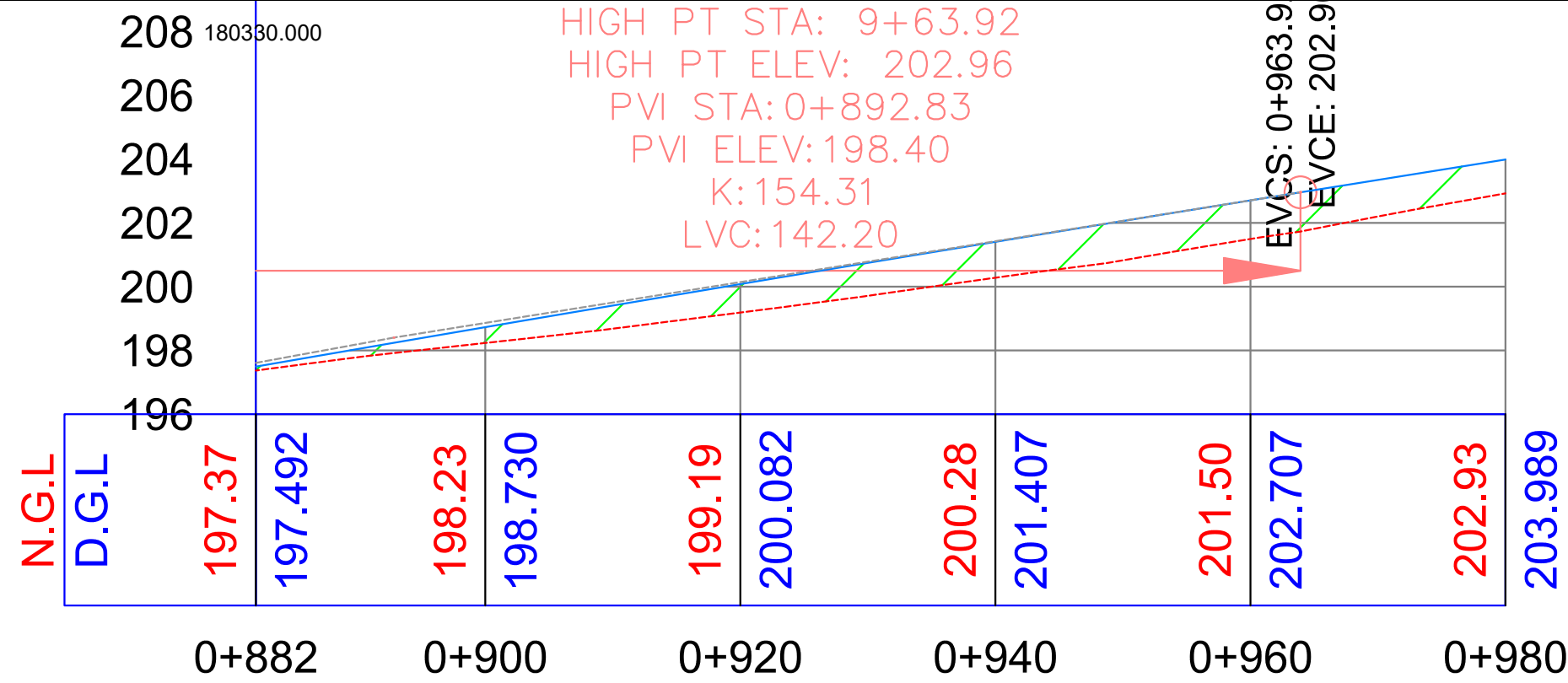
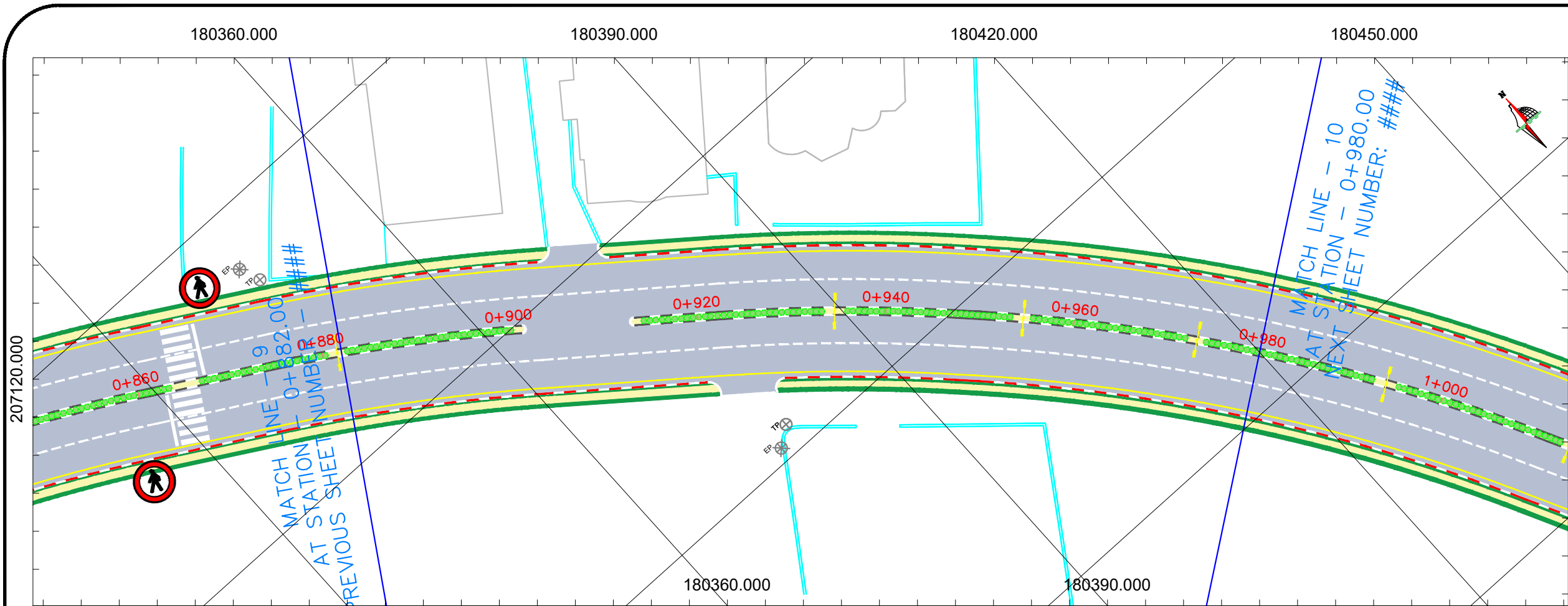

almania road PROFILE
FROM 0+882.00 TO 0+980.00

General Notes



PALESTINE POLYTECHNIC UNIVERSITY
college of engineering
Civil Engineering Department
Survey and Geomatics Engineering

LEGEND

- EP: Electric power
- TP: Telephone Power
- S: Sewer Manhole
- ROUNDABOUT SIGN
- 50: SPEED LIMIT SIGN
- ROAD TURN SIGN
- FOOT PATH SIGN
- : Curbstone
- : Asphalt
- : Concrete Wall
- : Building
- : SIDE WALK

No.	Revision/Issue	Date

Supervisor
Eng: Nidal abu rajab

Student Name
MOHAMAD YASIN
OSAID ASHQAR
MAHMOUD ABU SALAH

Project	Sheet
design of Seventy Road	10
Date	10/1/2025
Scale	1 : 500

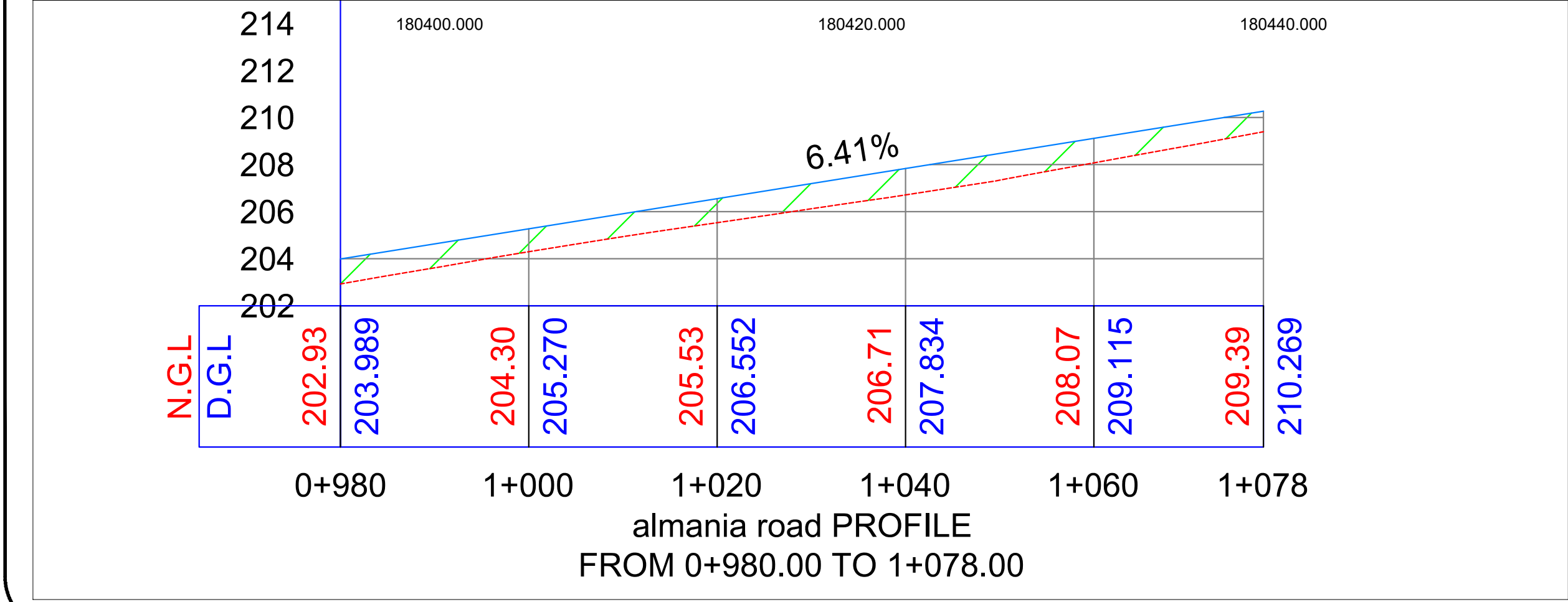
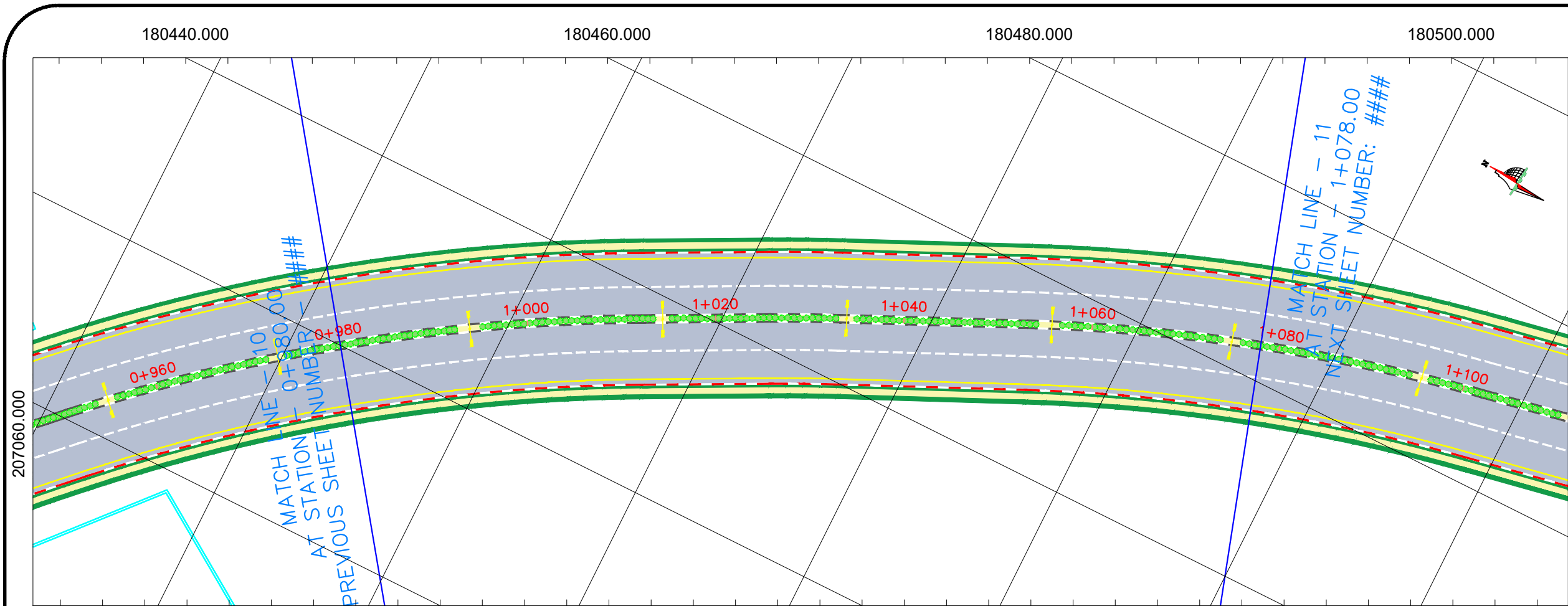

General Notes



PALESTINE POLYTECHNIC UNIVERSITY
college of engineering
Civil Engineering Department
Survey and Geomatics Engineering

LEGEND

- EP Electric power
- TP Telephone Power
- Sewer Manhole
- ROUNDABOUT SIGN
- SPEED LIMIT SIGN
- ROAD TURN SIGN
- FOOT PATH SIGN
- Curbstone
- Asphalt
- Concrete Wall
- Building
- SIDE WALK

No.	Revision/Issue	Date

Supervisor
Eng: Nidal abu rajab

Student Name
MOHAMAD YASIN
OSAID ASHQAR
MAHMOUD ABU SALAH

Project design of Saventy Road	Sheet 11
Date 10/1/2025	
Scale 1 : 500	

180510.000

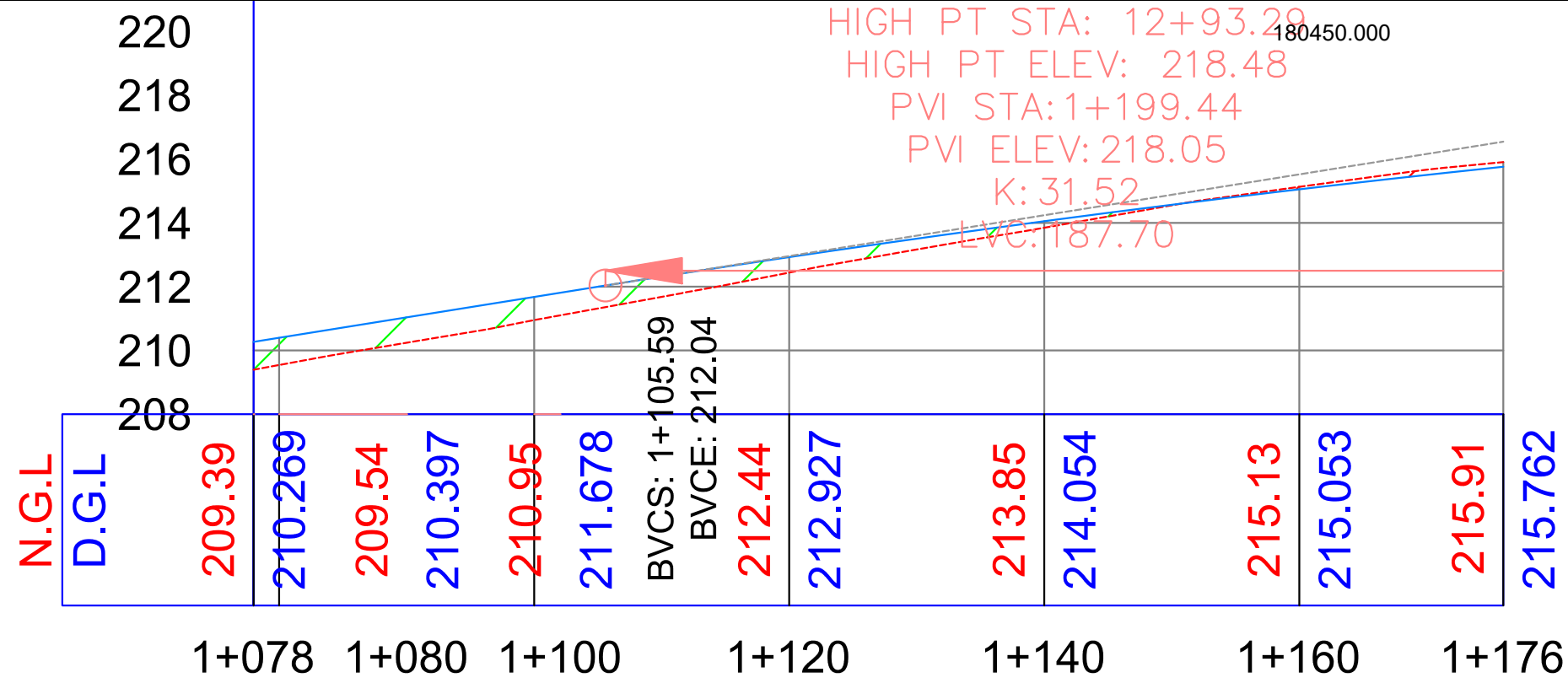
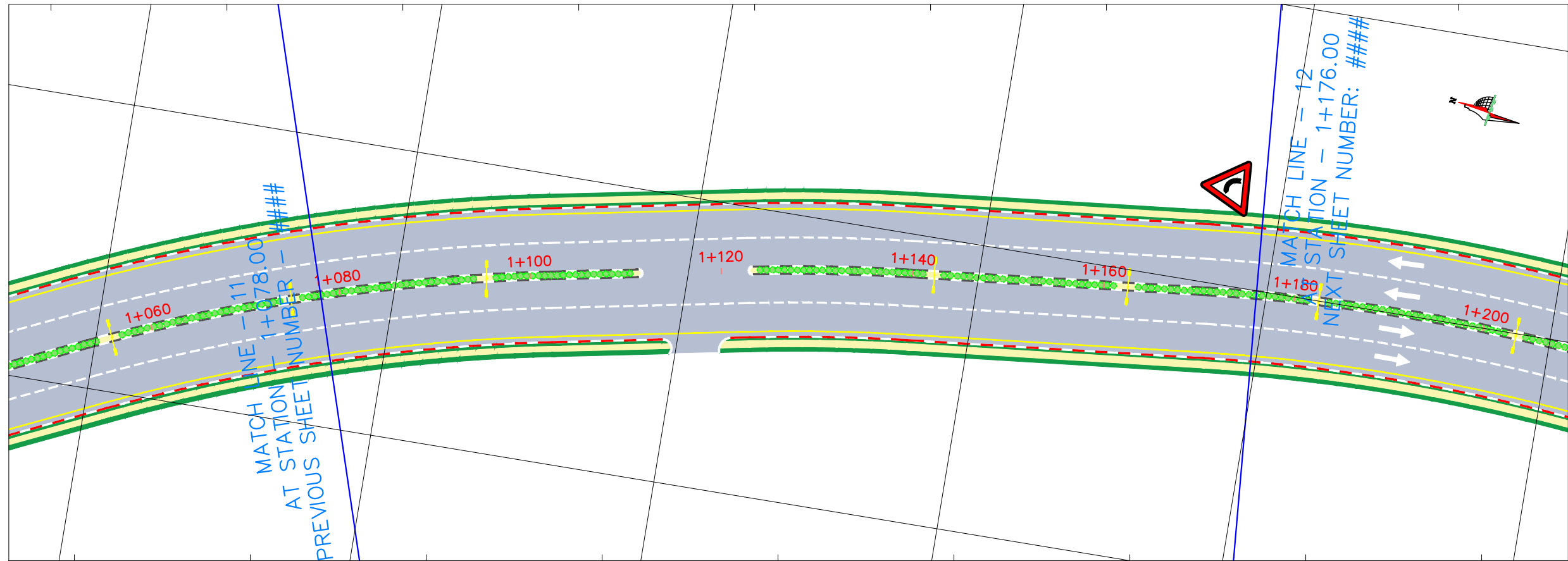

almania road PROFILE
FROM 1+078.00 TO 1+176.00

General Notes



PALESTINE POLYTECHNIC UNIVERSITY
college of engineering
Civil Engineering Department
Survey and Geomatics Engineering

LEGEND

- EP: Electric power
- TP: Telephone Power
- S: Sewer Manhole
- ROUNDABOUT SIGN
- 50: SPEED LIMIT SIGN
- ROAD TURN SIGN
- FOOT PATH SIGN
- : Curbstone
- : Asphalt
- : Concrete Wall
- : Building
- ▨: SIDE WALK

No.	Revision/Issue	Date

Supervisor

Eng: Nidal abu rajab

Student Name

MOHAMAD YASIN
OSAID ASHQAR
MAHMOUD ABU SALAH

Project design of Seventy Road	Sheet 12
Date 10/1/2025	
Scale 1 : 500	

180500.000

180520.000

206880.000

206720.000

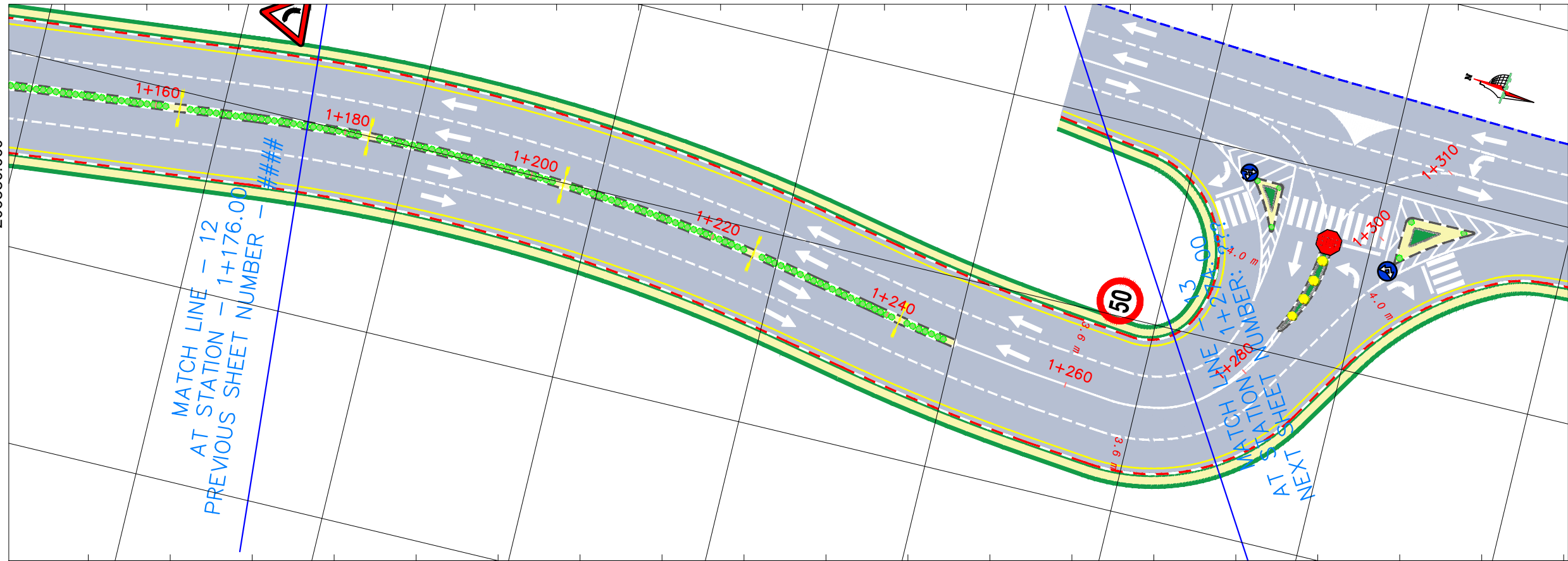

226 180440.000 HIGH PT STA: 12+93.29 180460.000
 224 HIGH PT ELEV: 218.48
 222 PVI STA: 1+199.44
 220 PVI ELEV: 218.05
 218 K: 31.52
 216 LVC: 187.70
 214

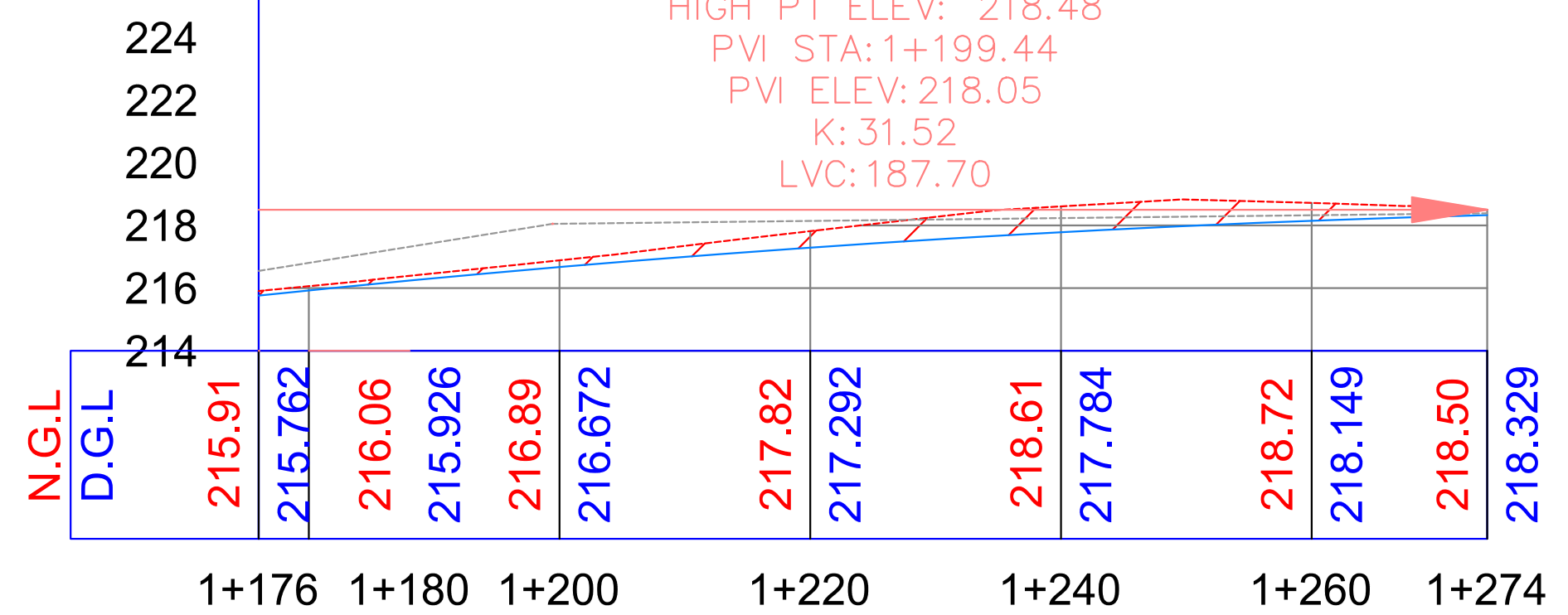

almania road PROFILE
 FROM 1+176.00 TO 1+274.00

General Notes



PALESTINE POLYTECHNIC UNIVERSITY
 college of engineering
 Civil Engineering Department
 Survey and Geomatics Engineering

LEGEND

- EP Electric power
- TP Telephone Power
- S Sewer Manhole
- ROUNDABOUT SIGN
- 50 SPEED LIMIT SIGN
- ROAD TURN SIGN
- FOOT PATH SIGN
- Curbstone
- Asphalt
- Concrete Wall
- Building
- SIDE WALK

No.	Revision/Issue	Date

Supervisor
 Eng: Nidal abu rajab

Student Name
 MOHAMAD YASIN
 OSAID ASHQAR
 MAHMOUD ABU SALAH

Project design of Seventy Road	Sheet 13
Date 10/1/2025	
Scale 1 : 500	