

- NOTES**
1. ALL DIMENSIONS ARE IN METERS, UNLESS OTHERWISE NOTED.
 2. FOR COORDINATING SYSTEM USE (UTM 'AIN ALABD-ZONE 38')
 3. DRAWINGS SHALL NOT BE SCALED. ONLY WRITTEN DIMENSION SHALL BE FOLLOWED.
 4. THIS DRAWING SHOULD BE READ AT SITE ATTACH WITH E/M MAP DRAWINGS
 5. ALL CO-ORDINATES AROUND THE BUILDINGS AND ENTRANCES ONE CO-ORDINATED WITH THE APPROVED ARCHITECTURAL DWG FOR MORE INFO REFER TO ARCHITECTUAL PACKAGE FOR ALL BUILDINGS
 6. ALL CO-ORDINATES AROUND THE BUILDINGS AND ENTRANCES ONE CO-ORDINATED WITH THE APPROVED STRUCTURAL DWG FOR MORE INFO REFER TO STRUCTURAL PACKAGE FOR ALL BUILDINGS
 7. FOR FURTHER INFORMATION ABOUT STORM DRAINAGE CORRIDORS, PLEASE REFER TO STORM PACKAGE.
 8. REGARDING ROAD CURB LEVELS (BOTTOM OF CURBS) AND ASPHALT LEVELS REFER TO ROAD PACKAGE FOR COORDINATION.
 9. REGARDING THE MEP DETAILS REFER TO MEP PACKAGE FOR COORDINATION.
 10. ALL PAVEMENT SIDEWALK ATTACHED OR ALIGN ROAD CURBS SHALL BE SLOPED WITH ROADS SLOPES DIRECTION
 11. THE UNDERGROUND UTILITIES SHALL BE COORDINATED ACCORDINGLY WITH APPROVED DWG. FROM RELATED DISCIPLINES UNTIL IT WILL BE FINISHED.
 12. FENCE FROM PROTOTYPE SHALL BE OMITTED ACCORDING TO LETTER (KAP4-PRG-AC-123-01485) FOR DESIGN APPROVAL(KAP4-RIT-123-SITE-CI-0000-1) SHALL BE FOLLOWED AS SHOWN ON DRAWINGS.
 13. FOR STORM WATER CALCULATIONS AND INFO REGARDING PROPOSED CORRIDORS REFER TO STORM WATER REPORT, NO. KAP4-REP-DD-123-SITE-PL-9200
 14. FOR MORE DATA CONCERNING BENCH MARKS NO=D1 REFER TO SURVEY DRAWINGS

LEGEND

EDGE OF ASPHALT	—
RAISED KERB	—
EXISTING BUILDING	[Hatched Box]
EXISTING FOOTPATH	[Hatched Box]
SECONDARY SIDEWALK HATCH	[Wavy Hatch]
FENCE LINE	—
SHADE TREE	○
GATE	∞
SPOT LEVEL	580.080
TRAVERSE POINTS	TP
ELECTRICAL SUBSTATION / BOX	⊠
FIRE HYDRANT	↑
STREET LIGHTING POLE	☀
UTILITY MANHOLE	MH
TELECOMMUNICATION MANHOLE	TMH
SANITARY MANHOLE	SMH
STORM WATER MANHOLE	SMH
WATER VALVE	⊕

SCALE BAR

COORDINATION

CLIENT:	Hgrh,G
CLIENT CONSULTANT:	Hgrh,G
CONTRACTOR:	Hgrh,G
CONTRACTOR CONSULTANT:	Hgrh,G
PROJECT NAME:	Hsl, hgrh,G

TITLE

NO.	1
DATE	2021-9-5
SCALE	1:500
PROJECT NAME	MHP-DD-RF
DWG. NO.	000000

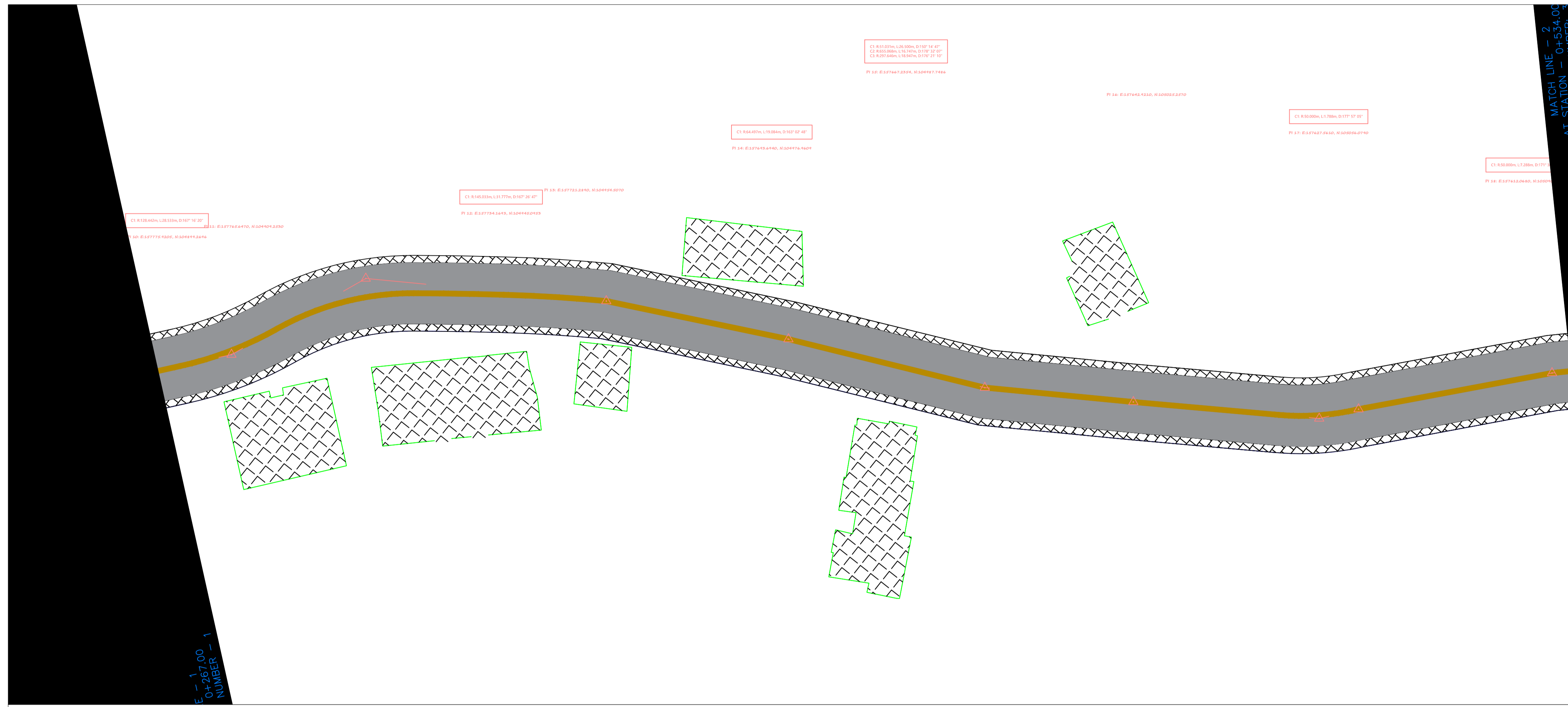

MATCH LINE - 2
AT STATION - 0+534.00
NEXT SHEET NUMBER: 3

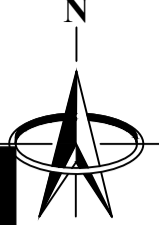
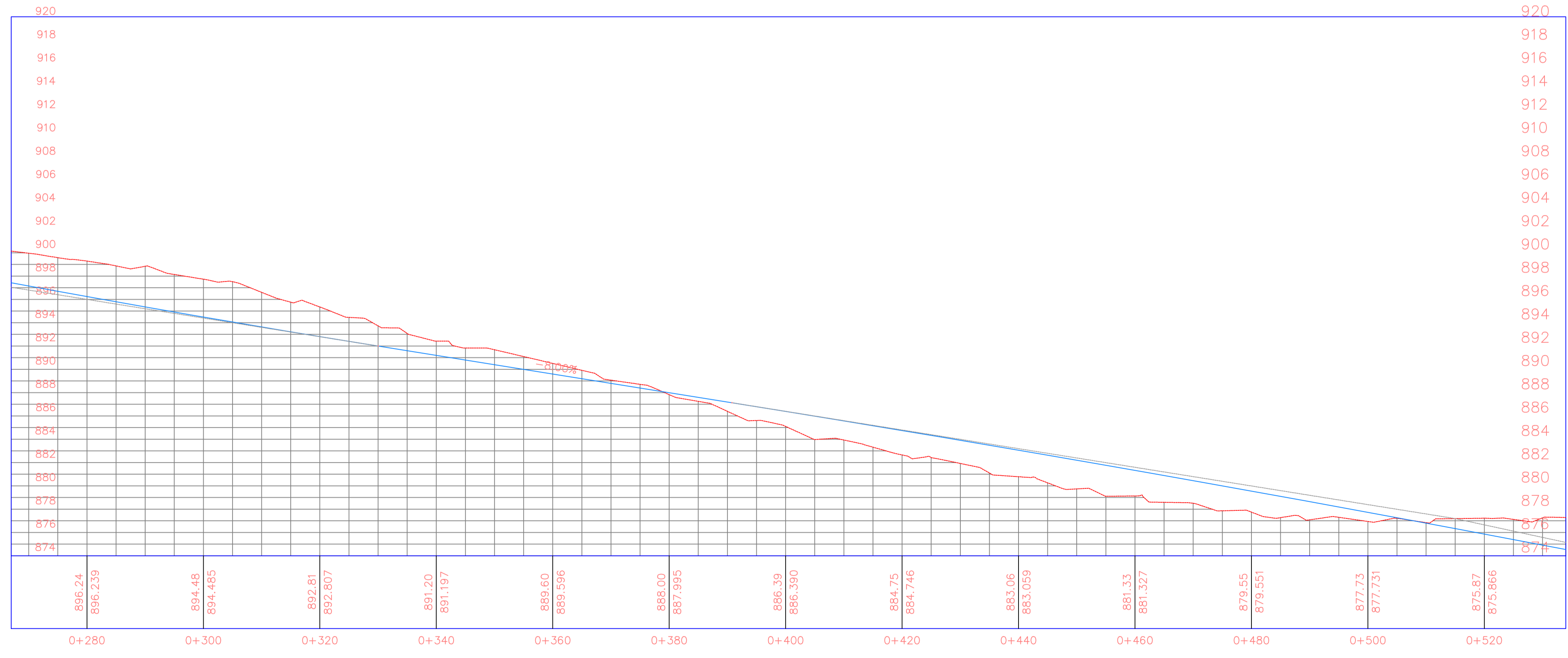

- NOTES**
1. ALL DIMENSIONS ARE IN METERS, UNLESS OTHERWISE NOTED.
 2. FOR COORDINATING SYSTEM USE (UTM 'AIN ALABD-ZONE 38'
 3. DRAWINGS SHALL NOT BE SCALED. ONLY WRITTEN DIMENSION SHALL BE FOLLOWED.
 4. THIS DRAWING SHOULD BE READ AT SITE ATTACH WITH EIM MAP DRAWINGS.
 5. ALL CO-ORDINATES AROUND THE BUILDINGS AND ENTRENCES ONE CO-ORINATED WITH THE APPROVED ARCHITECTUAL DWG FOR MORE INFO REFER TO ARCHITECTURAL PACKAGE. FOR ALL BUILDINGS
 6. ALL CO-ORDINATES AROUND THE BUILDINGS AND ENTRENCES ONE CO-ORINATED WITH THE APPROVED STRUCTURAL DWG FOR MORE INFO REFER TO STRUCTURAL PACKAGE. FOR ALL BUILDINGS
 7. FOR FURTHER INFORMATION ABOUT STORM DRAINAGE CORRIDORS, PLEASE REFER TO STORM PACKAGE.
 8. REGARDING ROAD CURB LEVELS (BOTTOM OF CURBS) AND ASPHALT LEVELS REFER TO ROAD PACKAGE FOR COORDINATION.
 9. REGARDING THE MEP DETAILS REFER TO MEP PACKAGE FOR COORDINATION.
 10. ALL PAVEMENT SIDEWALK ATTACHED OR ALIGN ROAD CURBS SHALL BE SLOPED WITH ROADS SLOPES DIRECTION
 11. THE UNDERGROUND UTILITIES SHALL BE COORDINATED ACCORDINGLY WITH APPROVED DWG. FROM RELATED DISCIPLINES UNTIL IT WILL BE FINISHED.
 12. FENCE FROM PROTOTYPE SHALL BE OMITTED ACCORDING TO LETTER (KAP4-PRG-AC-123-01485) FOR DESIGN APPROVAL(KAP4-RIT-123-SITE-CI-0000-1) SHALL BE FOLLOWED AS SHOWN ON DRAWINGS.
 13. FOR STORM WATER CALCULATIONS AND INFO REGARDING PROPOSED CORRIDORS REFER TO STORM WATER REPORT, NO. KAP4-REP-DD-123-SITE-PL-9200
 14. FOR MORE DATA CONCERNING BENCH MARKS NO=D1 REFER TO SURVEY DRAWINGS

LEGEND

EDGE OF ASPHALT	
RAISED KERB	
EXISTING BUILDING	
EXISTING FOOTPATH	
SECONDARY SIDEWALK HATCH	
FENCE LINE	
SHADE TREE	
GATE	
SPOT LEVEL	580.080
TRAVERSE POINTS	
ELECTRICAL SUBSTATION / BOX	
FIRE HYDRANT	
STREET LIGHTING POLE	
UTILITY MANHOLE	
TELECOMMUNICATION MANHOLE	
SANITARY MANHOLE	
STORM WATER MANHOLE	
WATER VALVE	

SCALE BAR

COORDINATION

CLIENT:	Hg/Hg
CLIENT CONSULTANT:	hBsjohvD
CONTRACTOR:	Hg/Hg_G
CONTRACTOR CONSULTANT:	hBsjohvD Hg/Hg_G
PROJECT NAME:	HsL hg/HgV

TITLE

NO.	DATE	DESCRIPTION	BY	CHECKED BY	APPROVED BY
1		DESIGN DRAWING FOR APPROVAL	09/09/2007	A.SABER	S.A.MERD

SCALE 1:500 **PROJECT NAME** MHP-DD-RF

DATE 2021-9-5 **DWG NO.** 000000



- NOTES**
1. ALL DIMENSIONS ARE IN METERS, UNLESS OTHERWISE NOTED.
 2. FOR COORDINATING SYSTEM USE (UTM 'AIN ALABD-ZONE 38'
 3. DRAWINGS SHALL NOT BE SCALED. ONLY WRITTEN DIMENSION SHALL BE FOLLOWED.
 4. THIS DRAWING SHOULD BE READ AT SITE ATTACH WITH E/M MAP DRAWINGS.
 5. ALL CO-ORDINATES AROUND THE BUILDINGS AND ENTRANCES ONE CO-ORINATED WITH THE APPROVED ARCHITECTUAL DWG FOR MORE INFO REFER TO ARCHITECTUAL PACKAGE FOR ALL BUILDINGS
 6. ALL CO-ORDINATES AROUND THE BUILDINGS AND ENTRANCES ONE CO-ORINATED WITH THE APPROVED STRUCTURAL DWG FOR MORE INFO REFER TO STRUCTURAL PACKAGE FOR ALL BUILDINGS
 7. FOR FURTHER INFORMATION ABOUT STORM DRAINAGE CORRIDORS, PLEASE REFER TO STORM PACKAGE.
 8. REGARDING ROAD CURB LEVELS (BOTTOM OF CURBS) AND ASPHALT LEVELS REFER TO ROAD PACKAGE FOR COORDINATION.
 9. REGARDING THE MEP DETAILS REFER TO MEP PACKAGE FOR COORDINATION.
 10. ALL PAVEMENT SIDEWALK ATTACHED OR ALIGN ROAD CURBS SHALL BE SLOPED WITH ROAD'S SLOPES DIRECTION.
 11. THE UNDERGROUND UTILITIES SHALL BE COORDINATED ACCORDINGLY WITH APPROVED DWG. FROM RELATED DISCIPLINES UNTIL IT WILL BE FINISHED.
 12. FENCE FROM PROTOTYPE SHALL BE OMITTED ACCORDING TO LETTER (KAP4-PRG-ACC-123-01485) FOR DESIGN APPROVAL(KAP4-RIT-123-SITE-CI-0000-1) SHALL BE FOLLOWED AS SHOWN ON DRAWINGS.
 13. FOR STORM WATER CALCULATIONS AND INFO REGARDING PROPOSED CORRIDORS REFER TO STORM WATER REPORT, NO. KAP4-REP-DD-123-SITE-PL-9200
 14. FOR MORE DATA CONCERNING BENCH MARKS NO=D1 REFER TO SURVEY DRAWINGS

LEGAND

EDGE OF ASPHALT	
RAISED KERB	
EXISTING BUILDING	
EXISTING FOOTPATH	
SECONDARY SIDEWALK HATCH	
FENCE LINE	
SHADE TREE	
GATE	
SPOT LEVEL	580.080
TRAVERSE POINTS	
ELECTRICAL SUBSTATION / BOX	
FIRE HYDRANT	
STREET LIGHTING POLE	
UTILITY MANHOLE	
TELECOMMUNICATION MANHOLE	
SANITARY MANHOLE	
STORM WATER MANHOLE	
WATER VALVE	

SCALE BAR

COORDINATION

CLIENT	Hghig.
CLIENT CONSULTANT	Hghig.
CONTRACTOR	Hghig.
CONTRACTOR CONSULTANT	Hghig.
PROJECT NAME	Hghig.

TITLE

1			
2			
3			
4			

REVISIONS

NO	DESCRIPTION	DATE	DRAWN BY	CHECKED BY	APPROVED BY
0	DESIGN DRAWINGS FOR APPROVAL	0000000	A-SABER	S-AMROD	S-SABER

SCALE 1:500 **PROJECT NAME** MHP-DD-RF

DATE 2021-9-5 **DWG NO.** 000000

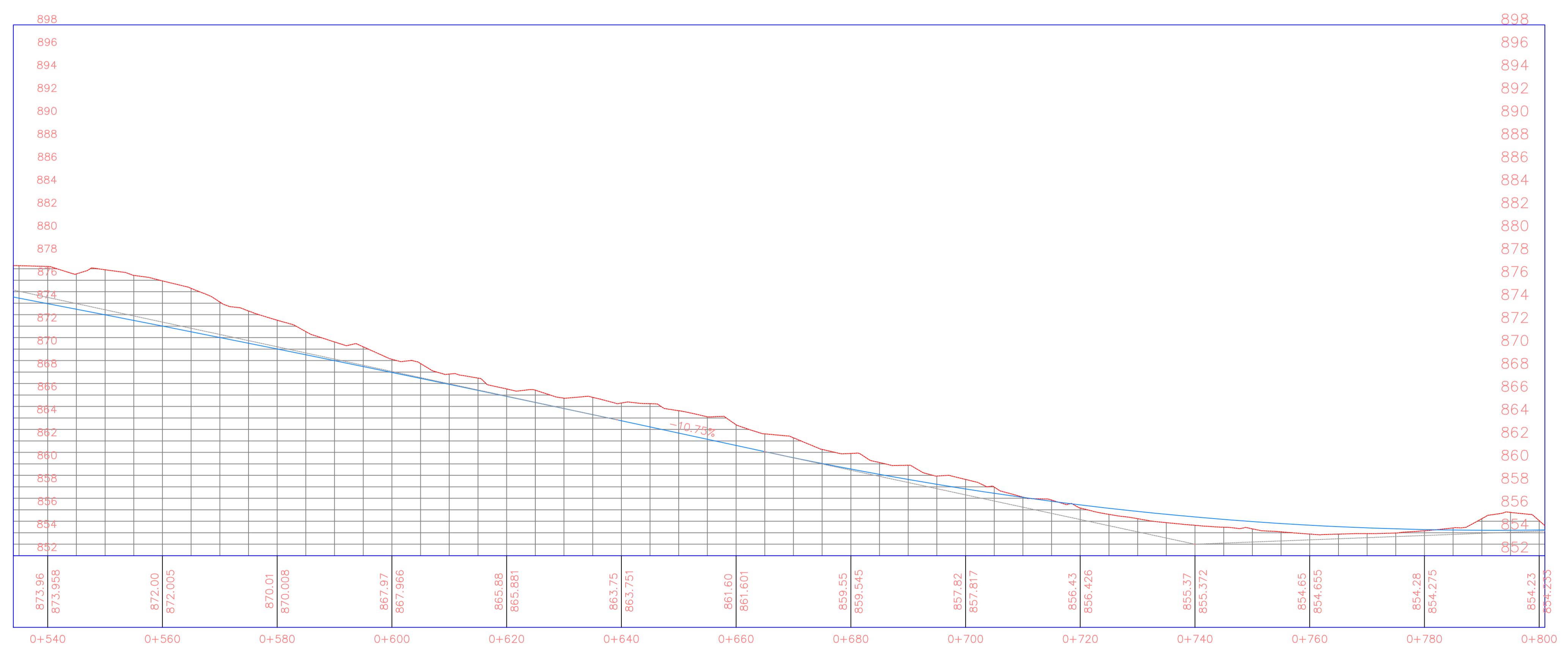
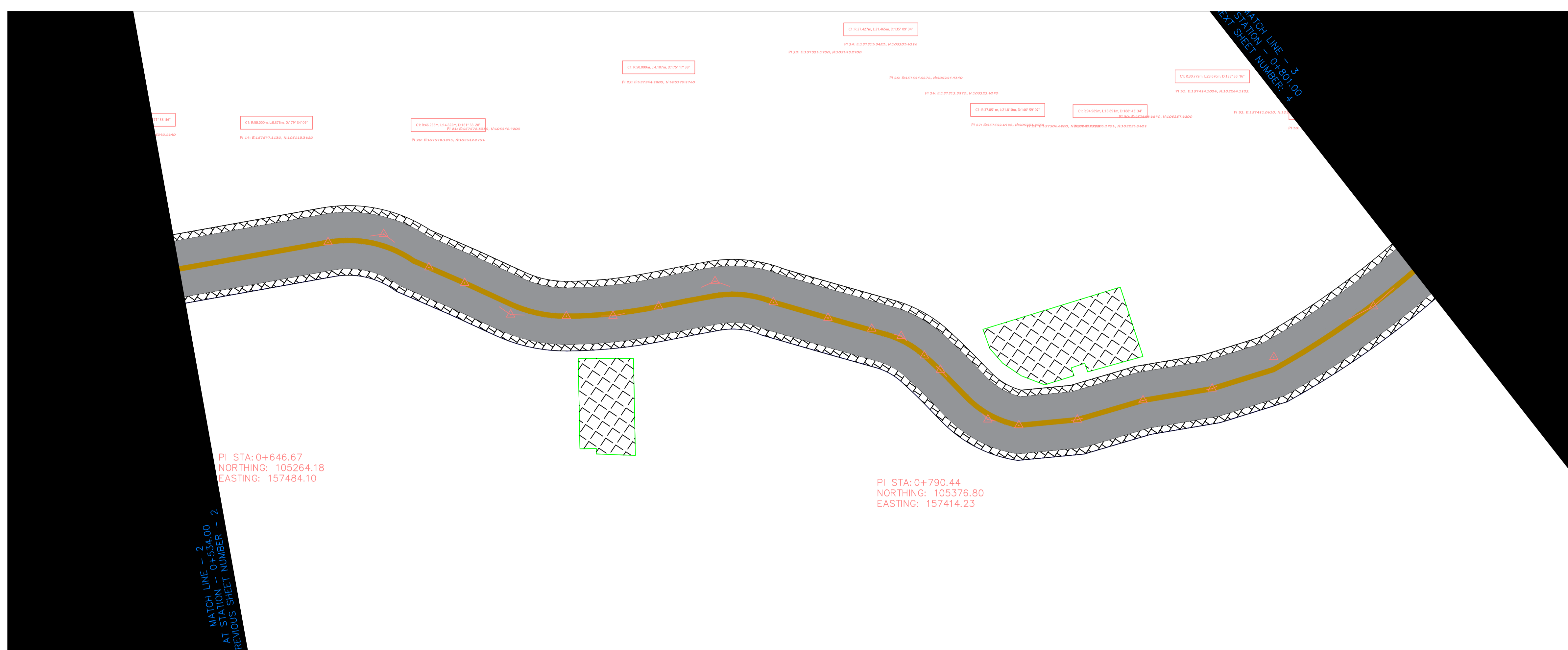

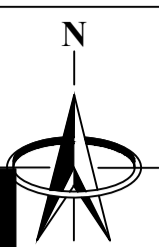
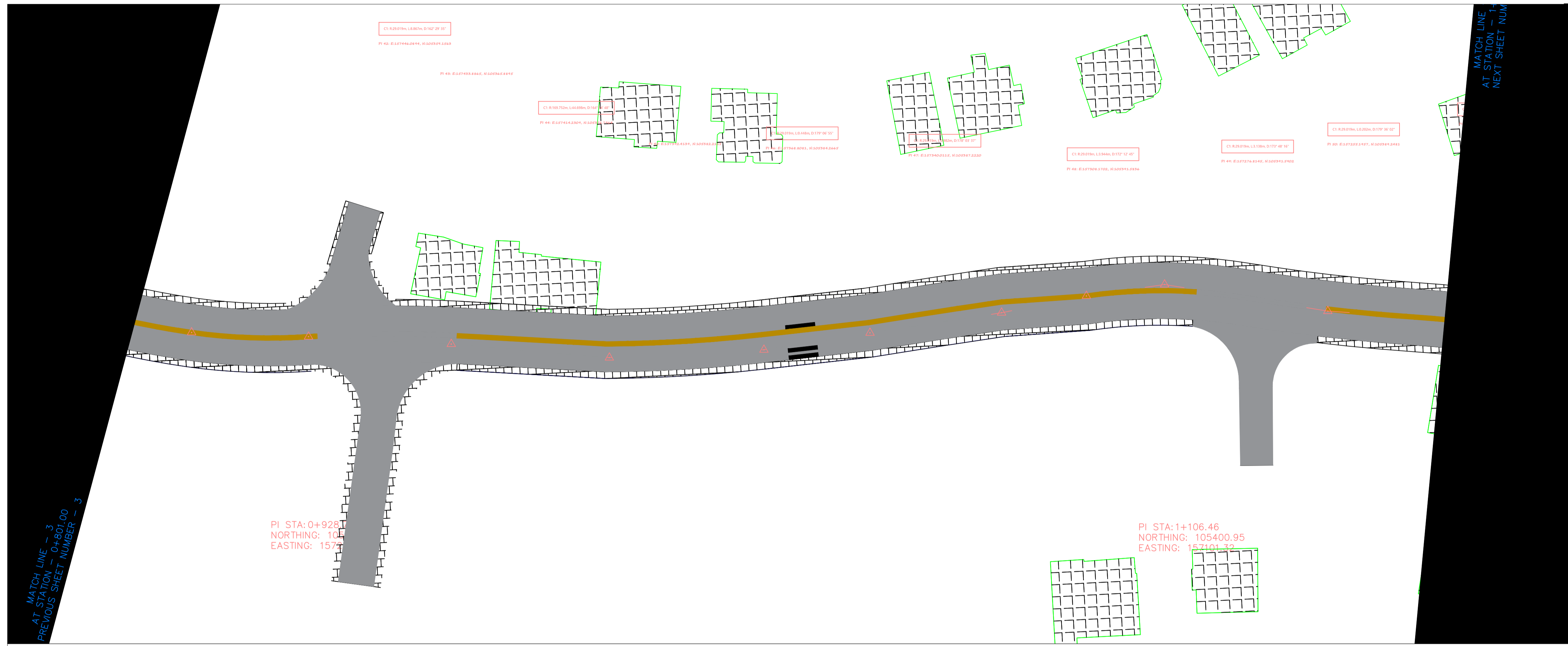

- NOTES**
1. ALL DIMENSIONS ARE IN METERS, UNLESS OTHERWISE NOTED.
 2. FOR COORDINATING SYSTEM USE (UTM) 'AIN ALABD-ZONE 38'
 3. DRAWINGS SHALL NOT BE SCALED. ONLY WRITTEN DIMENSION SHALL BE FOLLOWED.
 4. THIS DRAWING SHOULD BE READ AT SITE ATTACH WITH E/M MAP DRAWINGS.
 5. ALL CO-ORDINATES AROUND THE BUILDINGS AND ENTRANCES ONE CO-ORINATED WITH THE APPROVED ARCHITECTURAL DWG FOR MORE INFO REFER TO ARCHITECTURAL PACKAGE FOR ALL BUILDINGS
 6. ALL CO-ORDINATES AROUND THE BUILDINGS AND ENTRANCES ONE CO-ORINATED WITH THE APPROVED STRUCTURAL DWG FOR MORE INFO REFER TO STRUCTURAL PACKAGE FOR ALL BUILDINGS
 7. FOR FURTHER INFORMATION ABOUT STORM DRAINAGE CORRIDORS, PLEASE REFER TO STORM PACKAGE.
 8. REGARDING ROAD CURB LEVELS (BOTTOM OF CURBS) AND ASPHALT LEVELS REFER TO ROAD PACKAGE FOR COORDINATION.
 9. REGARDING THE MEP DETAILS REFER TO MEP PACKAGE FOR COORDINATION.
 10. ALL PAVEMENT SIDEWALK ATTACHED OR ALIGN ROAD CURBS SHALL BE SLOPED WITH ROAD'S SLOPES DIRECTION.
 11. THE UNDERGROUND UTILITIES SHALL BE COORDINATED ACCORDINGLY WITH APPROVED DWG. FROM RELATED DISCIPLINES UNTIL IT WILL BE FINISHED.
 12. FENCE FROM PROTOTYPE SHALL BE OMITTED ACCORDING TO LETTER (KAP4-PRG-ACC-123-01485) FOR DESIGN APPROVAL(KAP4-RIT-123-SITE-CI-0000-1) SHALL BE FOLLOWED AS SHOWN ON DRAWINGS.
 13. FOR STORM WATER CALCULATIONS AND INFO REGARDING PROPOSED CORRIDORS REFER TO STORM WATER REPORT, NO. KAP4-REP-DD-123-SITE-PL-9200
 14. FOR MORE DATA CONCERNING BENCH MARKS NO=D1 REFER TO SURVEY DRAWINGS

LEGEND

EDGE OF ASPHALT	
RAISED KERB	
EXISTING BUILDING	
EXISTING FOOTPATH	
SECONDARY SIDEWALK HATCH	
FENCE LINE	
SHADE TREE	
GATE	
SPOT LEVEL	580.080
TRAVERSE POINTS	
ELECTRICAL SUBSTATION / BOX	
FIRE HYDRANT	
STREET LIGHTING POLE	
UTILITY MANHOLE	
TELECOMMUNICATION MANHOLE	
SANITARY MANHOLE	
STORM WATER MANHOLE	
WATER VALVE	

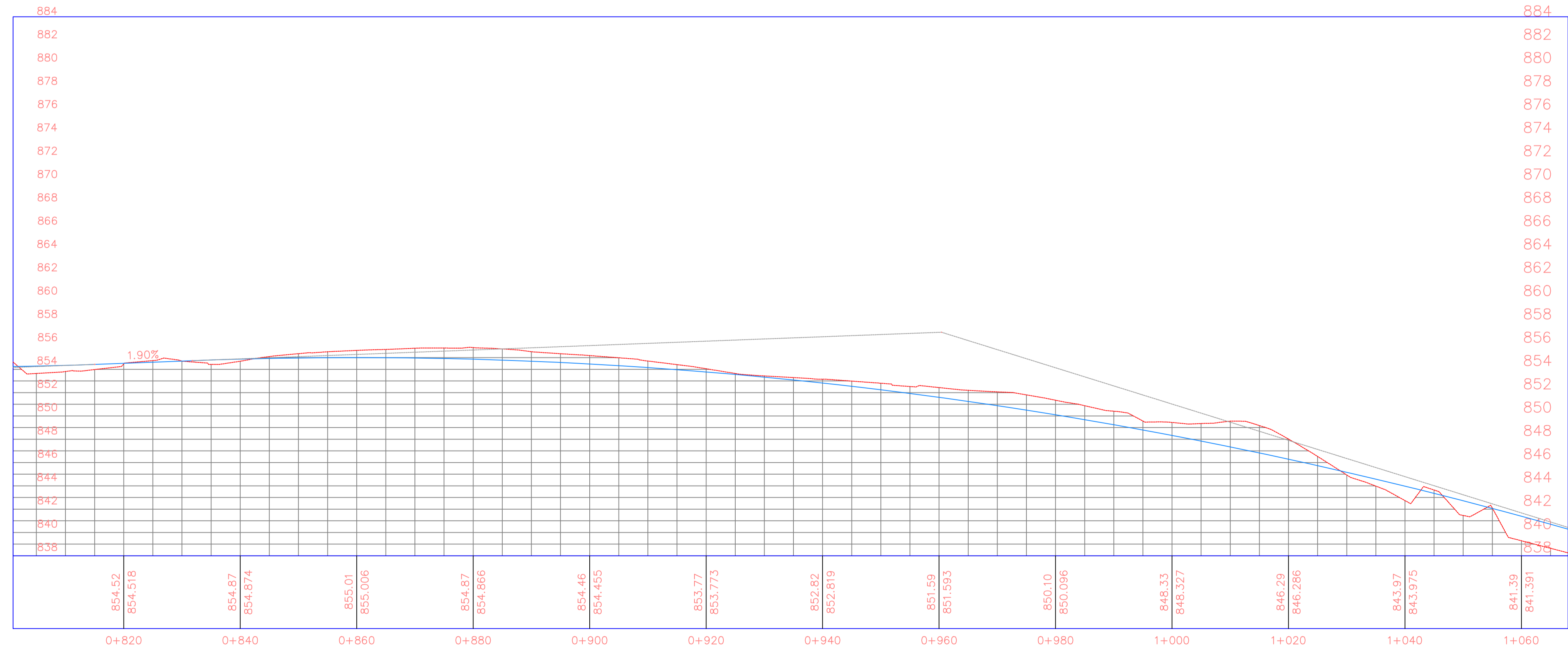

SCALE BAR

COORDINATION

CLIENT	Hgrrh,G
CLIENT CONSULTANT	Hgrrh,G
CONTRACTOR	Hgrrh,G
CONTRACTOR CONSULTANT	Hgrrh,G
PROJECT NAME	HsL nglov,U

TITLE

NO.	DATE	DESCRIPTION	BY	CHECKED BY	APPROVED BY
1		DESIGN DRAWINGS FOR APPROVAL	A-SABER	S-AMAR	S-SABER

SCALE: 1:500 PROJECT NAME: MHP-DD-RF
DATE: 2021-9-5 DWG NO.: 000000

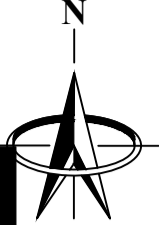
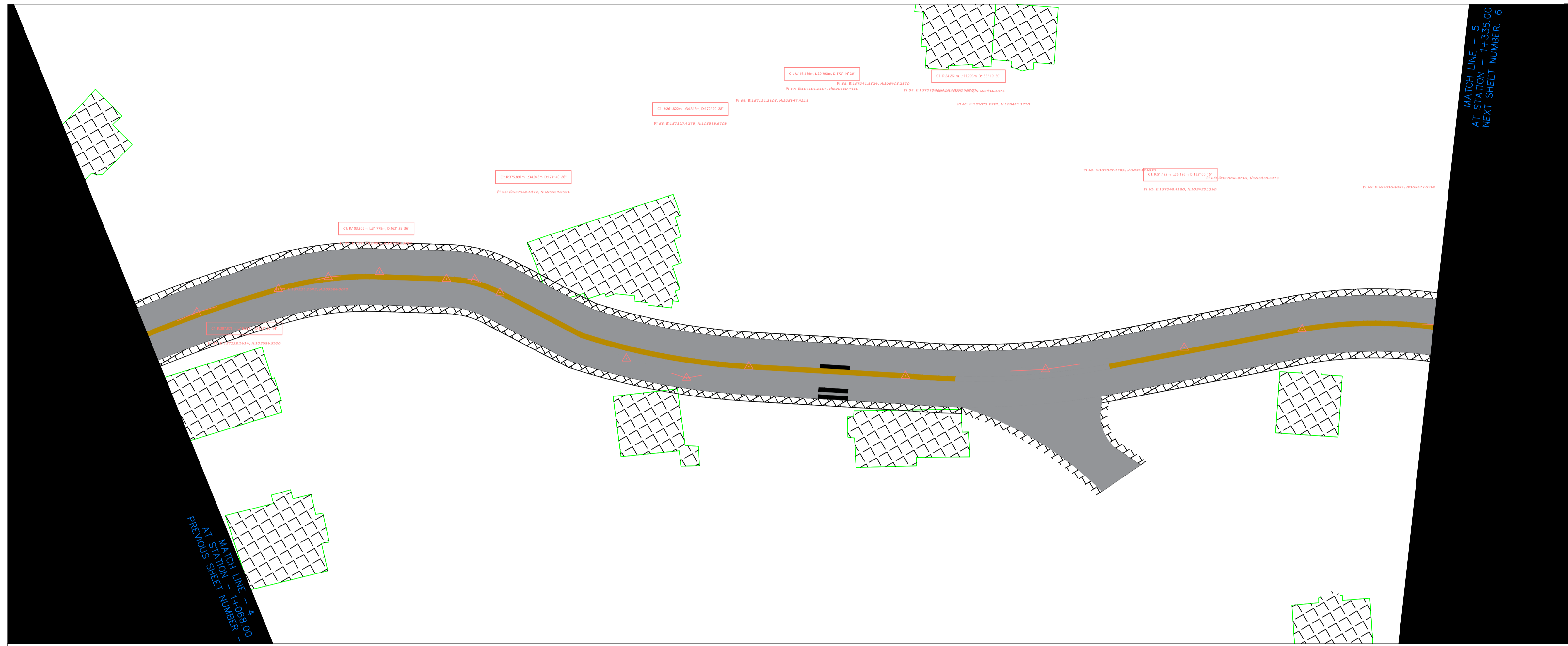

- NOTES**
1. ALL DIMENSIONS ARE IN METERS, UNLESS OTHERWISE NOTED.
 2. FOR COORDINATING SYSTEM USE (UTM) 'AIN ALABD-ZONE 38'
 3. DRAWINGS SHALL NOT BE SCALED. ONLY WRITTEN DIMENSION SHALL BE FOLLOWED.
 4. THIS DRAWING SHOULD BE READ AT SITE ATTACH WITH E/M MAP DRAWINGS.
 5. ALL CO-ORDINATES AROUND THE BUILDINGS AND ENTRANCES ONE CO-ORDINATED WITH THE APPROVED ARCHITECTURAL DWG FOR MORE INFO REFER TO ARCHITECTURAL PACKAGE FOR ALL BUILDINGS.
 6. ALL CO-ORDINATES AROUND THE BUILDINGS AND ENTRANCES ONE CO-ORDINATED WITH THE APPROVED STRUCTURAL DWG FOR MORE INFO REFER TO STRUCTURAL PACKAGE FOR ALL BUILDINGS.
 7. FOR FURTHER INFORMATION ABOUT STORM DRAINAGE CORRIDORS, PLEASE REFER TO STORM PACKAGE.
 8. REGARDING ROAD CURBS LEVELS (BOTTOM OF CURBS) AND ASPHALT LEVELS REFER TO ROAD PACKAGE FOR COORDINATION.
 9. REGARDING THE MEP DETAILS REFER TO MEP PACKAGE FOR COORDINATION.
 10. ALL PAVEMENT SIDEWALK ATTACHED OR ALIGN ROAD CURBS SHALL BE SLOPED WITH ROADS SLOPES DIRECTION.
 11. THE UNDERGROUND UTILITIES SHALL BE COORDINATED ACCORDINGLY WITH APPROVED DWG. FROM RELATED DISCIPLINES UNTIL IT WILL BE FINISHED.
 12. FENCE FROM PROTOTYPE SHALL BE OMITTED ACCORDING TO LETTER (KAP4-PRG-ACC-123-01485) FOR DESIGN APPROVAL. KAP4-RIT-123-SITE-CI-0000-1) SHALL BE FOLLOWED AS SHOWN ON DRAWINGS.
 13. FOR STORM WATER CALCULATIONS AND INFO REGARDING PROPOSED CORRIDORS REFER TO STORM WATER REPORT, NO. KAP4-REP-DD-123-SITE-PL-9200
 14. FOR MORE DATA CONCERNING BENCH MARKS NO=D1 REFER TO SURVEY DRAWINGS

LEGEND

EDGE OF ASPHALT	
RAISED KERB	
EXISTING BUILDING	
EXISTING FOOTPATH	
SECONDARY SIDEWALK HATCH	
FENCE LINE	
SHADE TREE	
GATE	
SPOT LEVEL	580.080
TRAVERSE POINTS	
ELECTRICAL SUBSTATION / BOX	
FIRE HYDRANT	
STREET LIGHTING POLE	
UTILITY MANHOLE	
TELECOMMUNICATION MANHOLE	
SANITARY MANHOLE	
STORM WATER MANHOLE	
WATER VALVE	

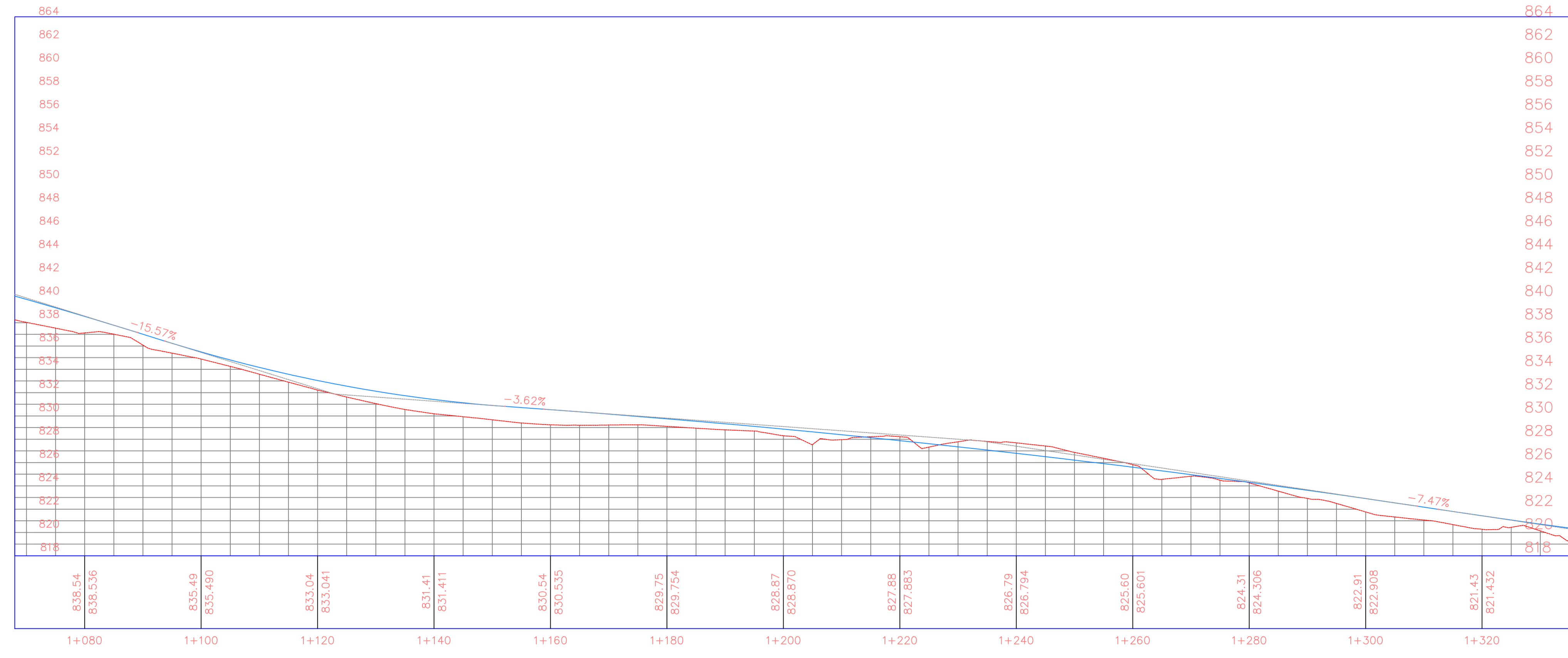

SCALE BAR

COORDINATION

CLIENT	Hg/hg
CLIENT CONSULTANT	Hg/hg
CONTRACTOR	Hg/hg
CONTRACTOR CONSULTANT	Hg/hg
PROJECT NAME	HsL nglovU

TITLE

NO.	DATE	DESCRIPTION
1	2021-09-05	DESIGN DRAWINGS FOR APPROVAL

SCALE: 1:500 PROJECT NAME: MHP-DD-RF
DATE: 2021-9-5 DWG NO.: 000000

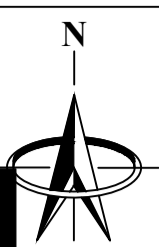
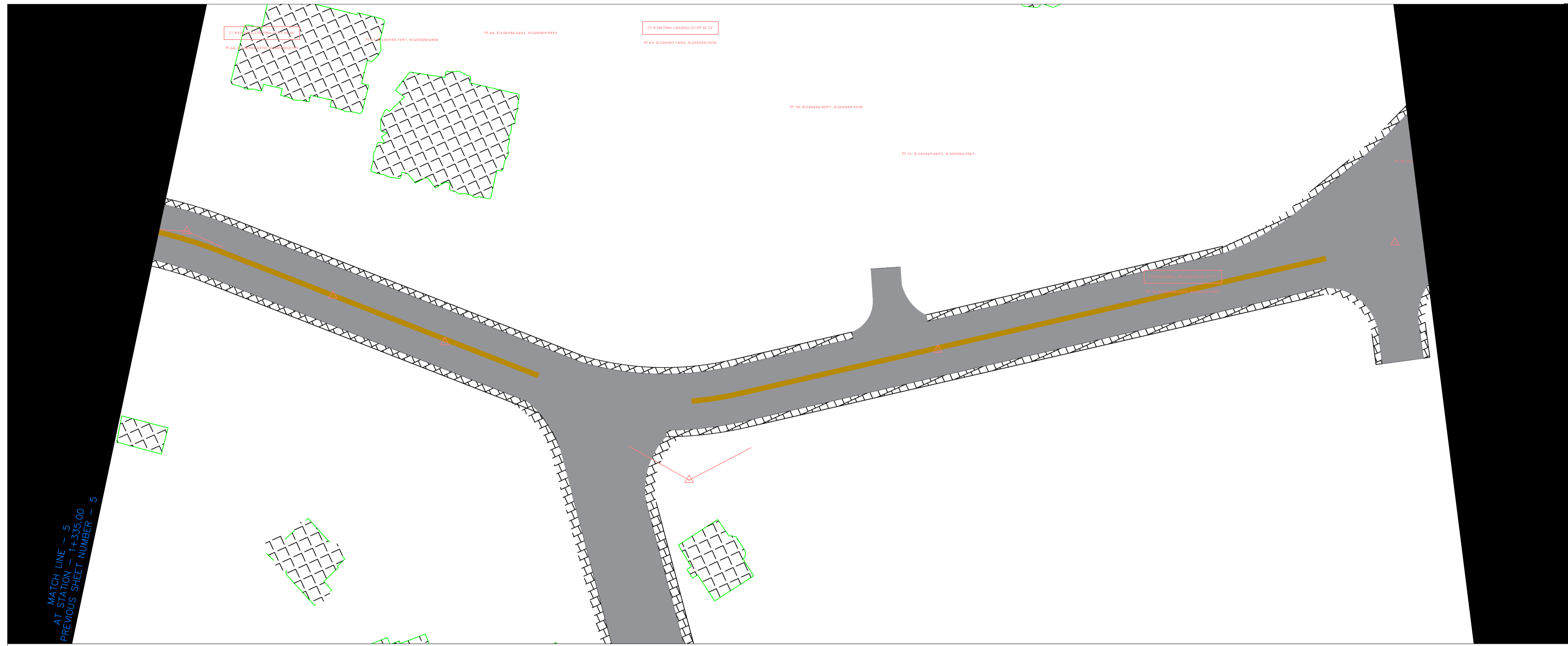

- NOTES**
1. ALL DIMENSIONS ARE IN METERS, UNLESS OTHERWISE NOTED.
 2. FOR COORDINATING SYSTEM USE (UTM) 'AIN ALABD-ZONE 38'
 3. DRAWINGS SHALL NOT BE SCALED. ONLY WRITTEN DIMENSION SHALL BE FOLLOWED.
 4. THIS DRAWING SHOULD BE READ AT SITE ATTACH WITH E/M MAP DRAWINGS.
 5. ALL CO-ORDINATES AROUND THE BUILDINGS AND ENTRANCES ONE CO-ORINATED WITH THE APPROVED ARCHITECTUAL DWG FOR MORE INFO REFER TO ARCHITECTURAL PACKAGE FOR ALL BUILDINGS
 6. ALL CO-ORDINATES AROUND THE BUILDINGS AND ENTRANCES ONE CO-ORINATED WITH THE APPROVED STRUCTURAL DWG FOR MORE INFO REFER TO STRUCTURAL PACKAGE FOR ALL BUILDINGS
 7. FOR FURTHER INFORMATION ABOUT STORM DRAINAGE CORRIDORS, PLEASE REFER TO STORM PACKAGE.
 8. REGARDING ROAD CURB LEVELS (BOTTOM OF CURBS) AND ASPHALT LEVELS REFER TO ROAD PACKAGE FOR COORDINATION.
 9. REGARDING THE MEP DETAILS REFER TO MEP PACKAGE FOR COORDINATION.
 10. ALL PAVEMENT SIDEWALK ATTACHED OR ALIGN ROAD CURBS SHALL BE SLOPED WITH ROADS SLOPES DIRECTION.
 11. THE UNDERGROUND UTILITIES SHALL BE COORDINATED ACCORDINGLY WITH APPROVED DWG. FROM RELATED DISCIPLINES UNTIL IT WILL BE FINISHED.
 12. FENCE FROM PROTOTYPE SHALL BE OMITTED ACCORDING TO LETTER (KAP4-PRG-ACC-123-01485) FOR DESIGN APPROVAL(KAP4-RIT-123-SITE-CI-0000-1) SHALL BE FOLLOWED AS SHOWN ON DRAWINGS.
 13. FOR STORM WATER CALCULATIONS AND INFO REGARDING PROPOSED CORRIDORS REFER TO STORM WATER REPORT, NO. KAP4-REP-DD-123-SITE-PL-9200
 14. FOR MORE DATA CONCERNING BENCH MARKS NO=D1 REFER TO SURVEY DRAWINGS

LEGAND

EDGE OF ASPHALT	
RAISED KERB	
EXISTING BUILDING	
EXISTING FOOTPATH	
SECONDARY SIDEWALK HATCH	
FENCE LINE	
SHADE TREE	
GATE	
SPOT LEVEL	580.080
TRAVERSE POINTS	
ELECTRICAL SUBSTATION / BOX	
FIRE HYDRANT	
STREET LIGHTING POLE	
UTILITY MANHOLE	
TELECOMMUNICATION MANHOLE	
SANITARY MANHOLE	
STORM WATER MANHOLE	
WATER VALVE	

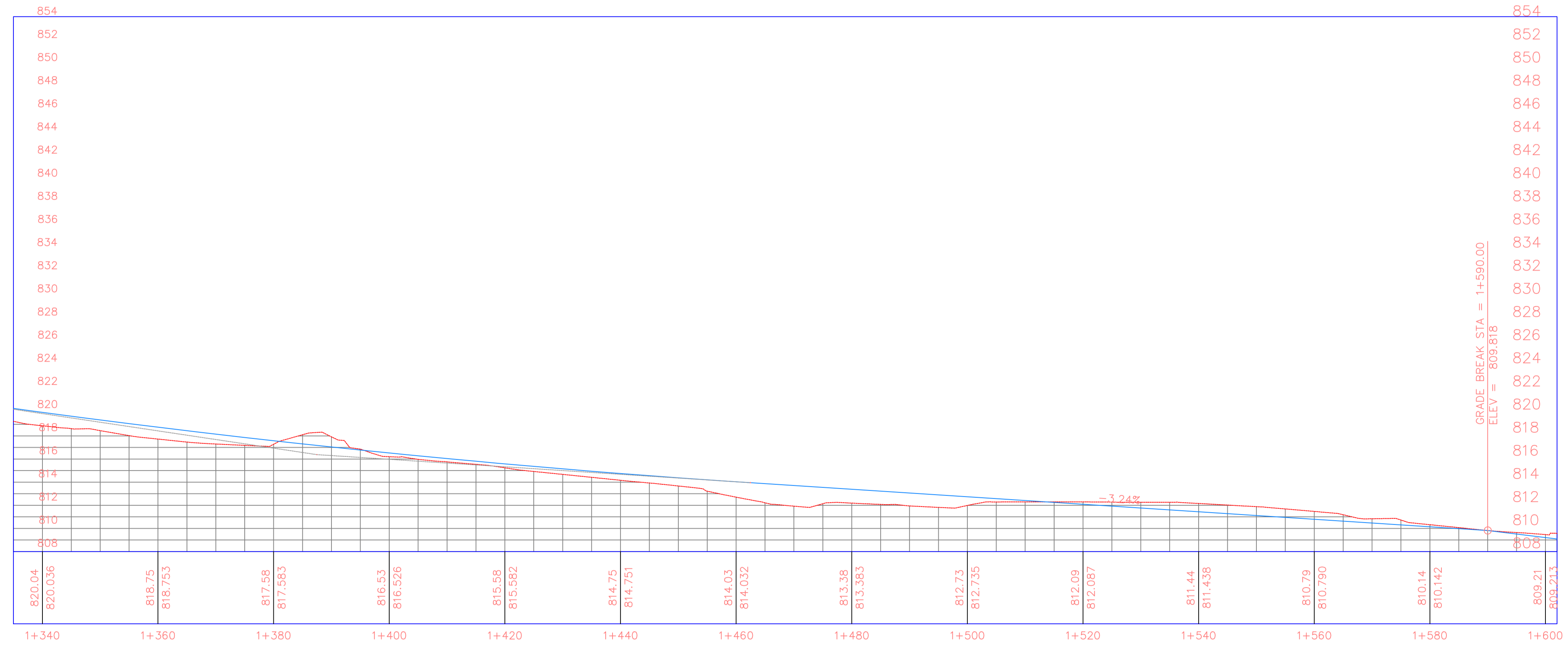

SCALE BAR

COORDINATION

CLIENT:	Hgrrh
CLIENT CONSULTANT:	Hgrrh
CONTRACTOR:	Hgrrh,G
CONTRACTOR CONSULTANT:	Hgrrh,G
PROJECT NAME:	Hsl nglov,U

TITLE

NO.	DATE	BY	CHECKED BY	APPROVED BY
1				
0				

SCALE: 1:500 PROJECT NAME: MHP-DD-RF
DATE: 2021-9-5 DWG NO.: 000000

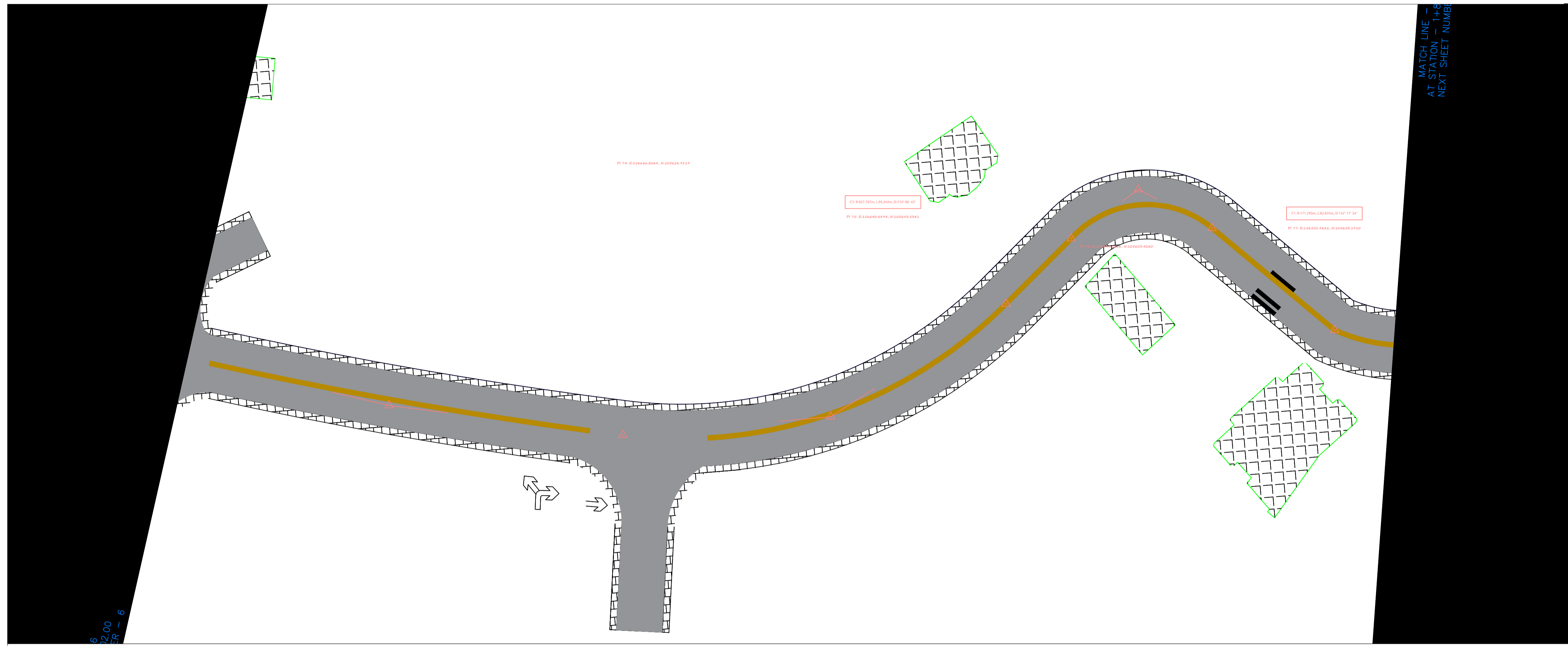

- NOTES**
1. ALL DIMENSIONS ARE IN METERS, UNLESS OTHERWISE NOTED.
 2. FOR COORDINATING SYSTEM USE (UTM) 'AIN ALABD-ZONE 38'
 3. DRAWINGS SHALL NOT BE SCALED. ONLY WRITTEN DIMENSION SHALL BE FOLLOWED.
 4. THIS DRAWING SHOULD BE READ AT SITE ATTACH WITH E/M MAP DRAWINGS.
 5. ALL CO-ORDINATES AROUND THE BUILDINGS AND ENTRANCES ONE CO-ORINATED WITH THE APPROVED ARCHITECTUAL DWG FOR MORE INFO REFER TO ARCHITECTUAL PACKAGE FOR ALL BUILDINGS
 6. ALL CO-ORDINATES AROUND THE BUILDINGS AND ENTRANCES ONE CO-ORINATED WITH THE APPROVED STRUCTURAL DWG FOR MORE INFO REFER TO STRUCTURAL PACKAGE FOR ALL BUILDINGS
 7. FOR FURTHER INFORMATION ABOUT STORM DRAINAGE CORRIDORS, PLEASE REFER TO STORM PACKAGE.
 8. REGARDING ROAD CURB LEVELS (BOTTOM OF CURBS) AND ASPHALT LEVELS REFER TO ROAD PACKAGE FOR COORDINATION.
 9. REGARDING THE MEP DETAILS REFER TO MEP PACKAGE FOR COORDINATION.
 10. ALL PAVEMENT SIDEWALK ATTACHED OR ALIGN ROAD CURBS SHALL BE SLOPED WITH ROADS SLOPES DIRECTION.
 11. THE UNDERGROUND UTILITIES SHALL BE COORDINATED ACCORDINGLY WITH APPROVED DWG. FROM RELATED DISCIPLINES UNTIL IT WILL BE FINISHED.
 12. FENCE FROM PROTOTYPE SHALL BE OMITTED ACCORDING TO LETTER (KAP4-PRG-ACC-123-01485) FOR DESIGN APPROVAL(KAP4-RIT-123-SITE-CI-0000-1) SHALL BE FOLLOWED AS SHOWN ON DRAWINGS.
 13. FOR STORM WATER CALCULATIONS AND INFO REGARDING PROPOSED CORRIDORS REFER TO STORM WATER REPORT, NO. KAP4-REP-DD-123-SITE-PL-9200
 14. FOR MORE DATA CONCERNING BENCH MARKS NO=D1 REFER TO SURVEY DRAWINGS

LEGAND

EDGE OF ASPHALT	
RAISED KERB	
EXISTING BUILDING	
EXISTING FOOTPATH	
SECONDARY SIDEWALK HATCH	
FENCE LINE	
SHADE TREE	
GATE	
SPOT LEVEL	580.080
TRAVERSE POINTS	
ELECTRICAL SUBSTATION / BOX	
FIRE HYDRANT	
STREET LIGHTING POLE	
UTILITY MANHOLE	
TELECOMMUNICATION MANHOLE	
SANITARY MANHOLE	
STORM WATER MANHOLE	
WATER VALVE	

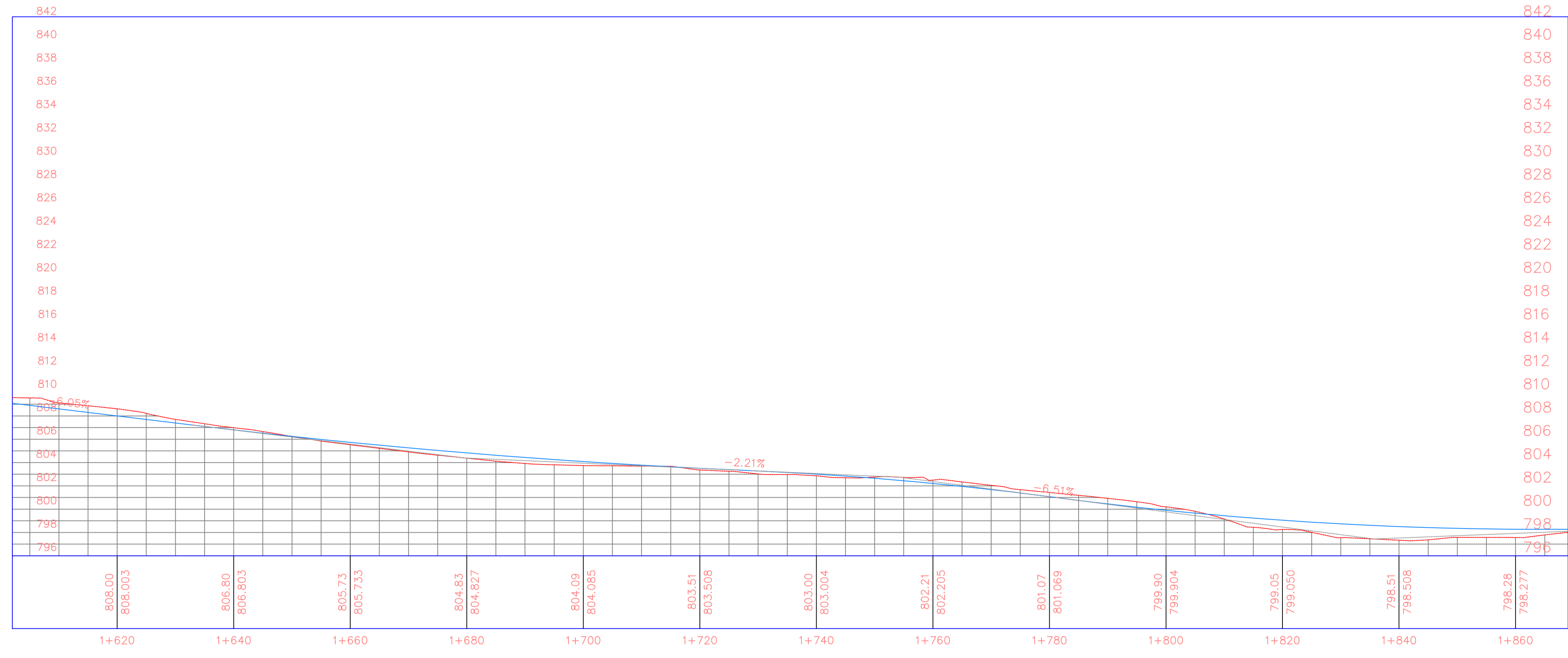

SCALE BAR

COORDINATION

CLIENT	Hg/hg
CLIENT CONSULTANT	Hg/hg
CONTRACTOR	Hg/hg
CONTRACTOR CONSULTANT	Hg/hg
PROJECT NAME	HSL nglov,U

TITLE

1	DESIGN DRAWINGS FOR APPROVAL	0000000	A-SABER	S-ARMED	S-SABER
2	DATE	2021-09-05	CHECKED BY	APPROVED BY	

SCALE: 1:500 PROJECT NAME: MHP-DD-RF

DATE: 2021-9-5 DWG NO.: 000000

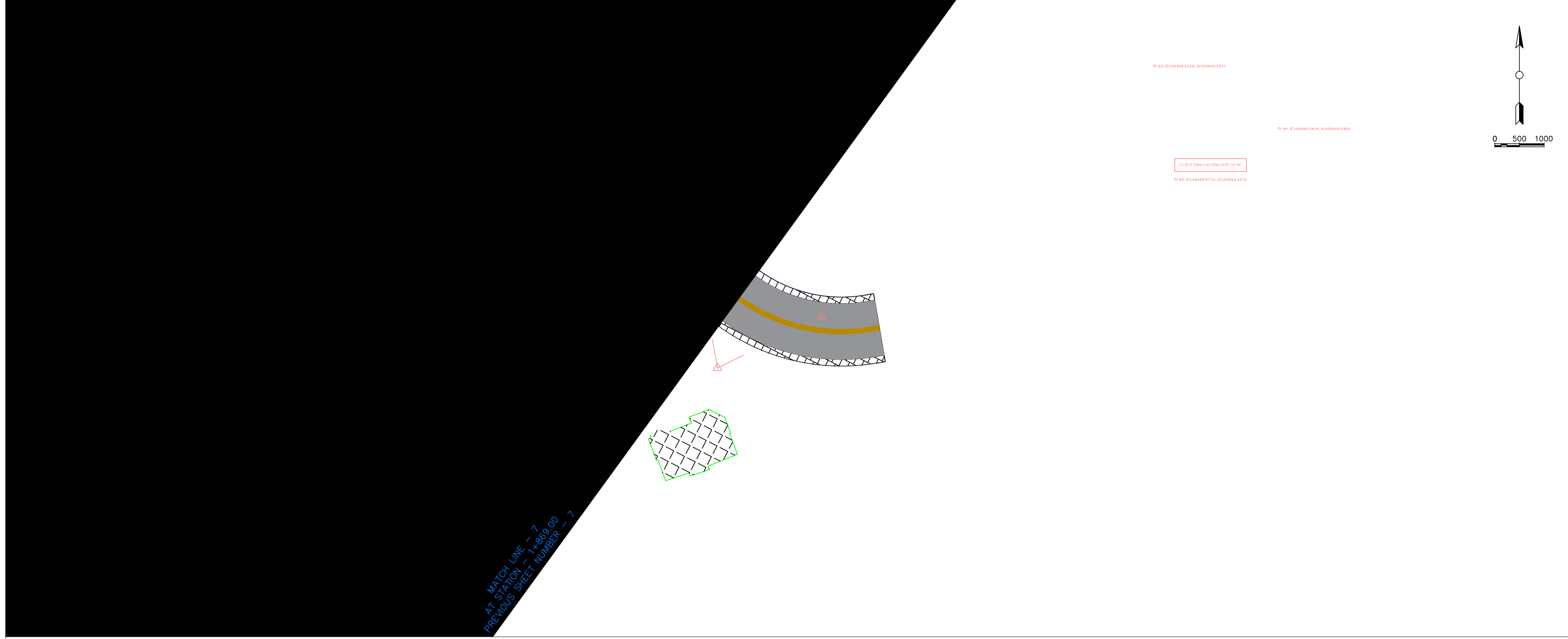

798	798.36	798.358	844	844
			842	842
			840	840
			838	838
			836	836
			834	834
			832	832
			830	830
			828	828
			826	826
			824	824
			822	822.06
			820	820.06
			818	818.06
			816	816.06
			814	814.06
			812	812.06
			810	810.06
			808	808.06
			806	806.06
			804	804.06
			802	802.06
			800	800.06
			798	798.36

1+880

GRADE BREAK STA = 1+893.06
ELEV = 798.577